

## **A730 – FLANGED CARBON STEEL BALL VALVE**

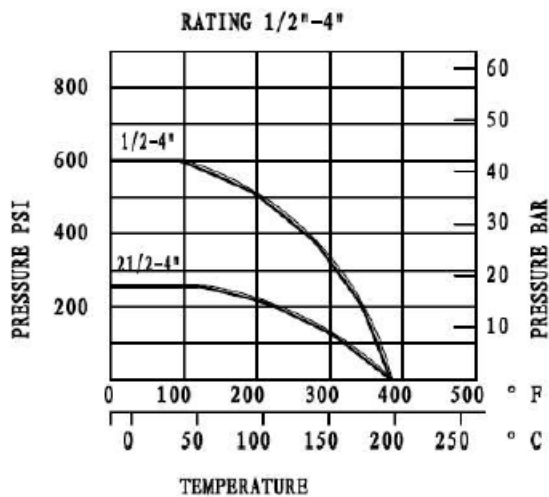

## Properties

- 3pc execution
- With hand-lever
- Blow-out proof stem
- Face-to-Face according to DIN 3202-F1
- With locking device



## Application

Chemical and pharmaceutical industries. All medium suitable to the materials of the product.

## Materials and size

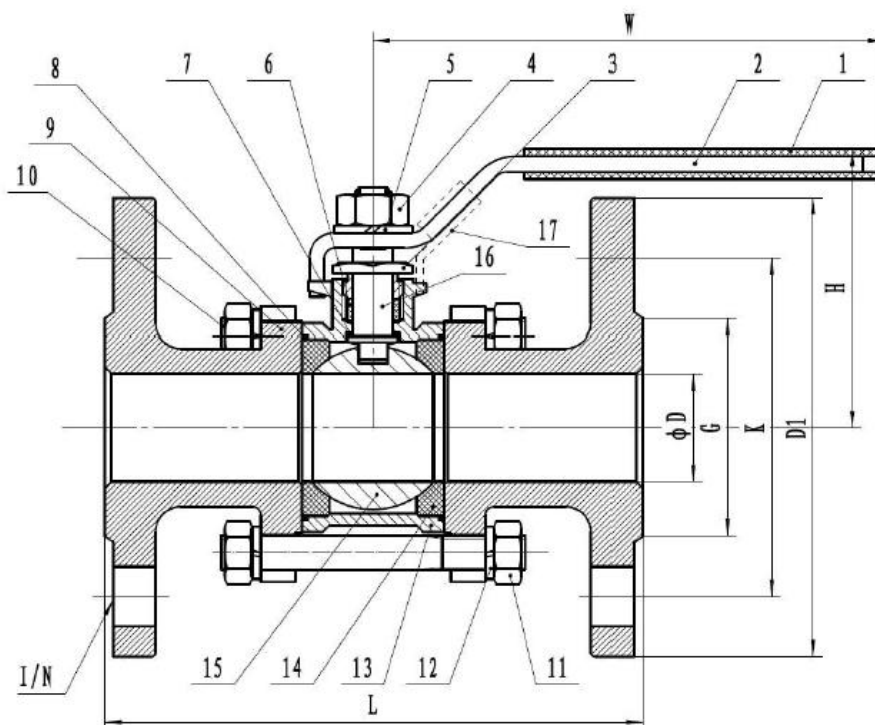

	D	L	H	W	D1	K	G	I/N
1/2"	15	130	67	103	95	65	45	14/4
3/4"	20	150	72	103	105	75	58	14/4
1"	25	160	79	135	115	85	68	14/4
1-1/4"	32	180	88	136	140	100	78	18/4
1-1/2"	38	200	102	192	150	110	88	18/4
2"	50	230	110	192	165	125	102	18/4
2-1/2"	64	290	143	311	185	145	122	18/4
								18/8
3"	76	310	152	311	200	160	138	18/8
4"	100	350	187	401	220	180	158	18/8
					235	190	162	22/8

1/2"-2"-PN40 2 1/2"-4"-PN16/PN40

17	LOCKING DEVICE	1	304
16	STEM	1	304
15	BALL	1	304
14	BALL SEAT	2	PTFE
13	BODY	1	WCB
12	SPRING WASHER	8(12)	304
11	NUT	8(12)	304
10	BOLT	4(6)	304
9	END CAP	2	WCB
8	GASKET	2	PTFE
7	THRUST WASHER	1	PTFE
6	STEM PACKING	1	PTFE
5	STEM WASHER	1	304
4	STEM NUT	1	304
3	GLAND NUT	1	304
2	HANDLE	1	304
1	PLASTIC SLEEVE	1	PLASTIC

## Installation and maintenance

### **Before installation:**

Pipe-line must be cleaned and free from any residuals of welding, shaving, and every kind of contaminations.

Pipe-line must be perfectly aligned and its support properly dimensioned, to avoid external constraint.

Please, use the right product according to the service conditions to seal the valve.

Use the right bolt tightening so the connections won't be damaged.

### **Cleaning and tests:**

Keep the valves open during the cleaning process, to ensure there are no impurities between the ball and the body.

Pressure tests must be done with a cleaned pipe-line.

Open the valves partially for the tests. Pressure test must not exceed the valve specifications according to EN 12266-1.

### **Maintenance:**

It's recommended to operate the valve twice (open and close) 1 or 2 times a year.

When you need to perform any intervention on the valve, make sure the pipe-line is not under pressure, there is no fluid in it and it's isolated.

The temperature must be low enough to operate without risks.

If there is a corrosive fluid, inert installation before intervention.

When the valve is under pressure and there's a leakage at the packing, tighten it slightly so that the leakage disappears.