

A797 – BUTT WELDED CARBON STEEL BALL VALVE



Properties

- 3pc execution
- With hand-lever
- Blow-out proof stem
- Face-to-Face S13
- With locking device
- Full bore
- 1000WOG (PS: 63 bar)

Application

Chemical and pharmaceutical industries.
All medium suitable to the materials of the product.



Materials and size

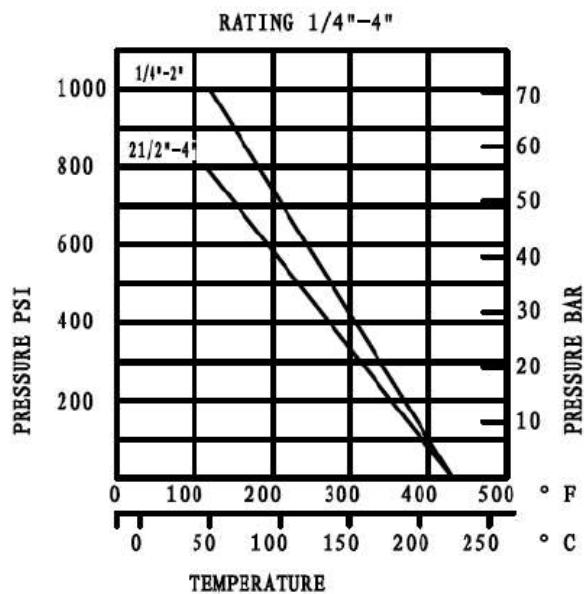

17	LOCKING DEVICE	1	304
16	STEM	1	304
15	BALL	1	304
14	BALL SEAT	2	PTFE
13	BODY	1	WCB
12	SPRING WASHER	4-6	304
11	NUT	4-6	304
10	BOLT	4-6	304
9	END CAP	1	WCB
8	GASKET	2	PTFE
7	THRUST WASHER	1	PTFE
6	STEM PACKING	1	PTFE
5	STEM WASHER	1	304
4	STEM NUT	1	304
3	GLAND NUT	1	304
2	HANDLE	1	304
1	PLASTIC SLEEVE	1	PLASTIC

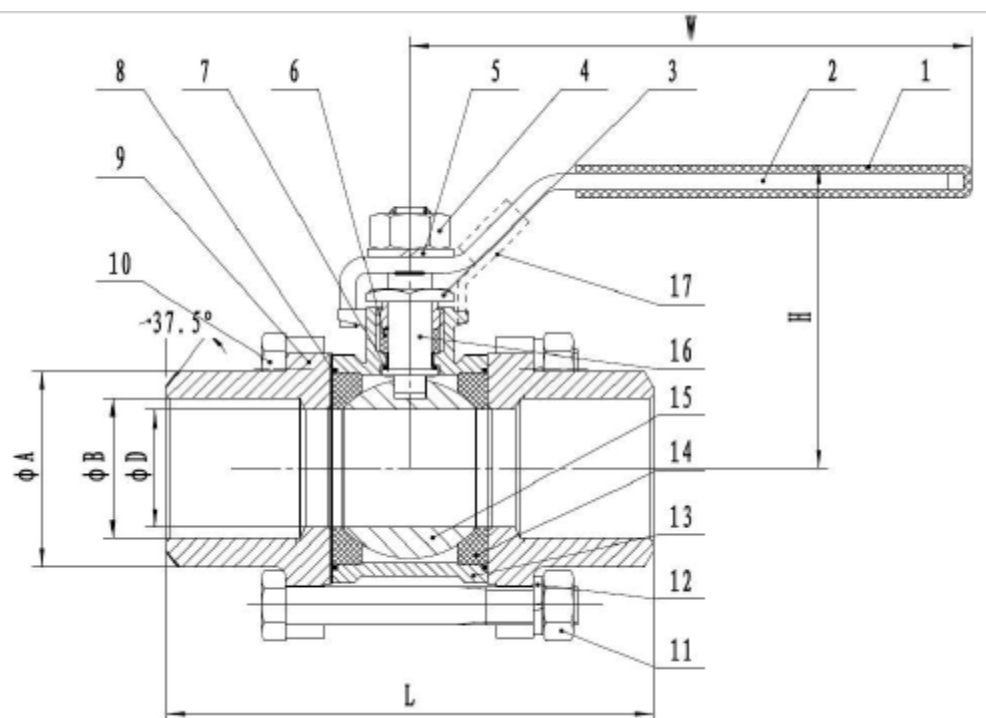

	D	L	H	W	A	B
1/4"	10.8	70	52	105	18	10.8
3/8"	12.5	70	52	105	18	13
1/2"	15	75	55	105	23	16
3/4"	20	90	63	105	28	21
1"	25	100	70	137	35	26.6
1-1/4"	32	110	76	137	43	35
1-1/2"	38	125	89	182	50	40.5
2"	50	150	97	182	61	52.5
2-1/2"	64	190	143	260	75	65
3"	76	220	152	260	91	78
4"	94	270	187	403	115	100

Installation and maintenance

Before installation:

Pipe-line must be cleaned and free from any residuals of welding, shaving, and every kind of contaminations.

Pipe-line must be perfectly aligned and its support properly dimensioned, to avoid external constraint.

Please, use the right product according to the service conditions to seal the valve.

Use the right bolt tightening so the connections won't be damaged.

Cleaning and tests:

Keep the valves open during the cleaning process, to ensure there are no impurities between the ball and the body.

Pressure tests must be done with a cleaned pipe-line.

Open the valves partially for the tests. Pressure test must not exceed the valve specifications according to EN 12266-1.

Maintenance:

It's recommended to operate the valve twice (open and close) 1 or 2 times a year.

When you need to perform any intervention on the valve, make sure the pipe-line is not under pressure, there is no fluid in it and it's isolated.

The temperature must be low enough to operate without risks.

If there is a corrosive fluid, inert installation before intervention.

When the valve is under pressure and there's a leakage at the packing, tighten it slightly so that the leakage disappears.