

TECHNICAL CATALOGUE

BALL VALVES



> THE COMPANY

ITAP SpA, founded in Lumezzane (Brescia) in 1972, is currently one of the leading production companies in Italy of **valves, fittings and distribution manifolds** for plumbing and heating systems.

Thanks to a fully automated production process, with 85 transfer machines and 55 assembly lines, it is capable of producing 400,000 pieces per day.

Our innate pursuit for innovation and observance of technical regulations is supported by the company certification ISO 9001. The company has always considered its focus on quality as the main tool to obtain significant business results: today ITAP SpA is proud to offer products bearing the approval of numerous international certifying bodies.



> ITAP products have obtained approvals by more than 30 certification bodies from all over the world.





BALL VALVES

128 3-way ball valve

Suitable for domestic water services, heating, air-conditioning plants and compressed air systems.

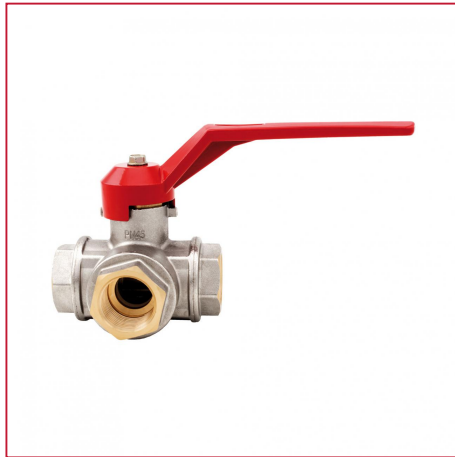

128L

With L ball.

MEASURE	PRESSURE	CODE	PACKING
1/4" (DN 8)	55bar/797.5psi	1280014L	4/24
3/8" (DN 10)	55bar/797.5psi	1280038L	4/24
1/2" (DN 15)	50bar/725psi	1280012L	4/24
3/4" (DN 20)	50bar/725psi	1280034L	2/12
1" (DN 25)	45bar/652.5psi	1280100L	2/12
1"1/4 (DN 32)	35bar/507.5psi	1280114L	2/12
1"1/2 (DN 40)	35bar/507.5psi	1280112L	2/4
2" (DN 50)	35bar/507.5psi	1280200L	2/2

128T

With T ball.

MEASURE	PRESSURE	CODE	PACKING
1/4" (DN 8)	55bar/797.5psi	1280014T	4/24
3/8" (DN 10)	55bar/797.5psi	1280038T	4/24
1/2" (DN 15)	50bar/725psi	1280012T	4/24
3/4" (DN 20)	50bar/725psi	1280034T	2/12
1" (DN 25)	45bar/652.5psi	1280100T	2/12
1"1/4 (DN 32)	35bar/507.5psi	1280114T	2/12
1"1/2 (DN 40)	35bar/507.5psi	1280112T	2/4
2" (DN 50)	35bar/507.5psi	1280200T	2/2

CERTIFICATIONS



TECHNICAL SPECIFICATIONS

Female/female/female threads.

Lever handle in aluminium.

Body in nickel-plated brass.

Minimum and maximum working temperatures: -10°C, 120°C in absence of steam.

Threads: ISO 228 (equivalent to DIN EN ISO 228 and BS EN ISO 228).



BALL VALVES

OVERALL DIMENSIONS

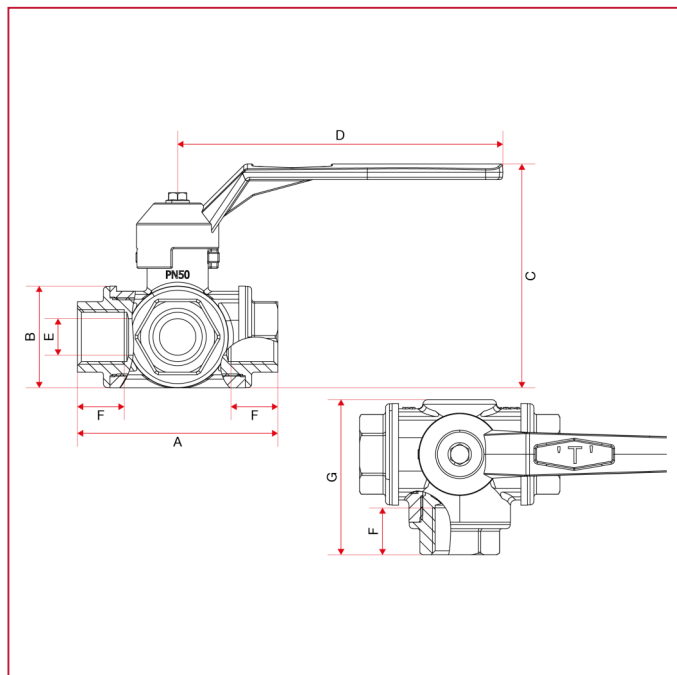

128L

	1/4"	3/8"	1/2"	3/4"	1"	1"1/4	1"1/2	2"
DN	8	10	15	20	25	32	40	50
A	77	77	77	92	104	118,5	138	162
B	39	39	39	47	54,5	64,5	79	93,5
C	86	86	86	107	122,5	132	145,5	186
D	125	125	125	145	170	170	170	260
E	10	12	14	18	23	29	36	45
F	18	18	18	22	23	26	30	35
G	59,5	59,5	59,5	70	81	93	107,5	128
Kg/cm2 bar	55	55	50	50	45	35	35	35
LBS - psi	797,5	797,5	725	725	652,5	507,5	507,5	507,5

128T

	1/4"	3/8"	1/2"	3/4"	1"	1"1/4	1"1/2	2"
DN	8	10	15	20	25	32	40	50
A	77	77	77	92	104	118,5	138	162
B	39	39	39	47	54,5	64,5	79	93,5
C	86	86	86	107	122,5	132	145,5	186
D	125	125	125	145	170	170	170	260
E	10	12	14	18	23	29	36	45
F	18	18	18	22	23	26	30	35
G	59,5	59,5	59,5	70	81	93	107,5	128
Kg/cm2 bar	55	55	50	50	45	35	35	35
LBS - psi	797,5	797,5	725	725	652,5	507,5	507,5	507,5



BALL VALVES

MATERIALS

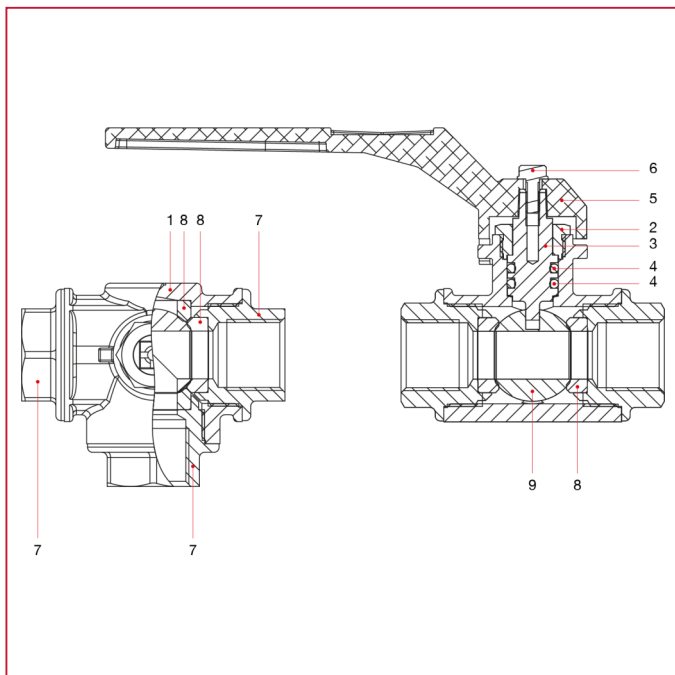

POS.	DESCRIPTION	N.	MATERIAL
1	Body	1	Nickel-plated brass CW617N
2	Packing gland	1	Brass CW614N
3	Stem	1	Brass CW614N
4	O-ring	2	Viton®
5	Lever handel	1	Varnished aluminium
6	Screw	1	Zinc-plated steel
7	Female end adapter	3	Nickel-plated brass CW617N
8	Seat	4	P.T.F.E.
9	Ball	1	Chrome-plated brass CW617N



BALL VALVES

INSTALLATION

T valve operation: with the handle disassembled is visible, on the stem, a T mark, which indicates the running direction of the ball's holes, allowing the following combinations:

Fig. A

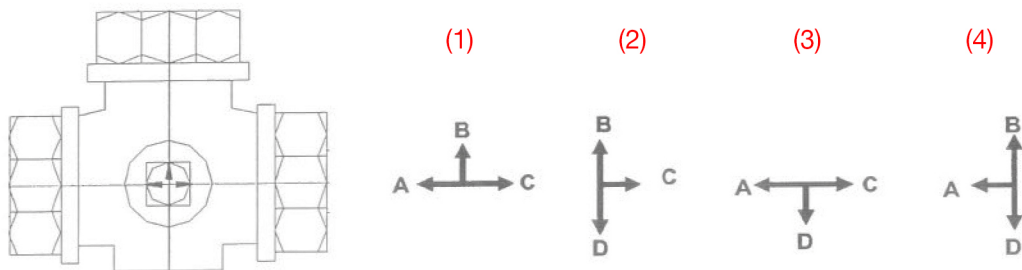

- 1 - The flow go in all directions (A-B-C)
- 2 - The flow go only from B to C (or vice versa)
- 3 - The flow go only from A to C (or vice versa)
- 4 - The flow go only from A to B (or vice versa)

L valve operation: with the handle disassembled is visible, on the stem, a L mark, which indicates the running direction of the ball's holes, allowing the following combinations:

Fig. B

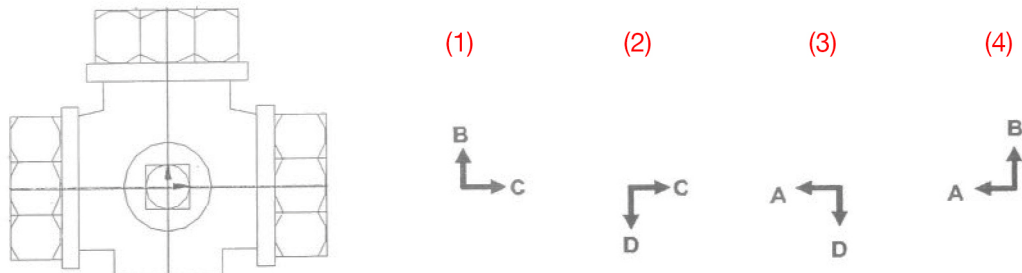

- 1 - The flow go from B to C (or vice versa)
- 2 - The flow is stopped
- 3 - The flow is stopped
- 4 - The flow go from A to B (or vice versa)



BALL VALVES

LOSS DIAGRAM (With water)

128L

	1/4"	3/8"	1/2"	3/4"	1"	1 1/4"	1 1/2"	2"
KV	1,5	2,5	3,5	7	12	19,5	37	52

128T

	1/4"	3/8"	1/2"	3/4"	1"	1 1/4"	1 1/2"	2"
KV	1,5	2,5	3,5	7	12	19,5	37	52

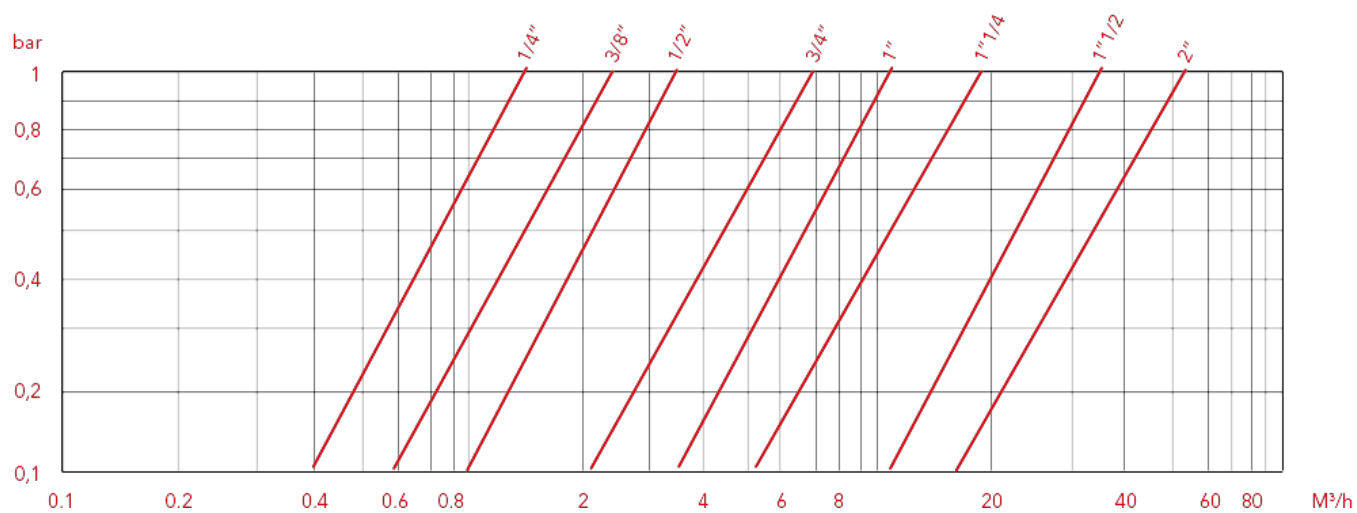



BALL VALVES

PRESSURE-TEMPERATURE DIAGRAM

The values shown by the dropping lines state the maximum limit of employment of the valves.
The shown values are approximate.

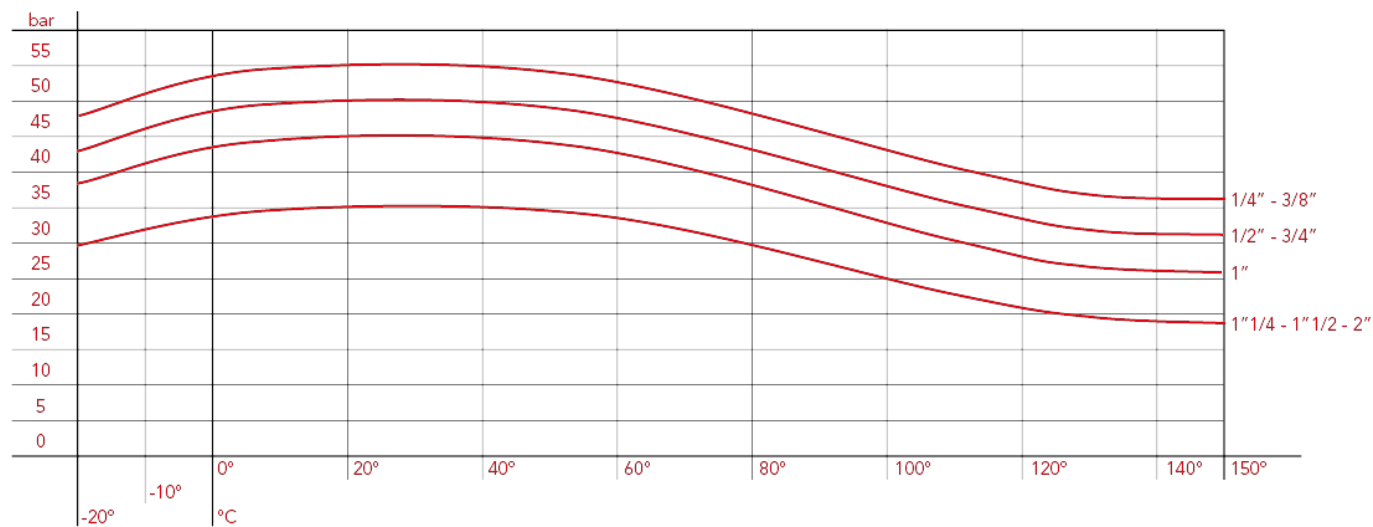



ITAP S.p.A.
Via Ruca 19
25065 Lumezzane
Brescia (ITALY)
Tel 030 8927011
Fax 030 8921990
www.itap.it - info@itap.it

We reserve the right to make improvements and changes to the products described herein and to the relative technical data, at any time and without forewarning.

rev. 20250402