



TECHNICAL CATALOGUE

CONVERTIBLE VALVES AND LOCKSHIELDS



> THE COMPANY

ITAP SpA, founded in Lumezzane (Brescia) in 1972, is currently one of the leading production companies in Italy of **valves, fittings and distribution manifolds** for plumbing and heating systems.

Thanks to a fully automated production process, with 85 transfer machines and 55 assembly lines, it is capable of producing 400,000 pieces per day.

Our innate pursuit for innovation and observance of technical regulations is supported by the company certification ISO 9001. The company has always considered its focus on quality as the main tool to obtain significant business results: today ITAP SpA is proud to offer products bearing the approval of numerous international certifying bodies.

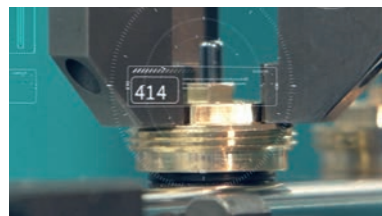

> ITAP products have obtained approvals by more than 30 certification bodies from all over the world.





CONVERTIBLE VALVES AND LOCKSHIELDS

894V Straight convertible valve with handle, female thread

To be used with iron piping or, together with an Itap-Fit® connector (art. 618), with copper, crosslinked polyethylene (PEX) or polybutylene.

In the case of use with PEX or polybutylene it is also requested the use of the liner art. 655.



MEASURE	PRESSURE	CODE	PACKING
3/8" (DN 10)	10bar/145psi	8940038V	4/56
1/2" (DN 15)	10bar/145psi	8940012V	4/56

CERTIFICATIONS



TECHNICAL SPECIFICATIONS

Body in nickel-plated brass.

Maximum working temperature: 110°C.

Threads: ISO 228 (equivalent to DIN EN ISO 228 and BS EN ISO 228).

Suitable for thermostatic control heads art. 891, art. 891R, art. 891SD.

OVERALL DIMENSIONS

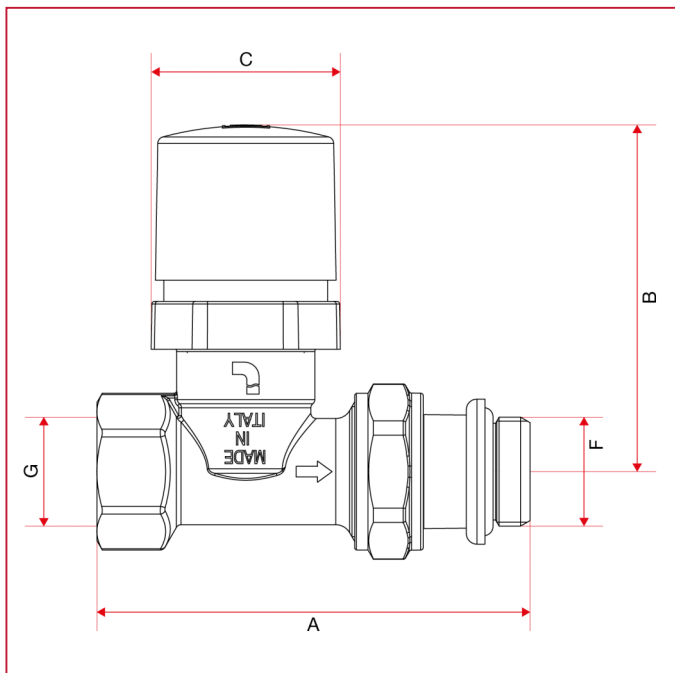



CONVERTIBLE VALVES AND LOCKSHIELDS

	3/8"	1/2"
DN	10	15
A	75,5	81,5
B	65,3	65,3
C	35,6	35,6
F	3/8"	1/2"
G	3/8"	1/2"
Kg/cm ² bar	10	10
LBS - psi	145	145



CONVERTIBLE VALVES AND LOCKSHIELDS

MATERIALS

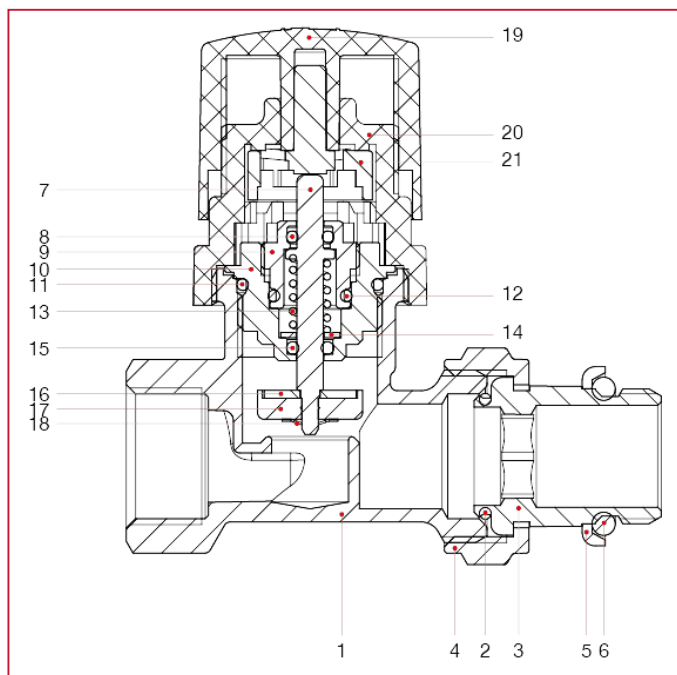

POS.	DESCRIPTION	N.	MATERIAL
1	Body	1	Nickel-plated brass CW617N
2	Washer	1	NBR
3	Union	1	Nickel-plated brass CW617N
4	Nut	1	Nickel-plated brass CW617N
5	Ring	1	Zinc-plated steel Fe
6	Washer	1	NBR
7	Stem	1	Brass CW614N
8	Washer	1	EPDM
9	Ring nut	1	Brass CW614N
10	Body	1	Brass CW614N
11	O-ring	1	EPDM
12	O-ring	1	EPDM
13	Spring	1	Stainless steel AISI 302
14	Washer	1	Stainless steel AISI 304
15	O-ring	1	EPDM
16	Washer	1	Stainless steel AISI 304
17	Washer	1	EPDM
18	Seeger	1	Stainless steel AISI 304
19	Cap	1	ABS
20	Body	1	ABS
21	Hook	1	Polycarbonate



CONVERTIBLE VALVES AND LOCKSHIELDS

INSTRUCTIONS

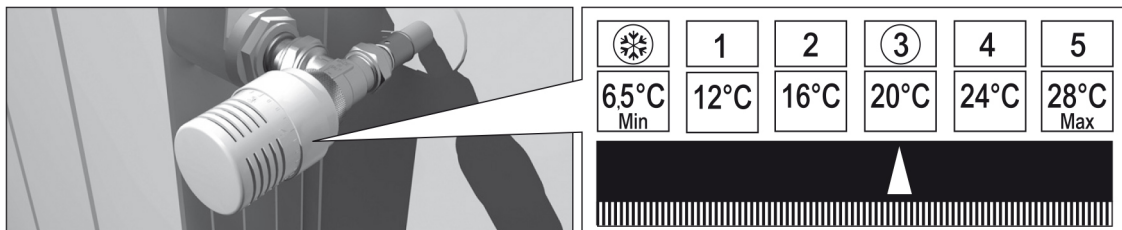

Set the head in the required position:

Use a screwdriver to disassemble the cover (b), the locking cap (c) and the first of the toothed washer (d) FIG. II.

Reassemble the washer (d) as in FIG. III if you want to limit the setting from * to 3.

Reassemble the washer (d) as in FIG IV if you want to block the setting at the value of 3.

Then reassemble the locking cap (c) and the cover (b).

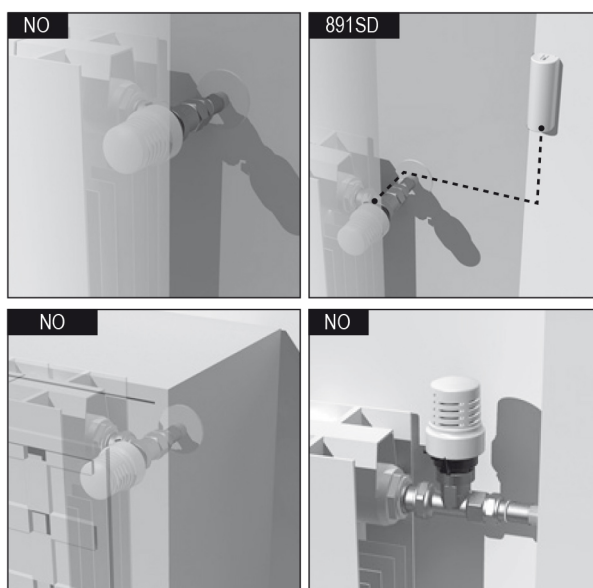
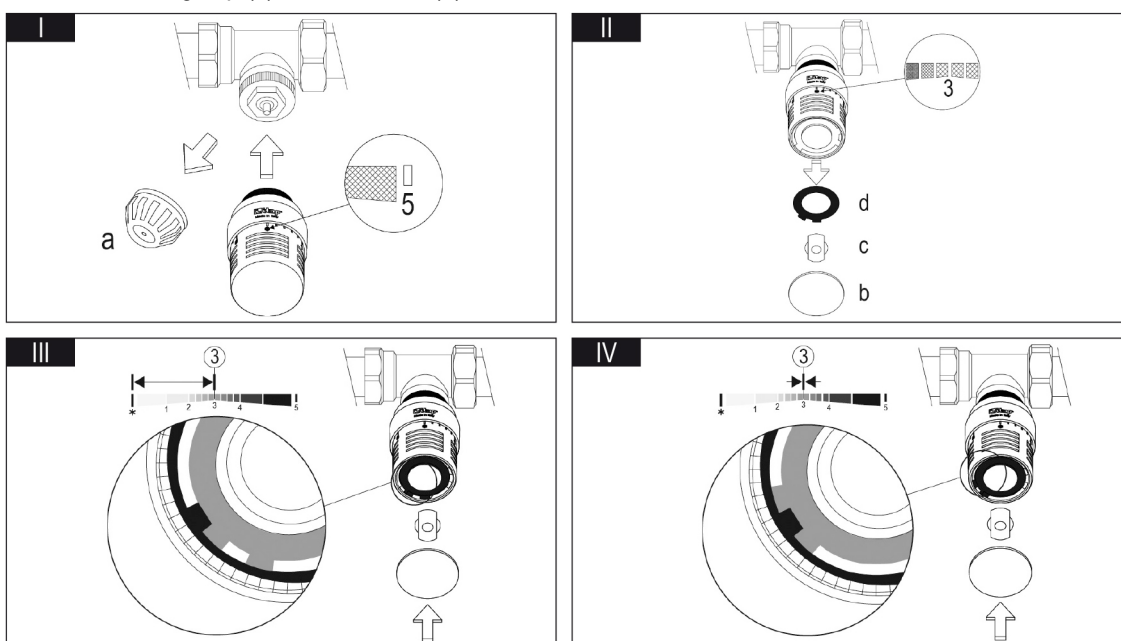



CONVERTIBLE VALVES AND LOCKSHIELDS

994C - 995C - 994V - 995V IN COMBINATION WITH 891 SERIES ACTUATOR:

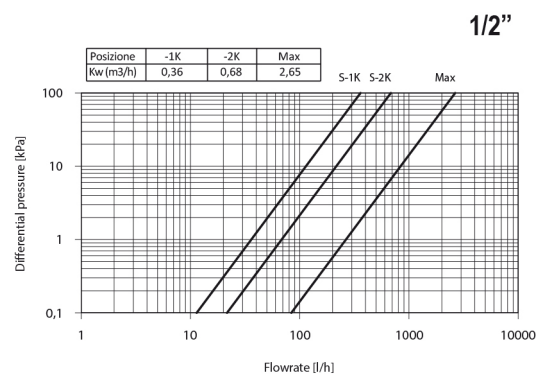
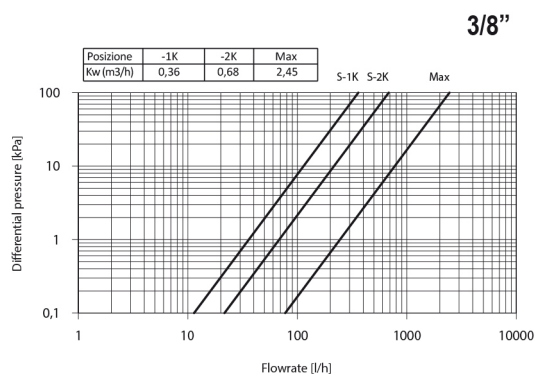

894C - 895C - 894V - 895V IN COMBINATION WITH 891 SERIES ACTUATOR:

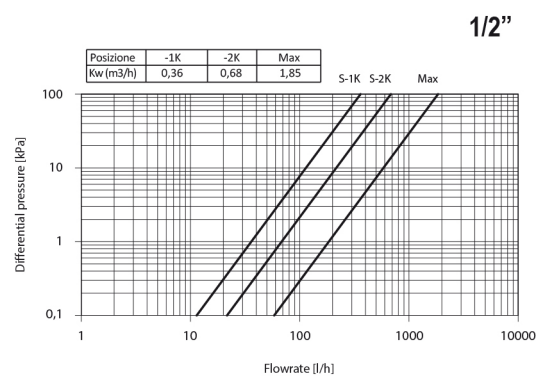
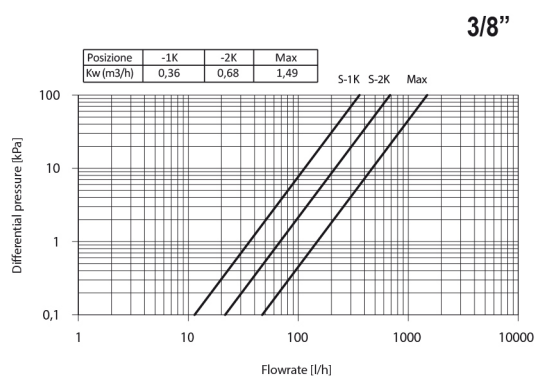

P max. 10 bar	ΔP max. 1,5 bar	T max. 110°C	Isteresi / Hysteresis C: 0,5 K	Tempo di risposta / Response time Z: 30 min.
Portata nominale / Nominal Flowrate qmN: 210 l/h				
Influenza pressione differenziale / Differential pressure influence D: 0,75 K				



CONVERTIBLE VALVES AND LOCKSHIELDS

LOSS DIAGRAM (With water) size 3/8"

KV	3/8"	1/2"
	1K:0,34;2K:0,63;MAX:1,12	1K:0,34;2K:0,63;MAX:1,32

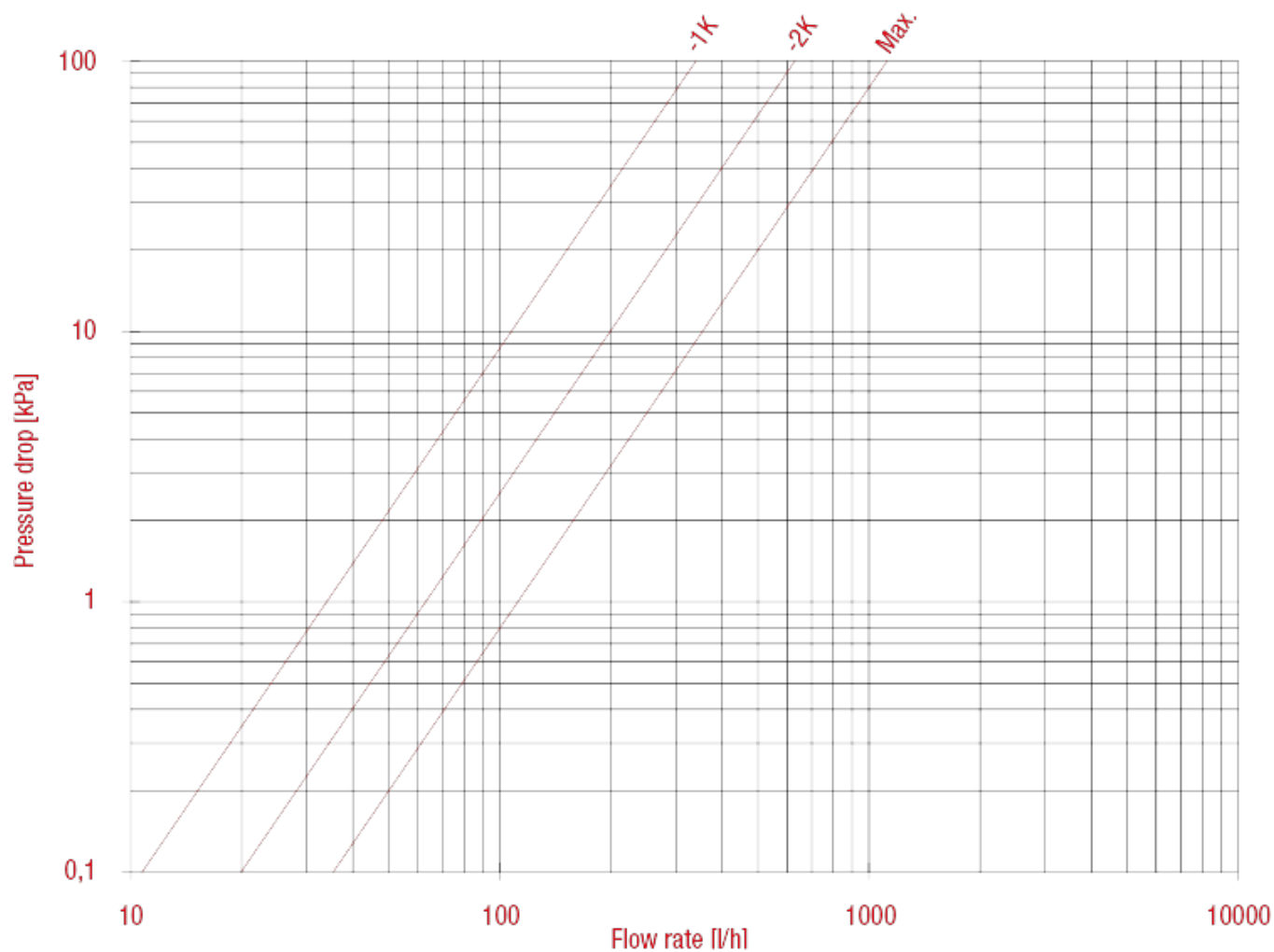



CONVERTIBLE VALVES AND LOCKSHIELDS

LOSS DIAGRAM (With water) size 1/2"

KV	3/8"	1/2"
	1K:0,34;2K:0,63;MAX:1,12	1K:0,34;2K:0,63;MAX:1,32

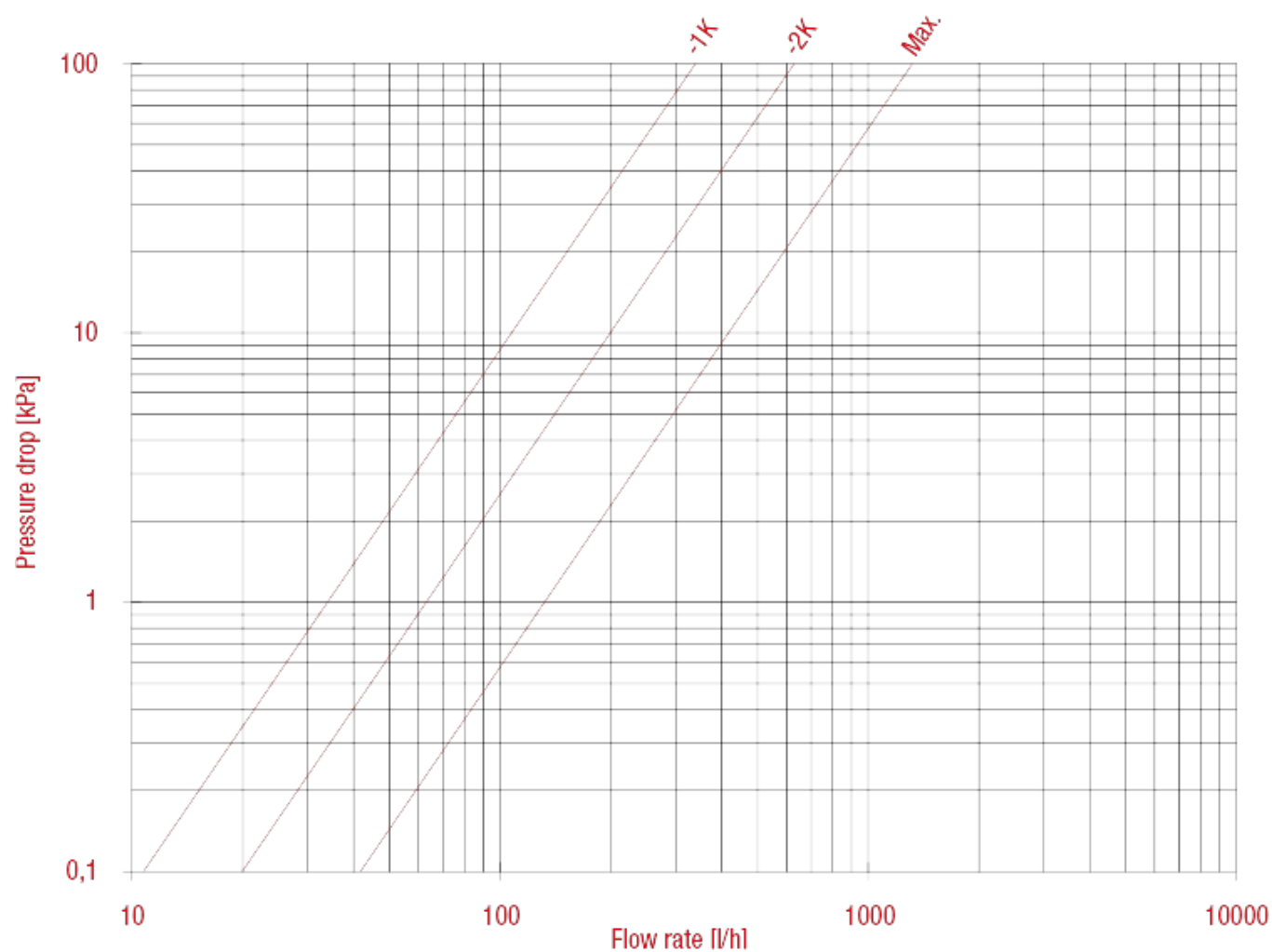



CONVERTIBLE VALVES AND LOCKSHIELDS

894C Straight convertible valve with cap, female thread

To be used with iron piping or, together with an Itap-Fit® connector (art. 618), with copper, crosslinked polyethylene (PEX) or polybutylene.

In the case of use with PEX or polybutylene it is also requested the use of the liner art. 655.



MEASURE	PRESSURE	CODE	PACKING
3/8" (DN 10)	10bar/145psi	8940038C	4/88
1/2" (DN 15)	10bar/145psi	8940012C	4/88

CERTIFICATIONS



TECHNICAL SPECIFICATIONS

Body in nickel-plated brass.

Maximum working temperature: 110°C.

Threads: ISO 228 (equivalent to DIN EN ISO 228 and BS EN ISO 228).

Suitable for thermostatic control heads art. 891, art. 891R, art. 891SD.

OVERALL DIMENSIONS

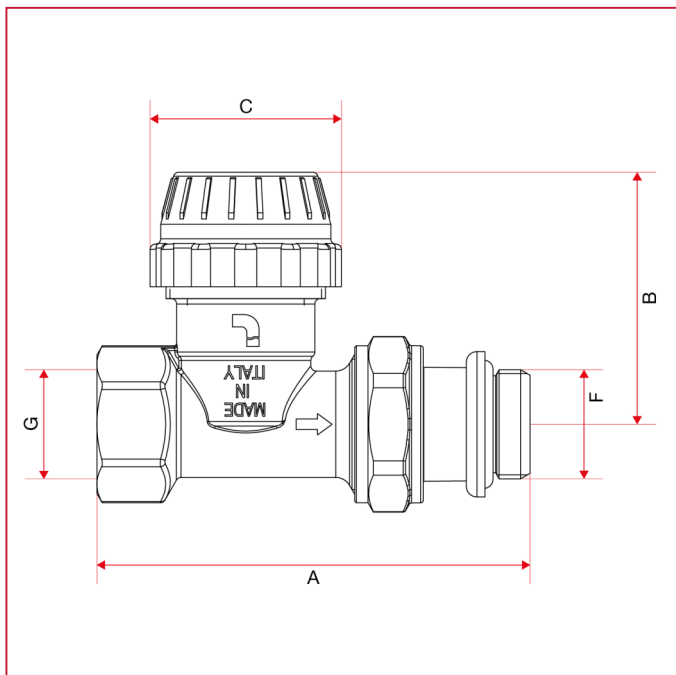



CONVERTIBLE VALVES AND LOCKSHIELDS

	3/8"	1/2"
DN	10	15
A	75,5	81,5
B	47,3	47,3
C	36	36
F	3/8"	1/2"
G	3/8"	1/2"
Kg/cm2 bar	10	10
LBS - psi	145	145

MATERIALS

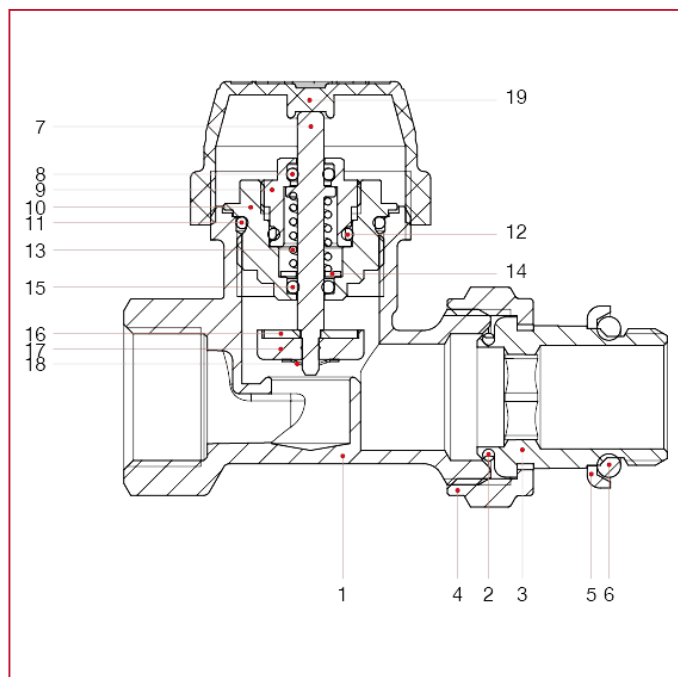

POS.	DESCRIPTION	N.	MATERIAL
1	Body	1	Nickel-plated brass CW617N
2	Washer	1	NBR
3	Union	1	Nickel-plated brass CW617N
4	Nut	1	Nickel-plated brass CW617N
5	Ring	1	Zinc-plated steel Fe
6	Washer	1	NBR
7	Stem	1	Brass CW614N
8	Washer	1	EPDM
9	Ring nut	1	Brass CW614N
10	Body	1	Brass CW614N
11	O-ring	1	EPDM
12	O-ring	1	EPDM
13	Spring	1	Stainless steel AISI 302
14	Washer	1	Stainless steel AISI 304
15	O-ring	1	EPDM
16	Washer	1	Stainless steel AISI 304
17	Washer	1	EPDM
18	Seeger	1	Stainless steel AISI 304
19	Cap	1	ABS



CONVERTIBLE VALVES AND LOCKSHIELDS

INSTRUCTIONS

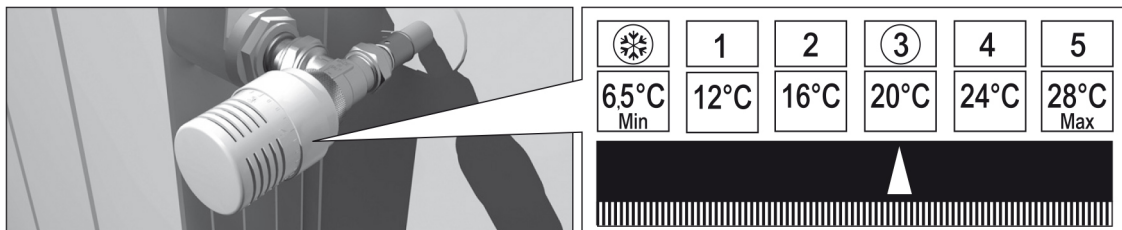

Set the head in the required position:

Use a screwdriver to disassemble the cover (b), the locking cap (c) and the first of the toothed washer (d) FIG. II.

Reassemble the washer (d) as in FIG. III if you want to limit the setting from * to 3.

Reassemble the washer (d) as in FIG IV if you want to block the setting at the value of 3.

Then reassemble the locking cap (c) and the cover (b).

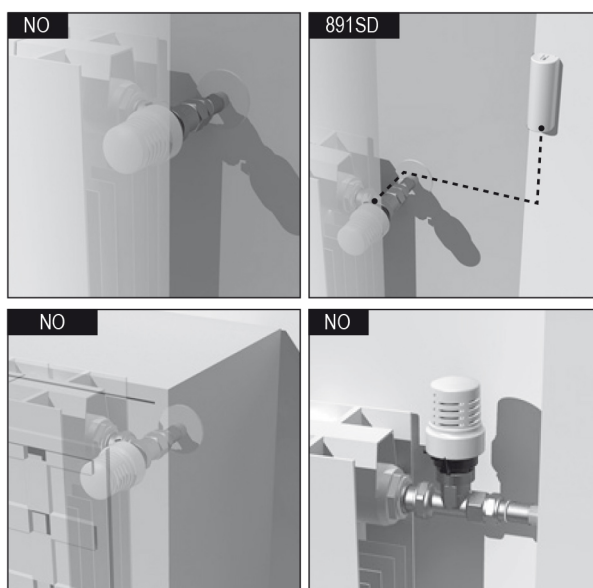
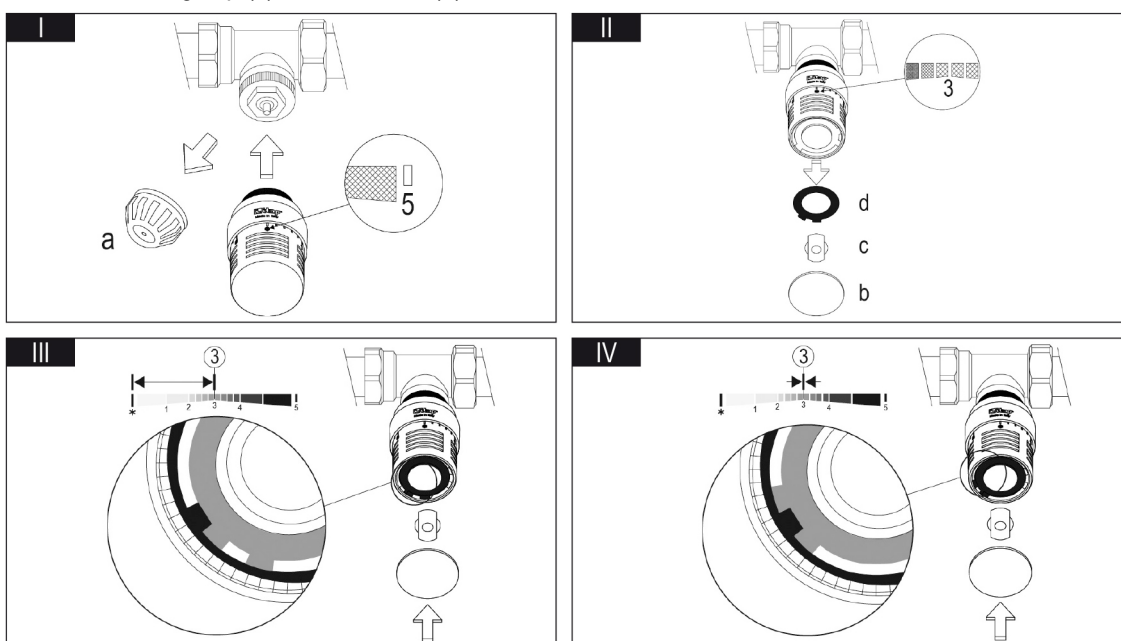



CONVERTIBLE VALVES AND LOCKSHIELDS

994C - 995C - 994V - 995V IN COMBINATION WITH 891 SERIES ACTUATOR:

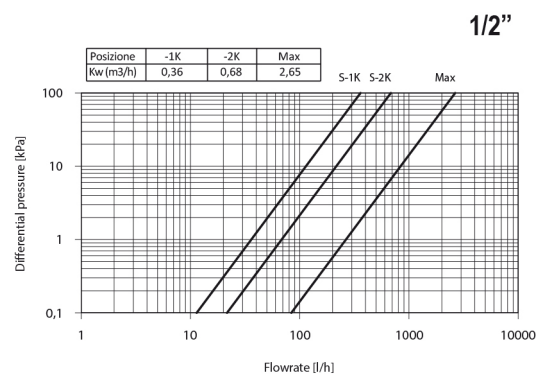
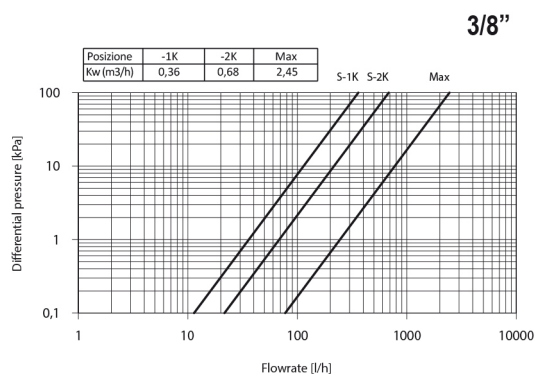

894C - 895C - 894V - 895V IN COMBINATION WITH 891 SERIES ACTUATOR:

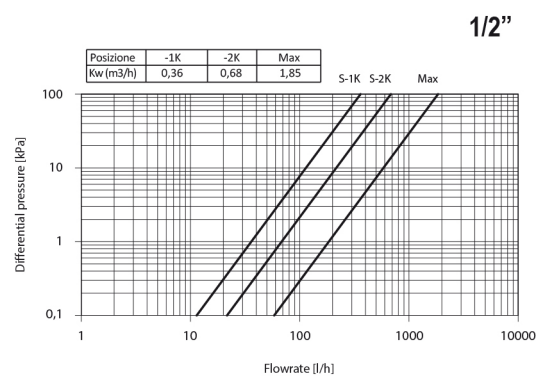
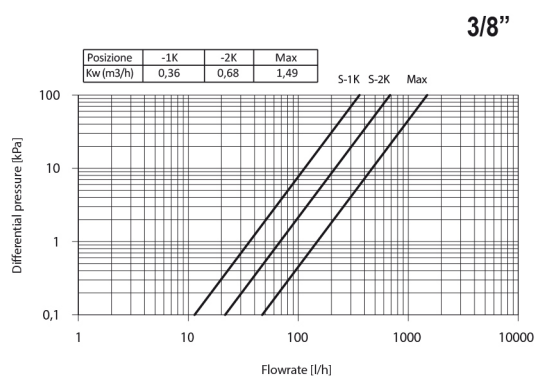

P max. 10 bar	ΔP max. 1,5 bar	T max. 110°C	Isteresi / Hysteresis C: 0,5 K	Tempo di risposta / Response time Z: 30 min.
Portata nominale / Nominal Flowrate qmN: 210 l/h				
Influenza pressione differenziale / Differential pressure influence D: 0,75 K				



CONVERTIBLE VALVES AND LOCKSHIELDS

LOSS DIAGRAM (With water) size 3/8"

KV	3/8"	1/2"
	1K:0,34;2K:0,63;MAX:1,12	1K:0,34;2K:0,63;MAX:1,32

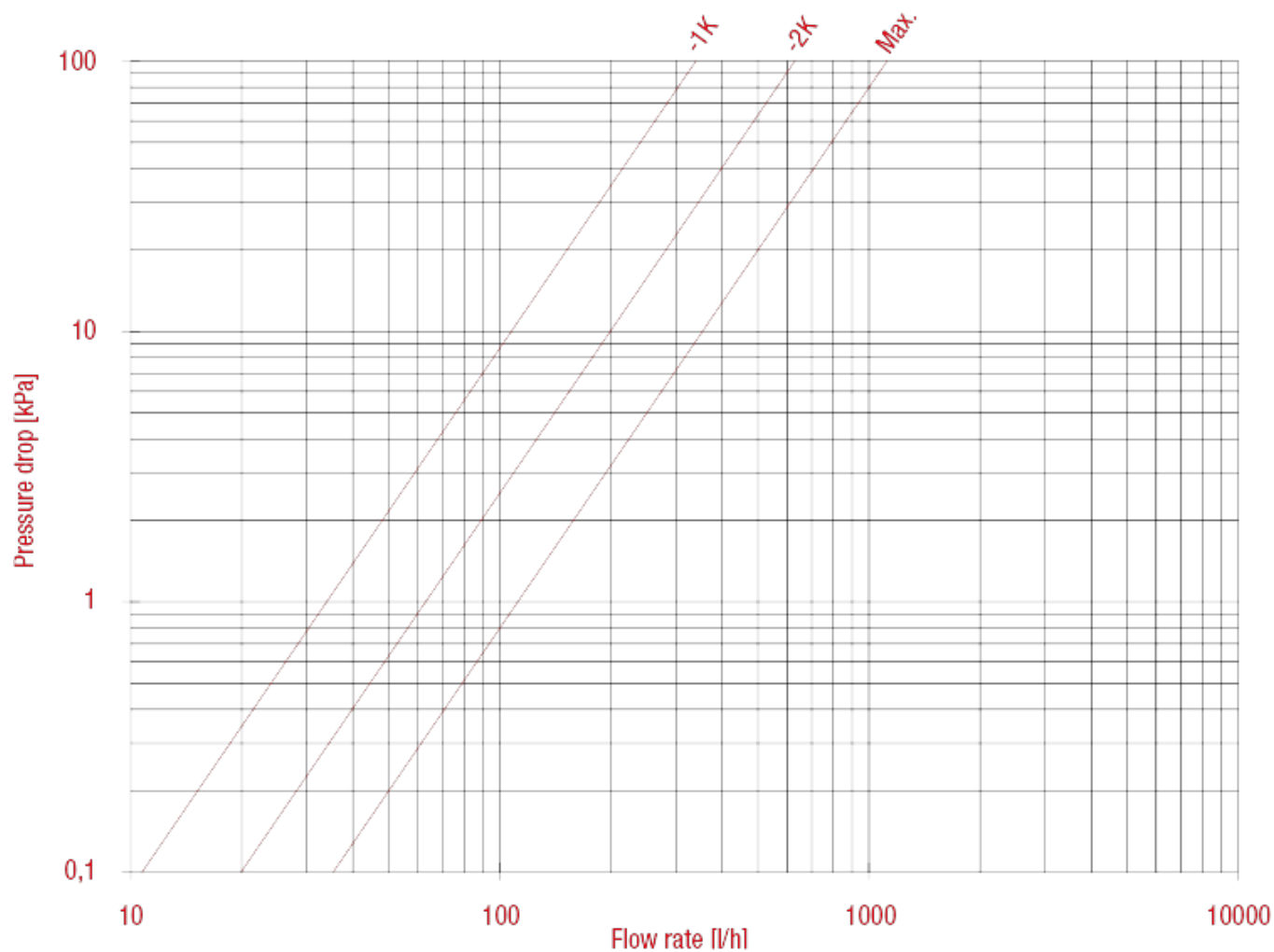



CONVERTIBLE VALVES AND LOCKSHIELDS

LOSS DIAGRAM (With water) size 1/2"

KV	3/8"	1/2"
	1K:0,34;2K:0,63;MAX:1,12	1K:0,34;2K:0,63;MAX:1,32

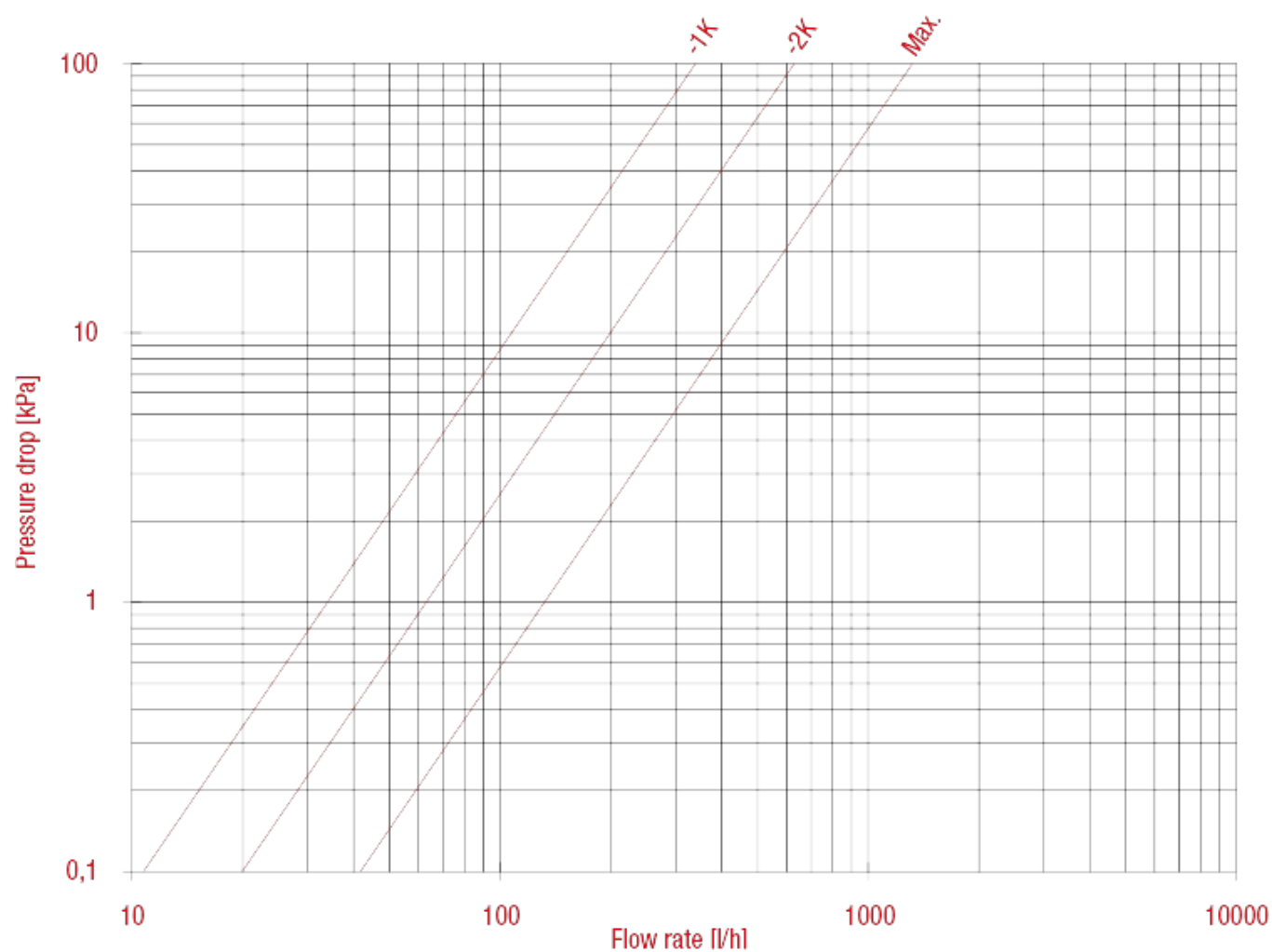



CONVERTIBLE VALVES AND LOCKSHIELDS

296S Straight lockshield, female thread

To be used with iron piping or, together with an Itap-Fit® connector (art. 618), with copper, crosslinked polyethylene (PEX) or polybutylene.

In the case of use with PEX or polybutylene it is also requested the use of the liner art. 655.



MEASURE	PRESSURE	CODE	PACKING
3/8" (DN 10)	10bar/145psi	2960038S	12/168
1/2" (DN 15)	10bar/145psi	2960012S	12/144
3/4" (DN 20)	10bar/145psi	2960034S	10/80

CERTIFICATIONS



TECHNICAL SPECIFICATIONS

Body in nickel-plated brass.

Maximum working temperature: 110°C.

Threads: ISO 228 (equivalent to DIN EN ISO 228 and BS EN ISO 228).

OVERALL DIMENSIONS

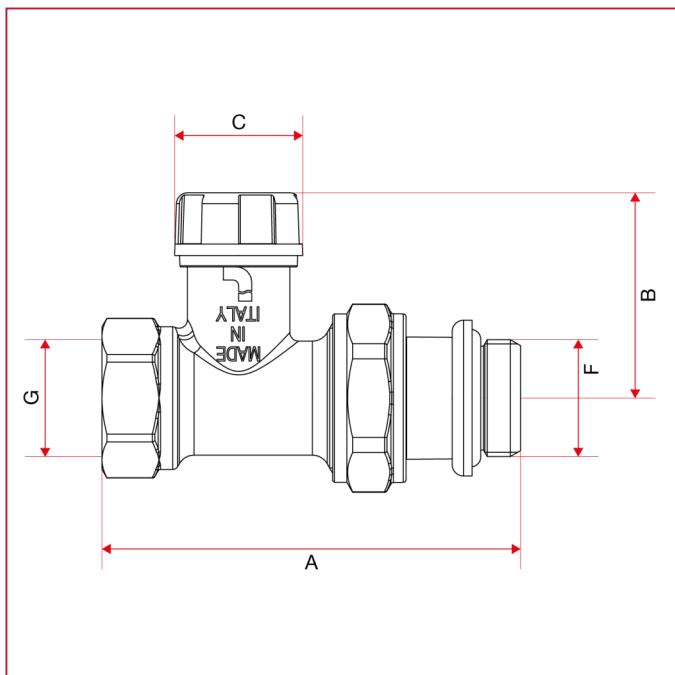



CONVERTIBLE VALVES AND LOCKSHIELDS

	3/8"	1/2"	3/4"
DN	10	15	20
A	72	73,5	77,5
B	36	36	39
C	22,5	22,5	25
F	3/8"	1/2"	3/4"
G	3/8"	1/2"	3/4"
Kg/cm ² bar	10	10	10
LBS - psi	145	145	145

MATERIALS

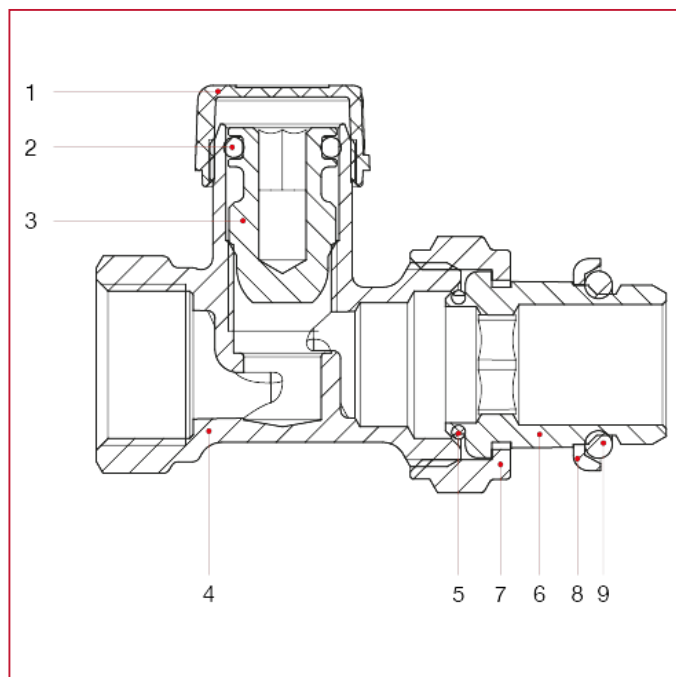

POS.	DESCRIPTION	N.	MATERIAL
1	Cap	1	ABS
2	O-ring	1	EPDM
3	Bonnet	1	Brass CW614N
4	Body	1	Nickel-plated brass CW617N
5	Washer	1	NBR
6	Union	1	Nickel-plated brass CW617N
7	Nut	1	Nickel-plated brass CW617N
8	Ring	1	Zinc-plated steel Fe
9	Washer	1	NBR



CONVERTIBLE VALVES AND LOCKSHIELDS

LOSS DIAGRAM (With water) size 3/8"

KV	3/8"	1/2"	3/4"
	1turn:0,4;2turn:0,9;3turn:1,1;MA X:1,26	1turn:0,6;2turn:1,2;3turn:1,6;MA X:1,72	1turn:0,6;2turn:0,9;3turn:1,5;MA X:2,15

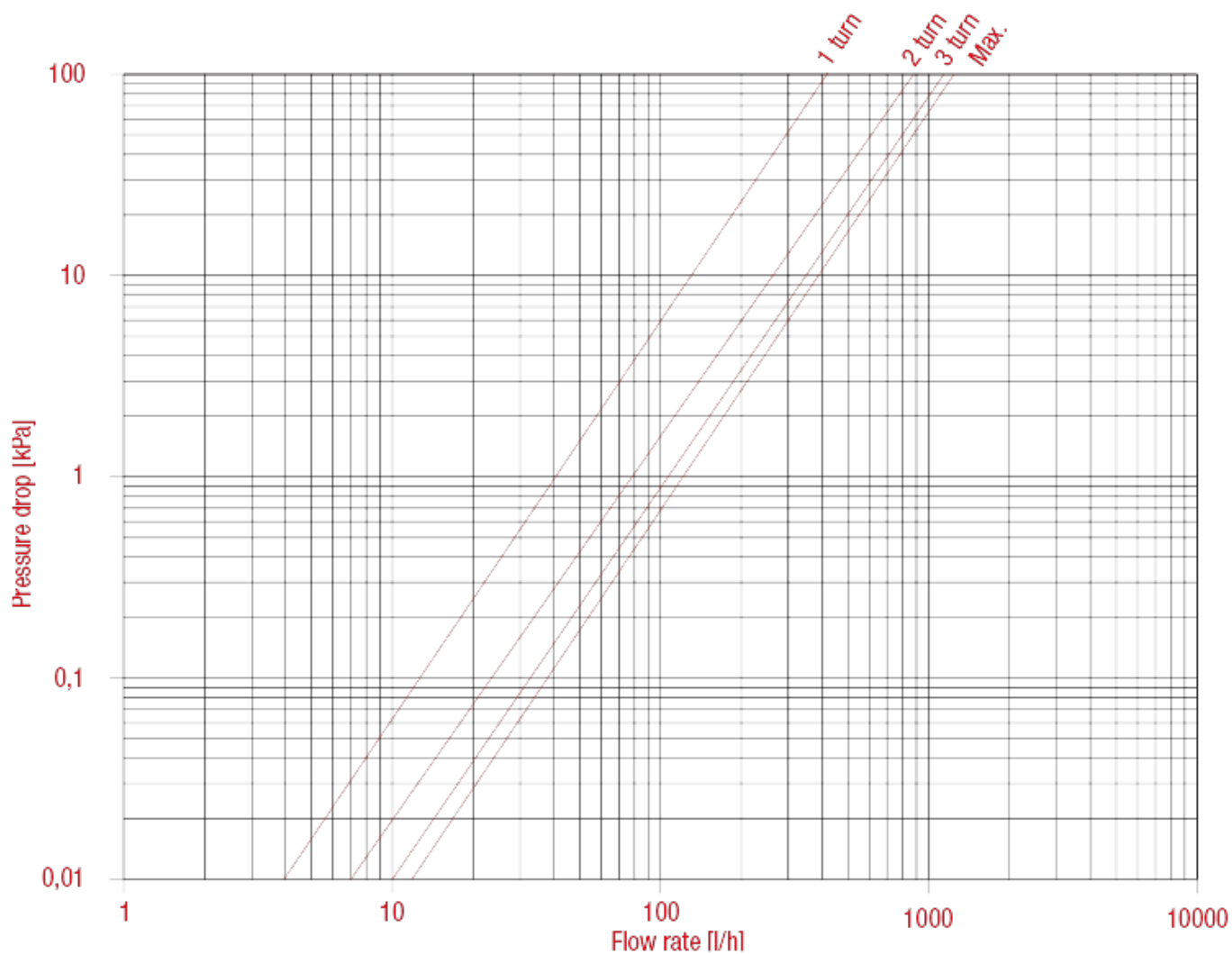



CONVERTIBLE VALVES AND LOCKSHIELDS

LOSS DIAGRAM (With water) size 1/2"

KV	3/8"	1/2"	3/4"
	1turn:0,4;2turn:0,9;3turn:1,1;MA X:1,26	1turn:0,6;2turn:1,2;3turn:1,6;MA X:1,72	1turn:0,6;2turn:0,9;3turn:1,5;MA X:2,15

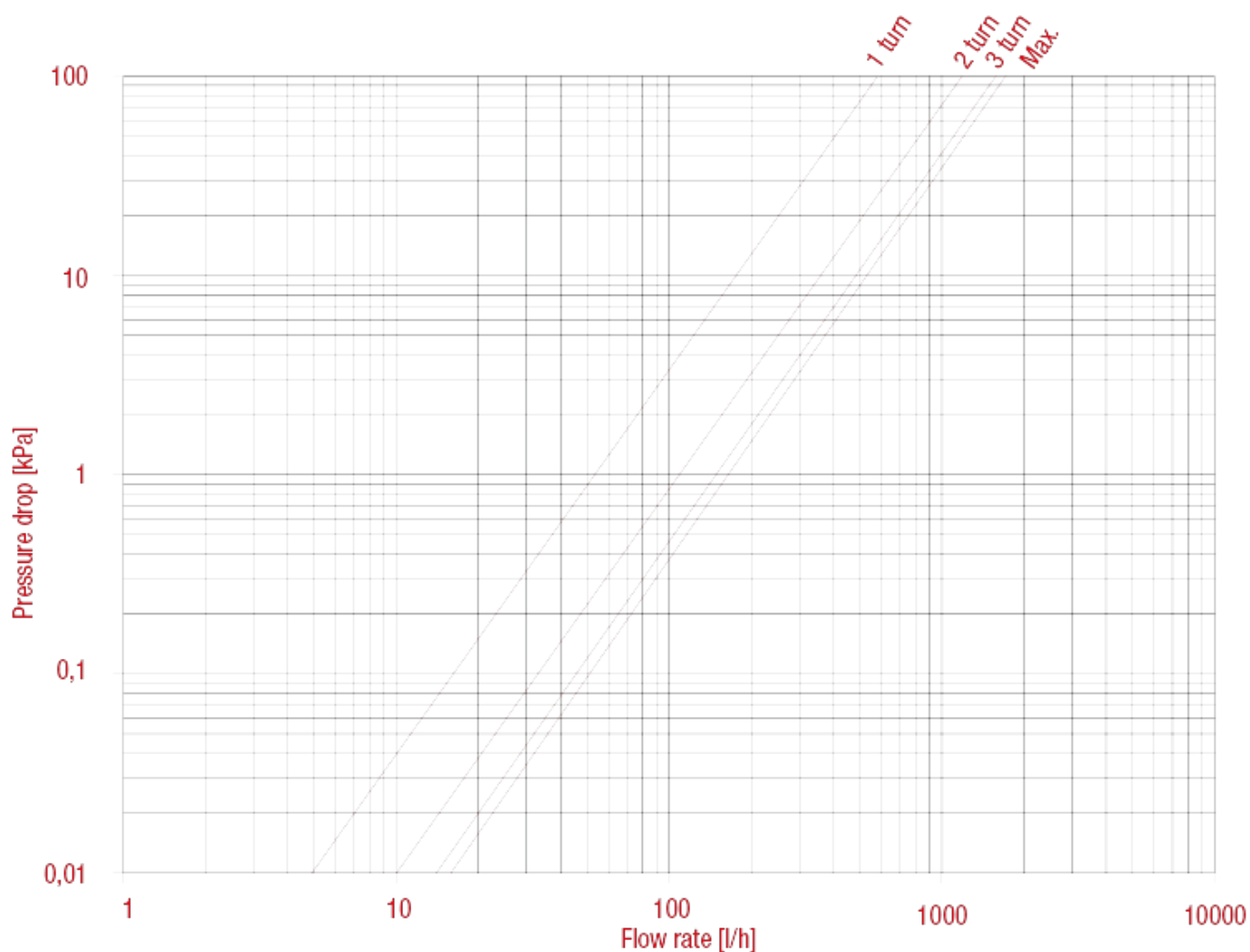



CONVERTIBLE VALVES AND LOCKSHIELDS

LOSS DIAGRAM (With water) size 3/4"

KV	3/8"	1/2"	3/4"
	1turn:0,4;2turn:0,9;3turn:1,1;MA X:1,26	1turn:0,6;2turn:1,2;3turn:1,6;MA X:1,72	1turn:0,6;2turn:0,9;3turn:1,5;MA X:2,15

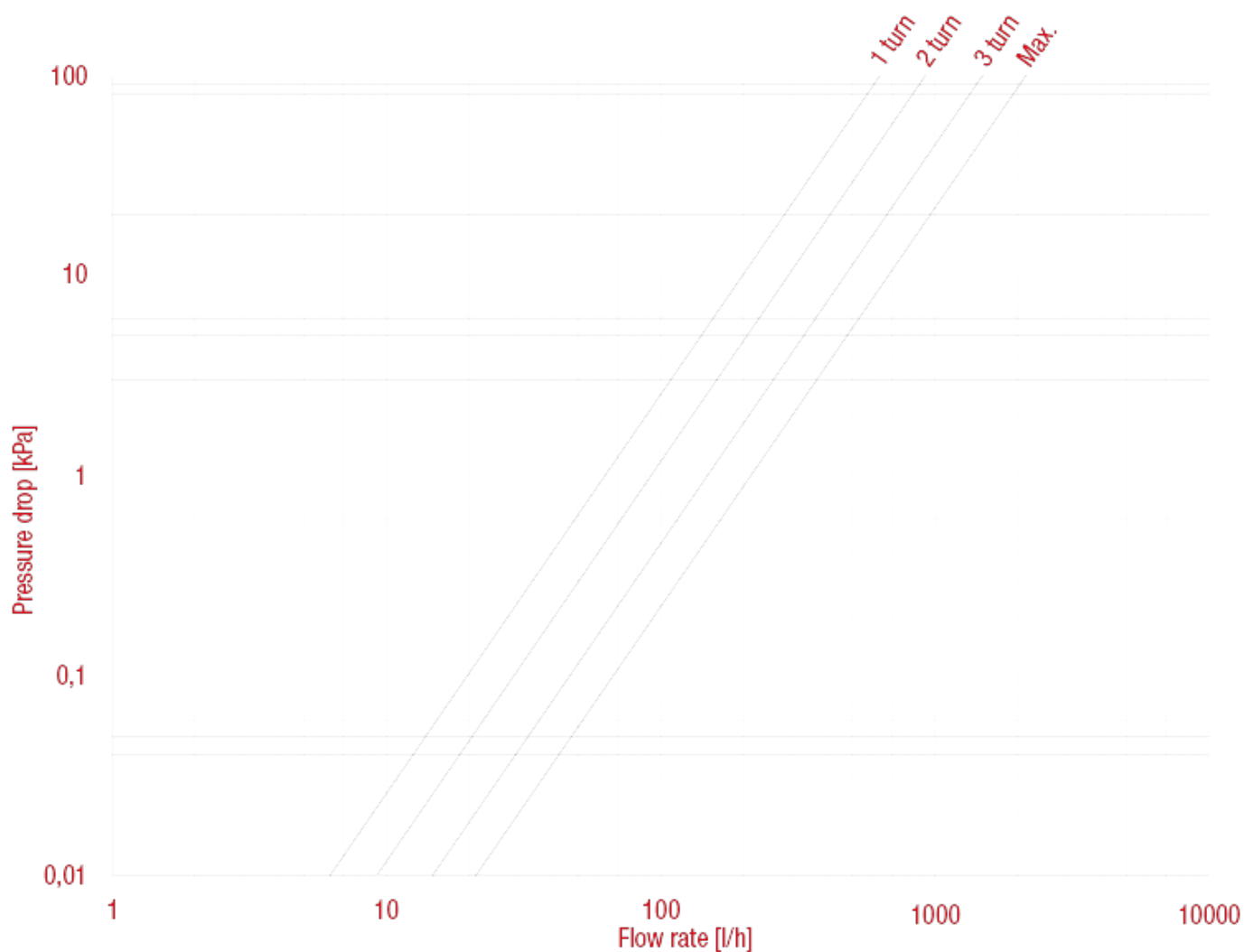



CONVERTIBLE VALVES AND LOCKSHIELDS

895V Straight convertible valve with handle, male thread

To be used with multilayer, PEX or polybutylene piping, together with 595M or 510 Multi-Fit® connectors.

Suitable also for copper piping, together with a compression fitting art. 595.

The male thread "G" is equipped with a conical seat and inner diameter mm.16.



MEASURE	PRESSURE	CODE	PACKING
3/8" (DN 10)	10bar/145psi	8950038V	4/56
1/2" (DN 15)	10bar/145psi	8950012V	4/56

CERTIFICATIONS



TECHNICAL SPECIFICATIONS

Body in nickel-plated brass.

Maximum working temperature: 110°C.

Threads: ISO 228 (equivalent to DIN EN ISO 228 and BS EN ISO 228).

Suitable for thermostatic control heads art. 891, art. 891R, art. 891SD.

OVERALL DIMENSIONS

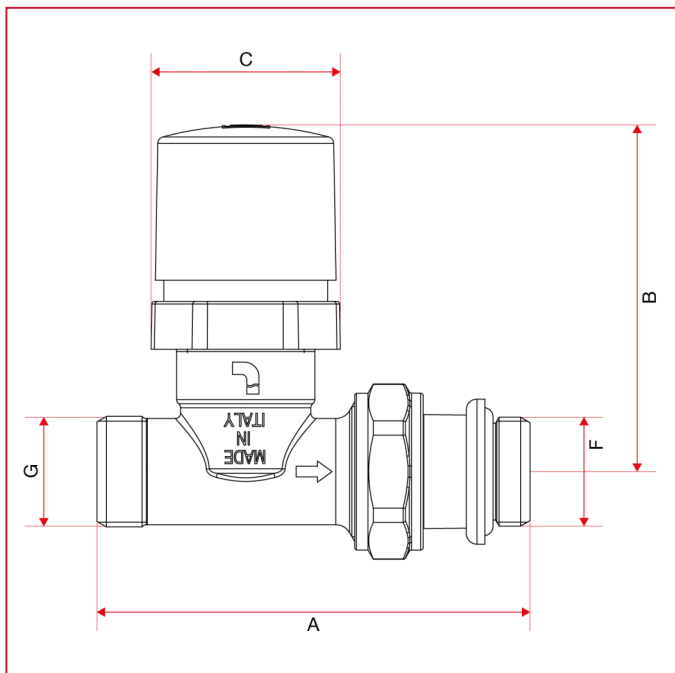



CONVERTIBLE VALVES AND LOCKSHIELDS

	3/8"	1/2"
DN	10	15
A	75,5	81,5
B	65,3	65,3
C	35,6	35,6
F	3/8"	1/2"
G	1/2"	1/2"
Kg/cm ² bar	10	10
LBS - psi	145	145



CONVERTIBLE VALVES AND LOCKSHIELDS

MATERIALS

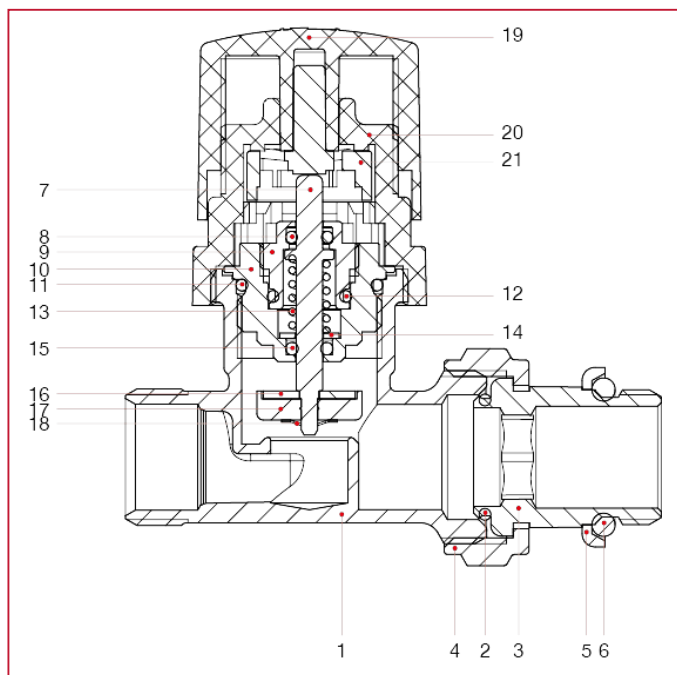

POS.	DESCRIPTION	N.	MATERIAL
1	Body	1	Nickel-plated brass CW617N
2	Washer	1	NBR
3	Union	1	Nickel-plated brass CW617N
4	Nut	1	Nickel-plated brass CW617N
5	Ring	1	Zinc-plated steel Fe
6	Washer	1	NBR
7	Stem	1	Brass CW614N
8	Washer	1	EPDM
9	Ring nut	1	Brass CW614N
10	Body	1	Brass CW614N
11	O-ring	1	EPDM
12	O-ring	1	EPDM
13	Spring	1	Stainless steel AISI 302
14	Washer	1	Stainless steel AISI 304
15	O-ring	1	EPDM
16	Washer	1	Stainless steel AISI 304
17	Washer	1	EPDM
18	Seeger	1	Stainless steel AISI 304
19	Cap	1	ABS
20	Body	1	ABS
21	Hook	1	Polycarbonate



CONVERTIBLE VALVES AND LOCKSHIELDS

INSTRUCTIONS

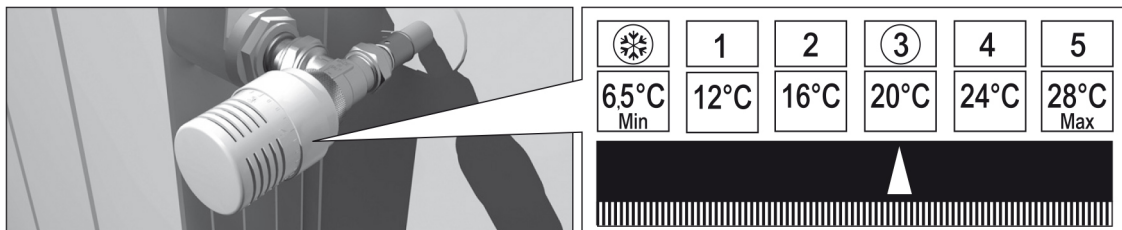

Set the head in the required position:

Use a screwdriver to disassemble the cover (b), the locking cap (c) and the first of the toothed washer (d) FIG. II.

Reassemble the washer (d) as in FIG. III if you want to limit the setting from * to 3.

Reassemble the washer (d) as in FIG IV if you want to block the setting at the value of 3.

Then reassemble the locking cap (c) and the cover (b).

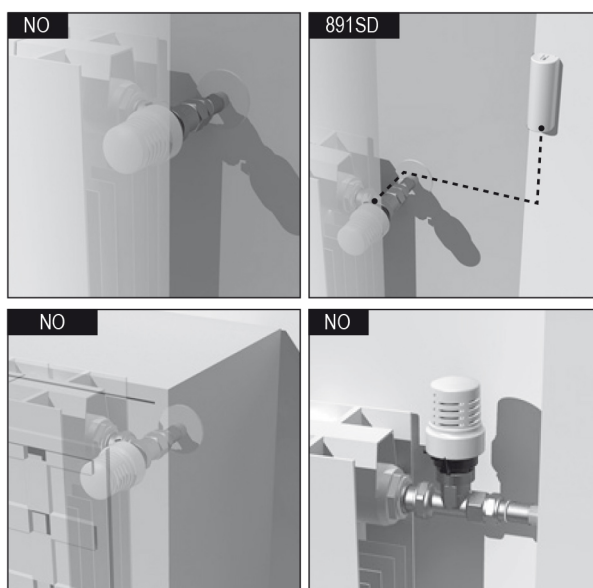
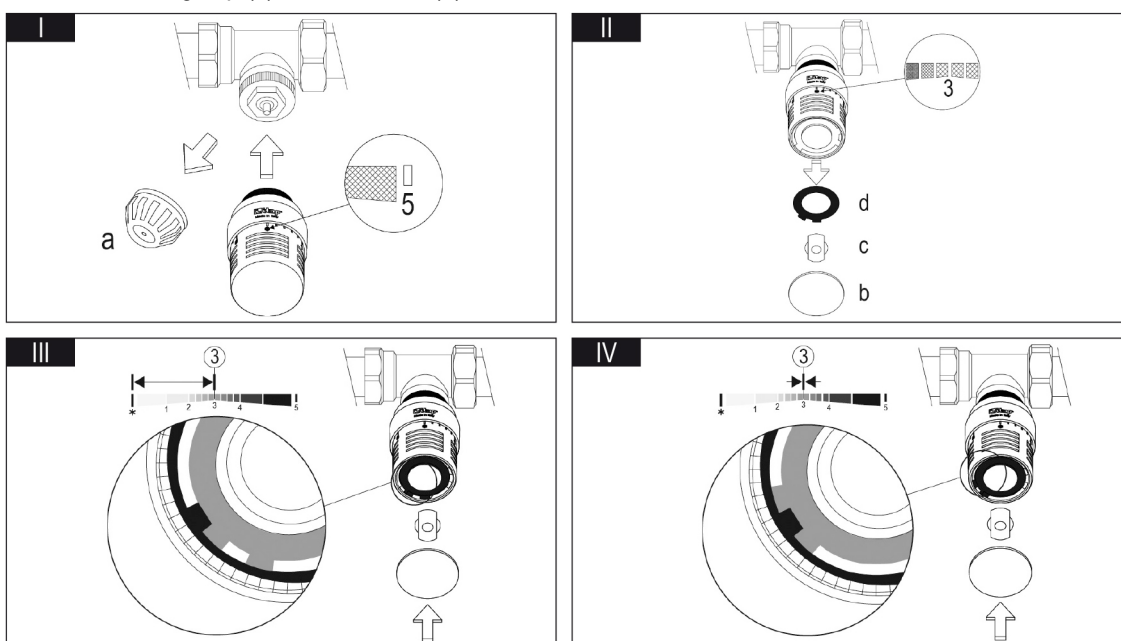



CONVERTIBLE VALVES AND LOCKSHIELDS

994C - 995C - 994V - 995V IN COMBINATION WITH 891 SERIES ACTUATOR:

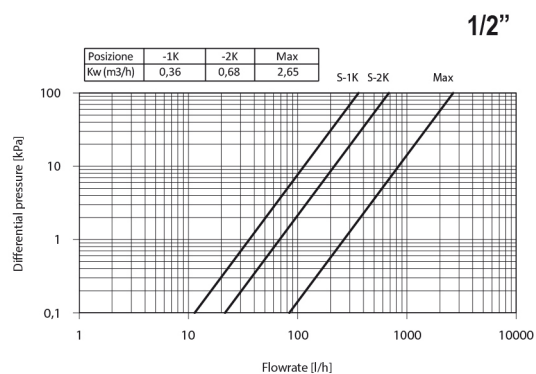
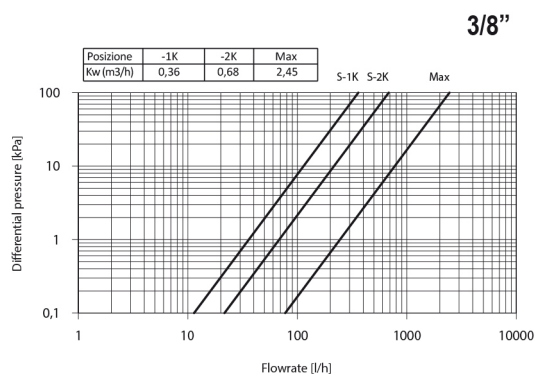

894C - 895C - 894V - 895V IN COMBINATION WITH 891 SERIES ACTUATOR:

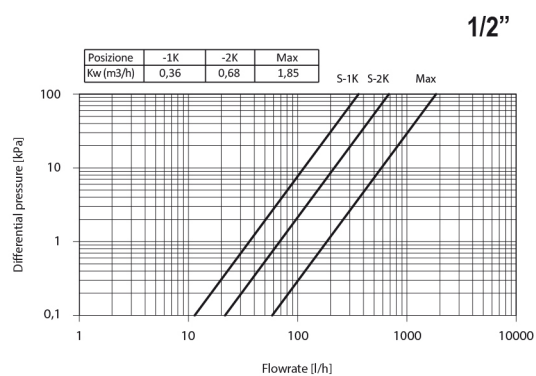
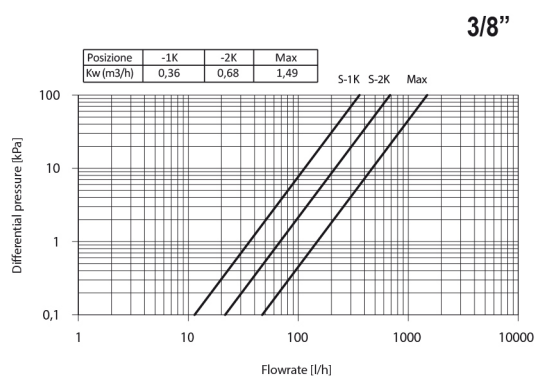

P max. 10 bar	ΔP max. 1,5 bar	T max. 110°C	Isteresi / Hysteresis C: 0,5 K	Tempo di risposta / Response time Z: 30 min.
Portata nominale / Nominal Flowrate qmN: 210 l/h				
Influenza pressione differenziale / Differential pressure influence D: 0,75 K				



CONVERTIBLE VALVES AND LOCKSHIELDS

LOSS DIAGRAM (With water) size 3/8"

KV	3/8"	1/2"
	1K:0,34;2K:0,63;MAX:1,12	1K:0,34;2K:0,63;MAX:1,32

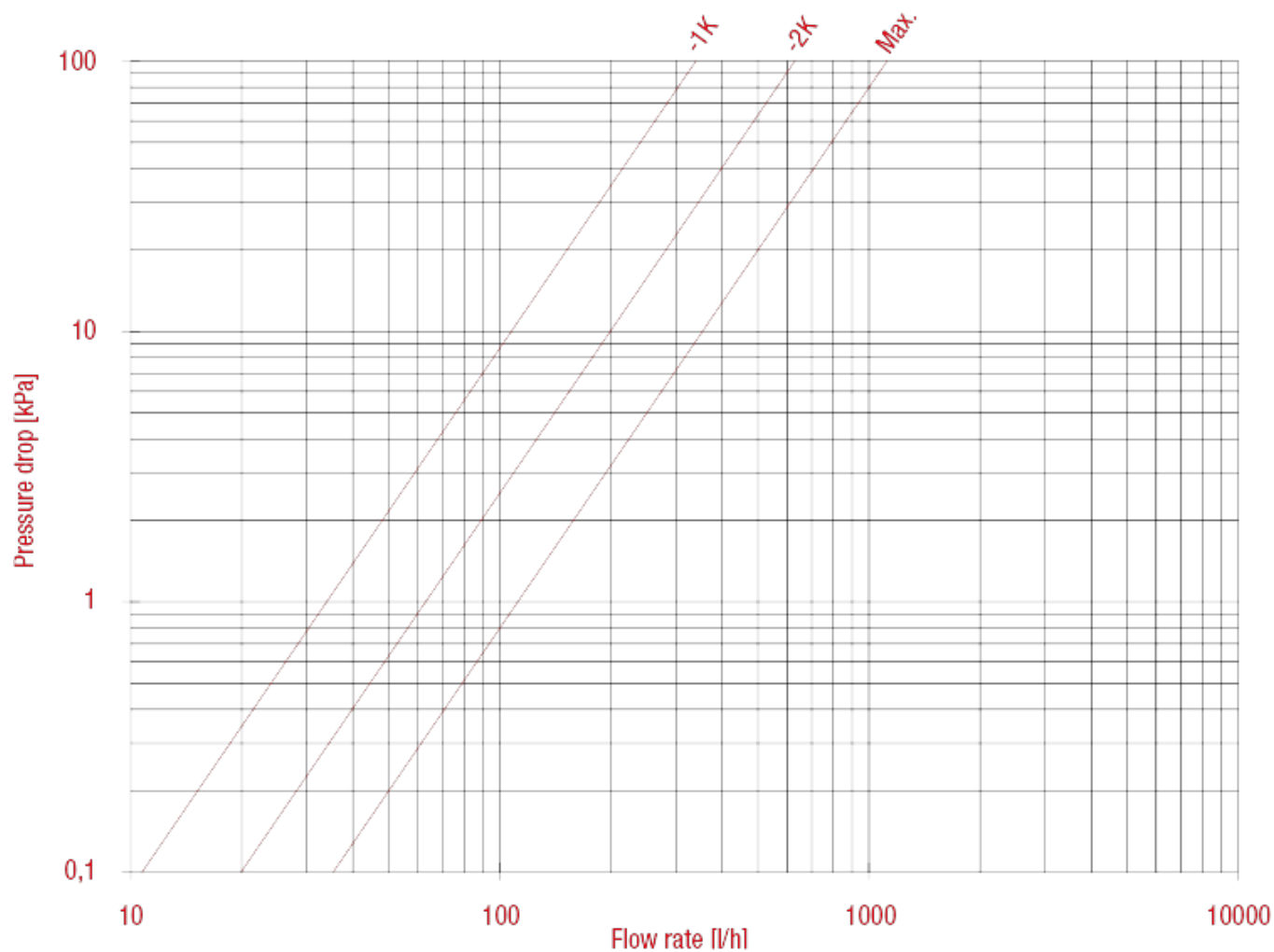



CONVERTIBLE VALVES AND LOCKSHIELDS

LOSS DIAGRAM (With water) size 1/2"

KV	3/8"	1/2"
	1K:0,34;2K:0,63;MAX:1,12	1K:0,34;2K:0,63;MAX:1,32

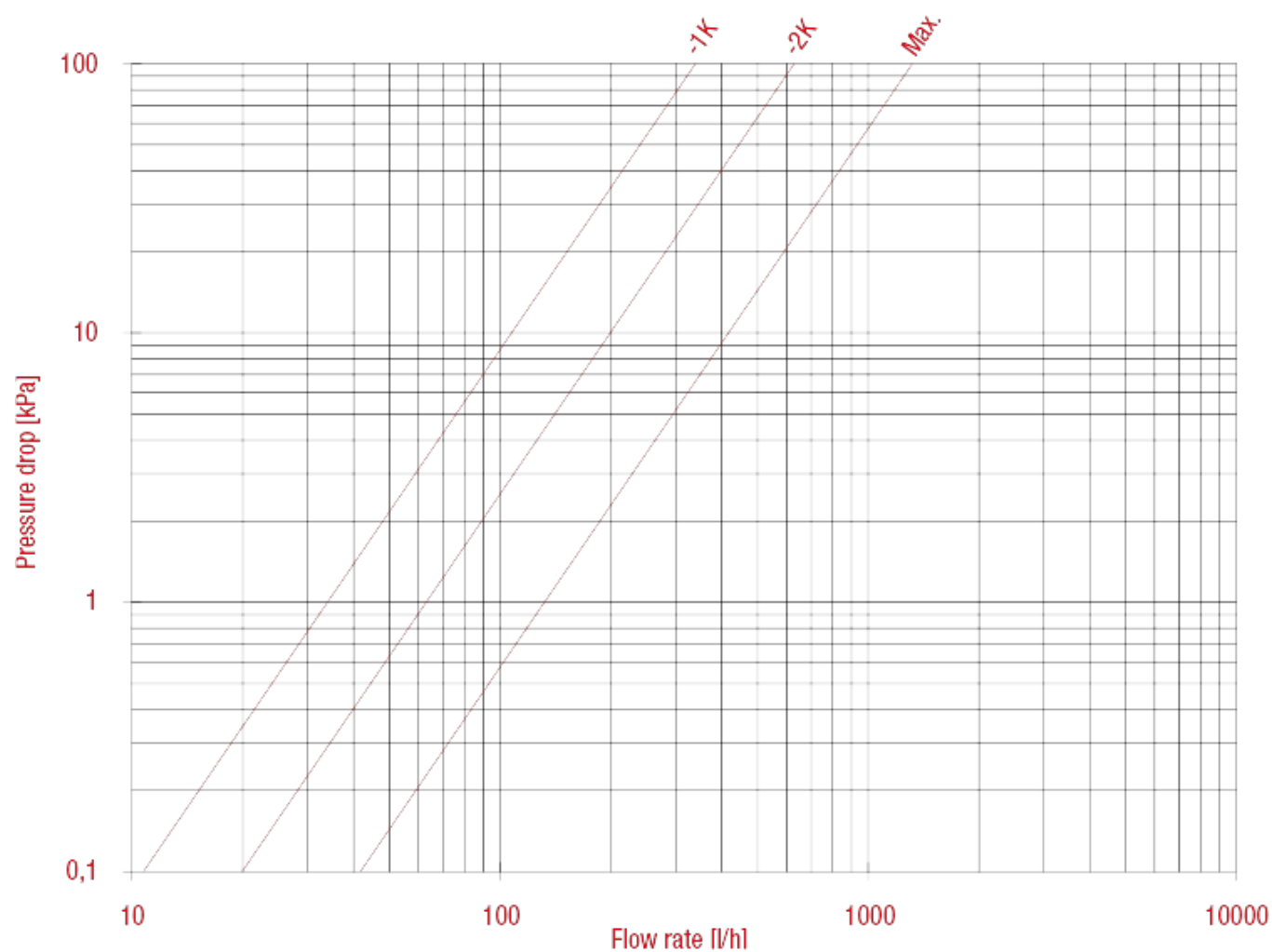



CONVERTIBLE VALVES AND LOCKSHIELDS

895C Straight convertible valve with cap, male thread

To be used with multilayer, PEX or polybutylene piping, together with 595M or 510 Multi-Fit® connectors.

Suitable also for copper piping, together with a compression fitting art. 595.

The male thread "G" is equipped with a conical seat and inner diameter mm.16.



MEASURE	PRESSURE	CODE	PACKING
3/8" (DN 10)	10bar/145psi	8950038C	4/88
1/2" (DN 15)	10bar/145psi	8950012C	4/88

CERTIFICATIONS



TECHNICAL SPECIFICATIONS

Body in nickel-plated brass.

Maximum working temperature: 110°C.

Threads: ISO 228 (equivalent to DIN EN ISO 228 and BS EN ISO 228).

Suitable for thermostatic control heads art. 891, art. 891R, art. 891SD.

OVERALL DIMENSIONS

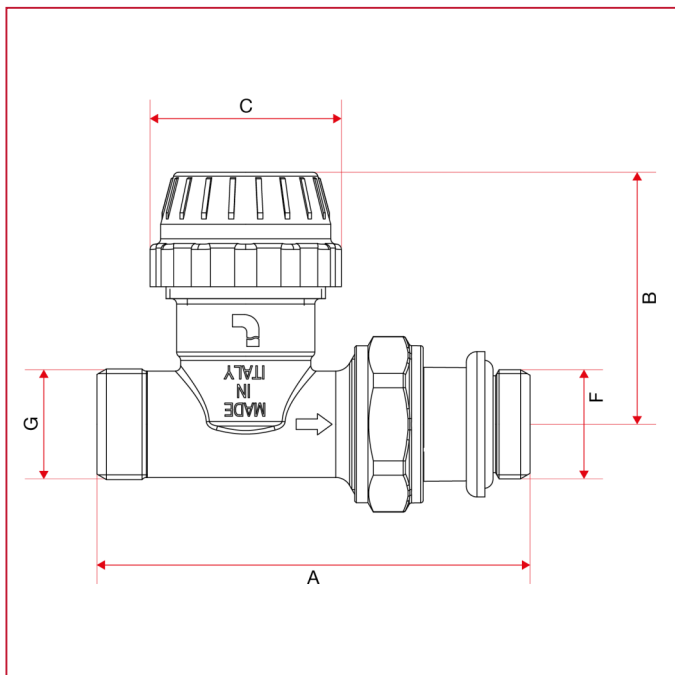



CONVERTIBLE VALVES AND LOCKSHIELDS

	3/8"	1/2"
DN	10	15
A	75,5	81,5
B	47,3	47,3
C	36	36
F	3/8"	1/2"
G	1/2"	1/2"
Kg/cm2 bar	10	10
LBS - psi	145	145

MATERIALS

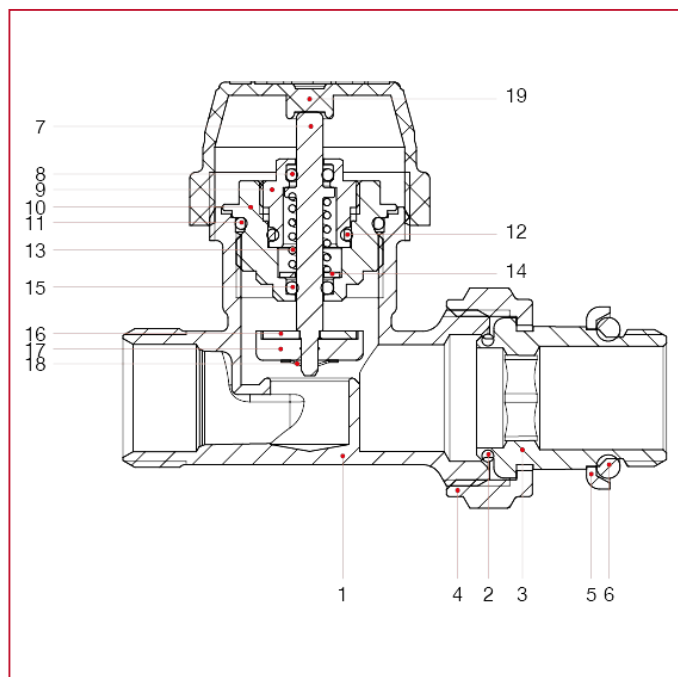

POS.	DESCRIPTION	N.	MATERIAL
1	Body	1	Nickel-plated brass CW617N
2	Washer	1	NBR
3	Union	1	Nickel-plated brass CW617N
4	Nut	1	Nickel-plated brass CW617N
5	Ring	1	Zinc-plated steel Fe
6	Washer	1	NBR
7	Stem	1	Brass CW614N
8	Washer	1	EPDM
9	Ring nut	1	Brass CW614N
10	Body	1	Brass CW614N
11	O-ring	1	EPDM
12	O-ring	1	EPDM
13	Spring	1	Stainless steel AISI 302
14	Washer	1	Stainless steel AISI 304
15	O-ring	1	EPDM
16	Washer	1	Stainless steel AISI 304
17	Washer	1	EPDM
18	Seeger	1	Stainless steel AISI 304
19	Cap	1	ABS



CONVERTIBLE VALVES AND LOCKSHIELDS

INSTRUCTIONS

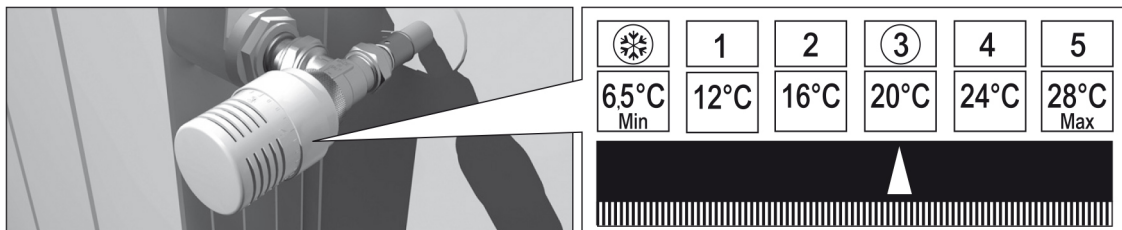

Set the head in the required position:

Use a screwdriver to disassemble the cover (b), the locking cap (c) and the first of the toothed washer (d) FIG. II.

Reassemble the washer (d) as in FIG. III if you want to limit the setting from * to 3.

Reassemble the washer (d) as in FIG IV if you want to block the setting at the value of 3.

Then reassemble the locking cap (c) and the cover (b).

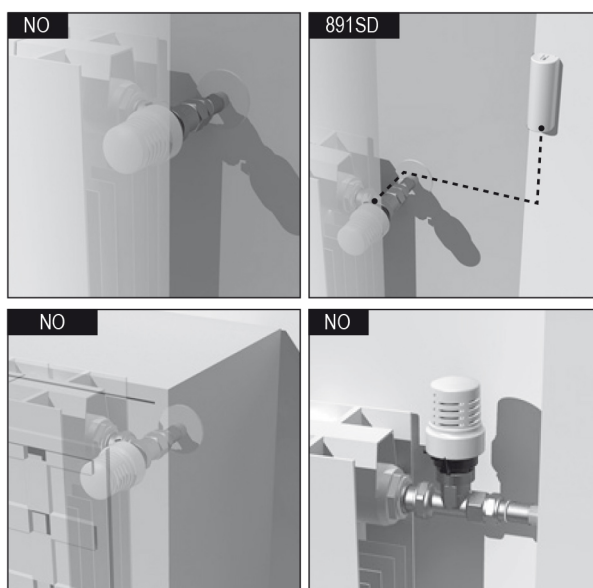
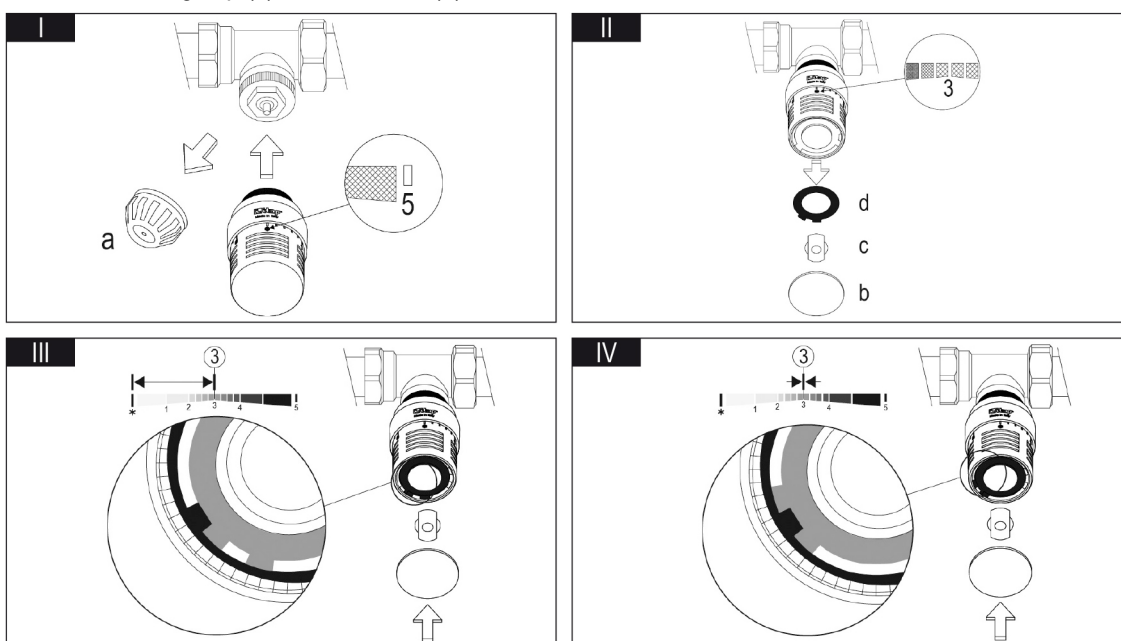



CONVERTIBLE VALVES AND LOCKSHIELDS

994C - 995C - 994V - 995V IN COMBINATION WITH 891 SERIES ACTUATOR:

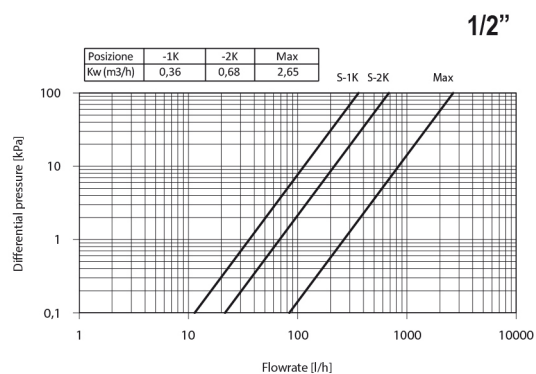
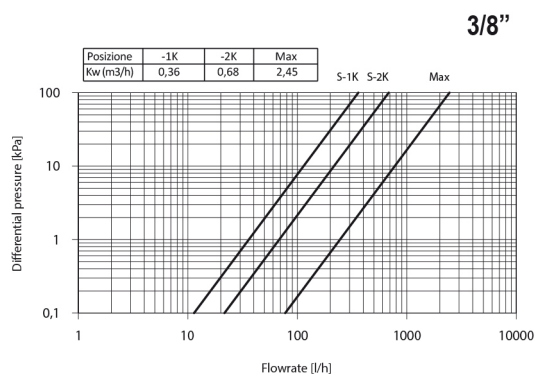

894C - 895C - 894V - 895V IN COMBINATION WITH 891 SERIES ACTUATOR:

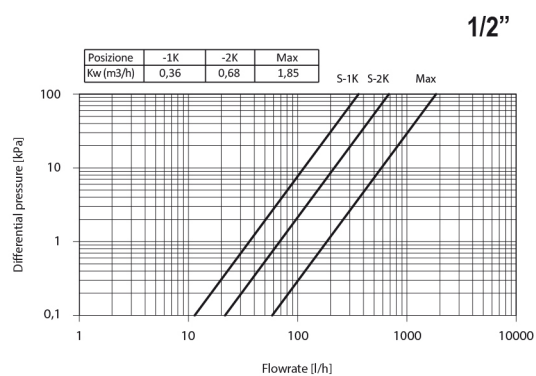
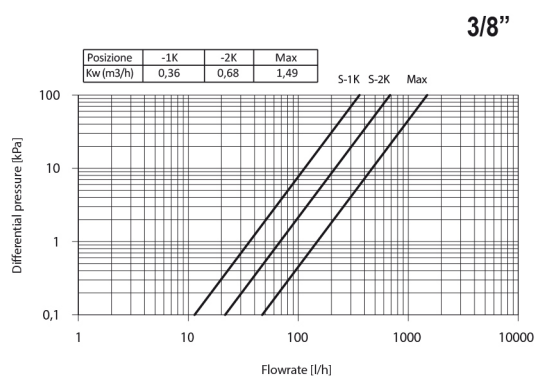

P max. 10 bar	ΔP max. 1,5 bar	T max. 110°C	Isteresi / Hysteresis C: 0,5 K	Tempo di risposta / Response time Z: 30 min.
Portata nominale / Nominal Flowrate qmN: 210 l/h				
Influenza pressione differenziale / Differential pressure influence D: 0,75 K				



CONVERTIBLE VALVES AND LOCKSHIELDS

LOSS DIAGRAM (With water) size 3/8"

KV	3/8"	1/2"
	1K:0,34;2K:0,63;MAX:1,12	1K:0,34;2K:0,63;MAX:1,32

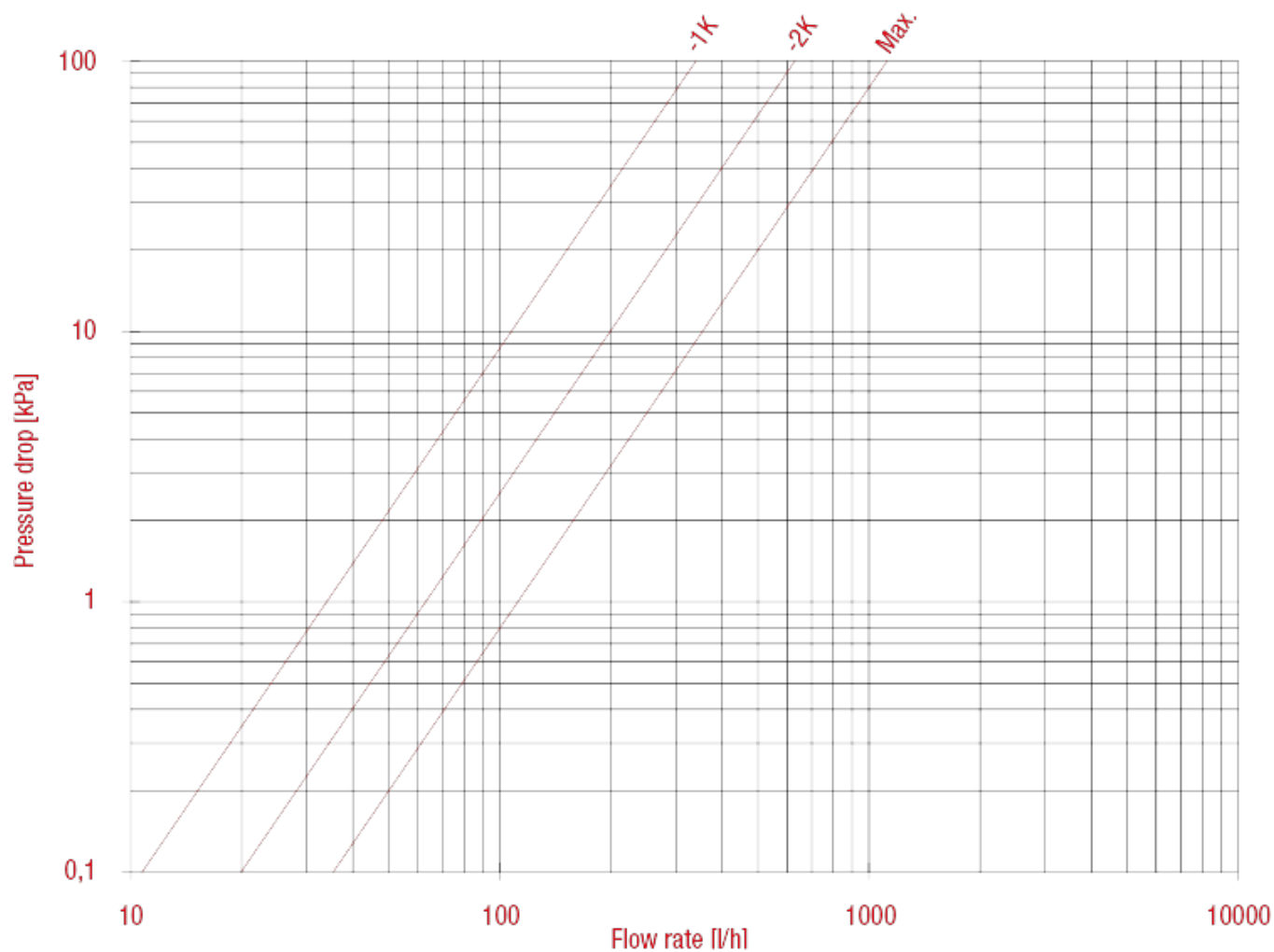



CONVERTIBLE VALVES AND LOCKSHIELDS

LOSS DIAGRAM (With water) size 1/2"

KV	3/8"	1/2"
	1K:0,34;2K:0,63;MAX:1,12	1K:0,34;2K:0,63;MAX:1,32

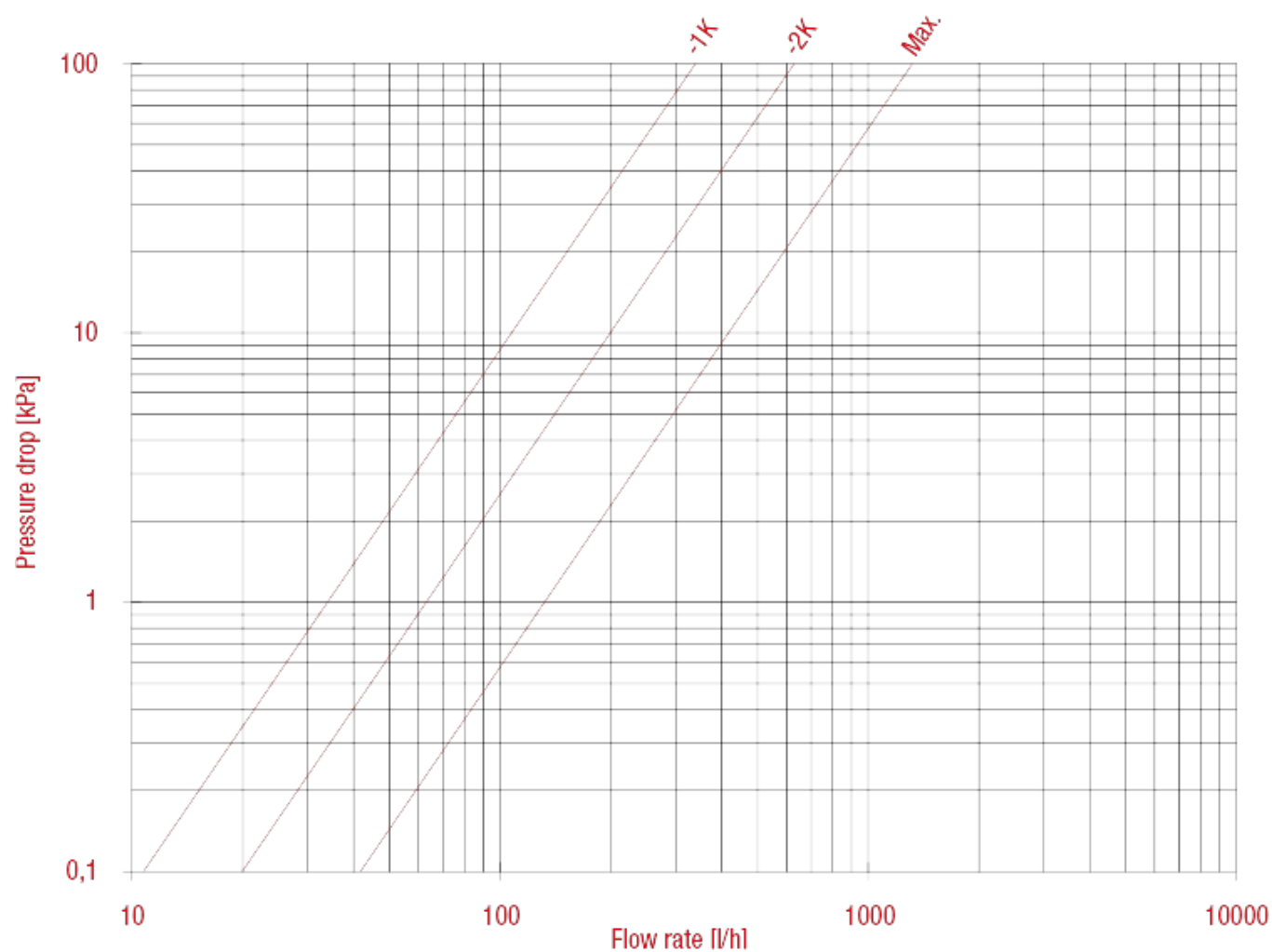



CONVERTIBLE VALVES AND LOCKSHIELDS

297S Straight lockshield, male thread

To be used with multilayer, PEX or polybutylene piping, together with 595M or 510 Multi-Fit® connectors.

Suitable also for copper piping, together with a compression fitting art. 595.

The male thread "G" is equipped with a conical seat and inner diameter mm.16.



MEASURE	PRESSURE	CODE	PACKING
3/8" (DN 10)	10bar/145psi	2970038S	12/144
1/2" (DN 15)	10bar/145psi	2970012S	12/132

CERTIFICATIONS



TECHNICAL SPECIFICATIONS

Body in nickel-plated brass.

Maximum working temperature: 110°C.

Threads: ISO 228 (equivalent to DIN EN ISO 228 and BS EN ISO 228).

OVERALL DIMENSIONS

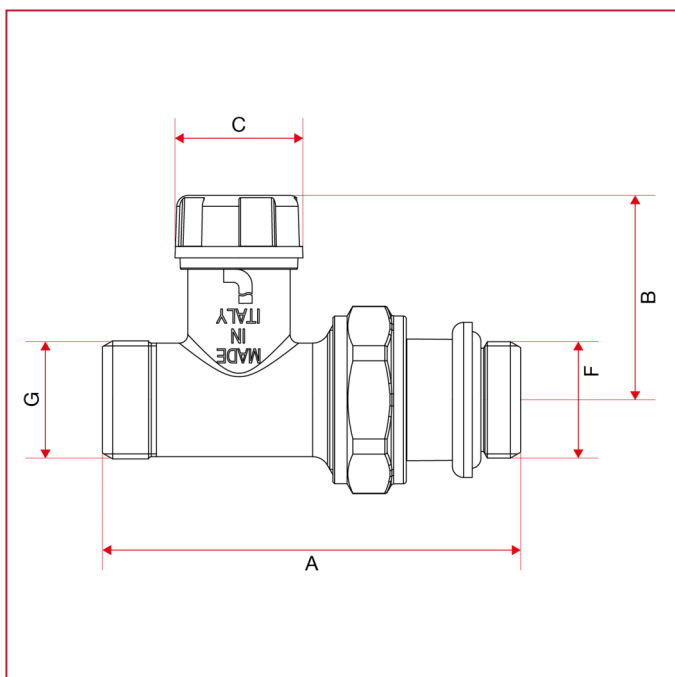



CONVERTIBLE VALVES AND LOCKSHIELDS

	3/8"	1/2"
DN	10	15
A	72	73,5
B	36	36
C	22,5	22,5
F	3/8"	1/2"
G	1/2"	1/2"
Kg/cm2 bar	10	10
LBS - psi	145	145

MATERIALS

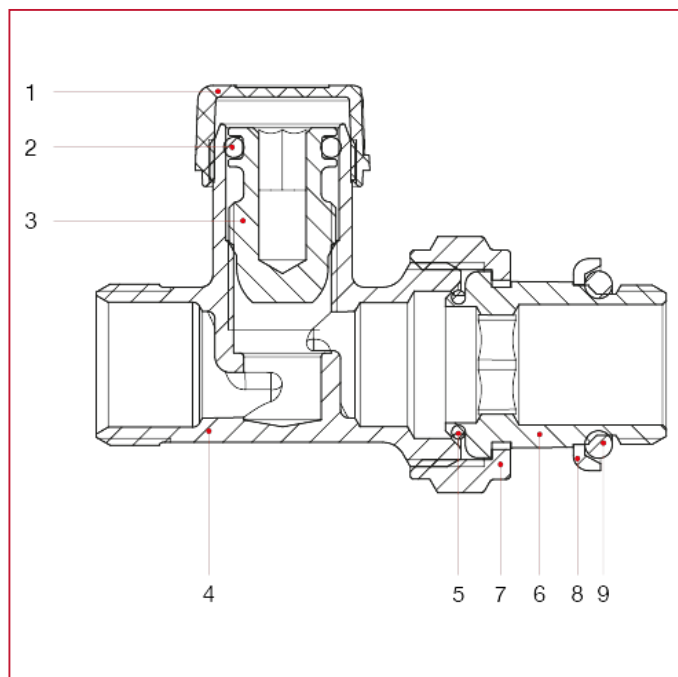

POS.	DESCRIPTION	N.	MATERIAL
1	Cap	1	ABS
2	O-ring	1	EPDM
3	Bonnet	1	Brass CW614N
4	Body	1	Nickel-plated brass CW617N
5	Washer	1	NBR
6	Union	1	Nickel-plated brass CW617N
7	Nut	1	Nickel-plated brass CW617N
8	Ring	1	Zinc-plated steel Fe
9	Washer	1	NBR



CONVERTIBLE VALVES AND LOCKSHIELDS

LOSS DIAGRAM (With water) size 3/8"

KV	3/8"	1/2"
	1turn:0,4;2turn:0,9;3turn:1,1;MAX:1,26	1turn:0,6;2turn:1,2;3turn:1,6;MAX:1,72

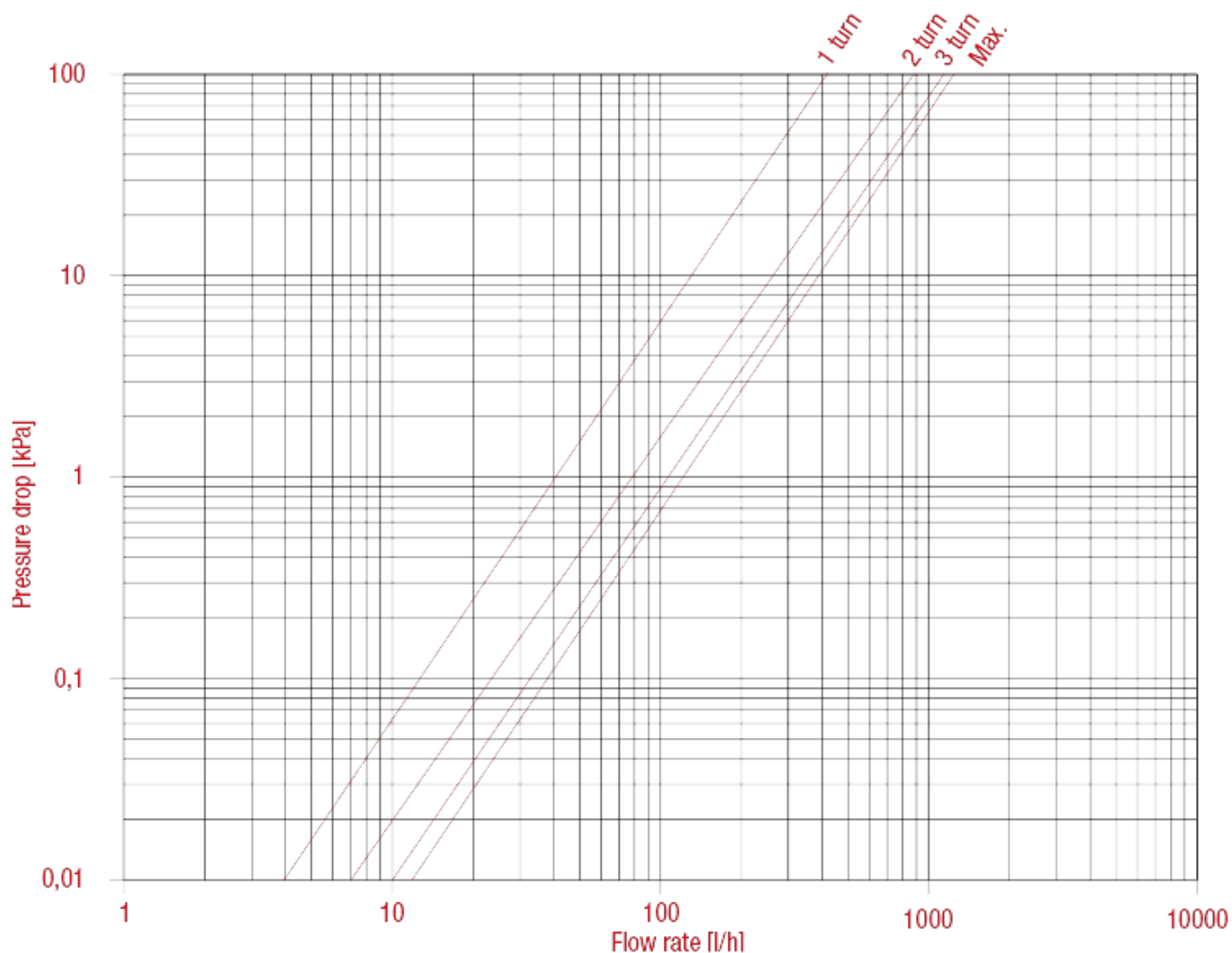



CONVERTIBLE VALVES AND LOCKSHIELDS

LOSS DIAGRAM (With water) size 1/2"

KV	3/8"	1/2"
	1turn:0,4;2turn:0,9;3turn:1,1;MAX:1,26	1turn:0,6;2turn:1,2;3turn:1,6;MAX:1,72

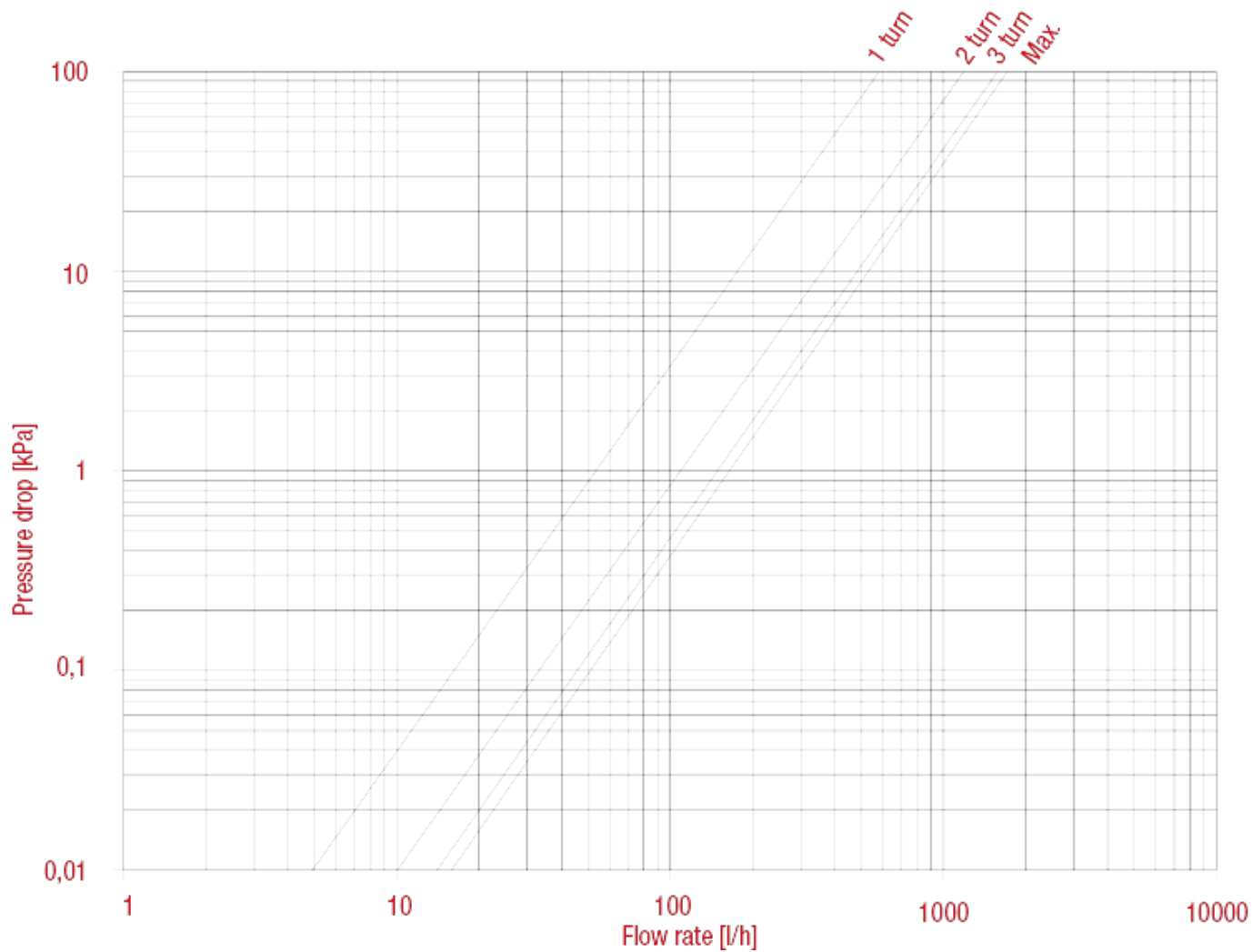



CONVERTIBLE VALVES AND LOCKSHIELDS

994V Angle convertible valve with handle, female thread

To be used with iron piping or, together with an Itap-Fit® connector (art. 618), with copper, crosslinked polyethylene (PEX) or polybutylene.

In the case of use with PEX or polybutylene it is also requested the use of the liner art. 655.



MEASURE	PRESSURE	CODE	PACKING
3/8" (DN 10)	10bar/145psi	9940038V	4/56
1/2" (DN 15)	10bar/145psi	9940012V	4/56

CERTIFICATIONS



TECHNICAL SPECIFICATIONS

Body in nickel-plated brass.

Maximum working temperature: 110°C.

Threads: ISO 228 (equivalent to DIN EN ISO 228 and BS EN ISO 228).

Suitable for thermostatic control heads art. 891, art. 891R, art. 891SD.

OVERALL DIMENSIONS

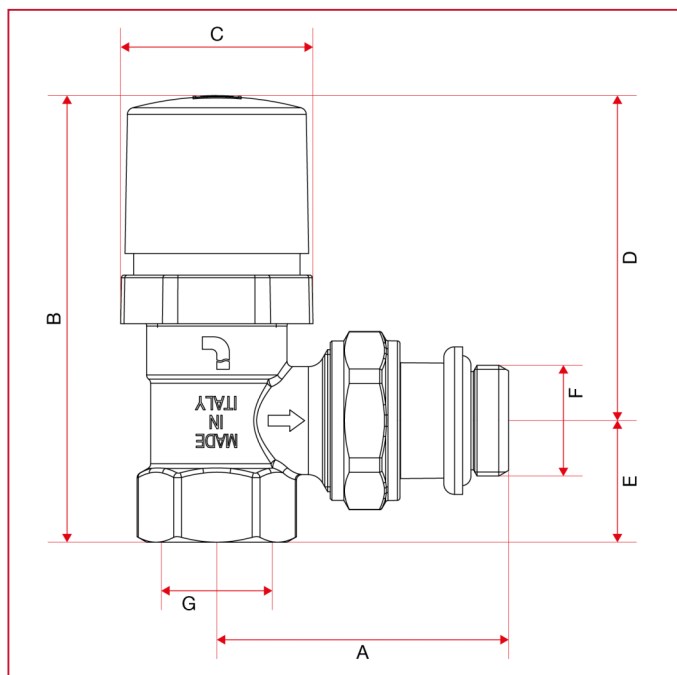



CONVERTIBLE VALVES AND LOCKSHIELDS

	3/8"	1/2"
DN	10	15
A	50	53,5
B	80,7	82,7
C	35,6	35,6
D	60,2	60,2
E	20,5	22,5
F	3/8"	1/2"
G	3/8"	1/2"
Kg/cm ² bar	10	10
LBS - psi	145	145



CONVERTIBLE VALVES AND LOCKSHIELDS

MATERIALS

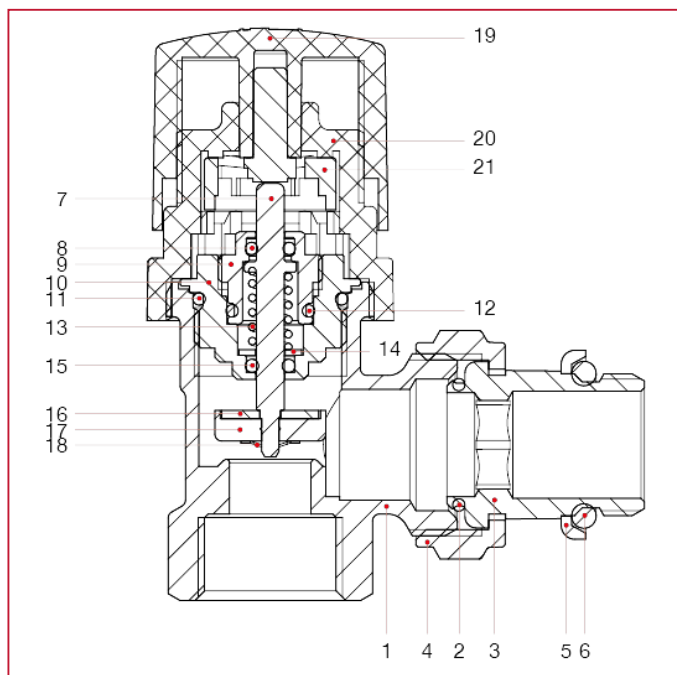

POS.	DESCRIPTION	N.	MATERIAL
1	Body	1	Nickel-plated brass CW617N
2	Washer	1	NBR
3	Union	1	Nickel-plated brass CW617N
4	Nut	1	Nickel-plated brass CW617N
5	Ring	1	Zinc-plated steel Fe
6	Washer	1	NBR
7	Stem	1	Brass CW614N
8	Washer	1	EPDM
9	Ring nut	1	Brass CW614N
10	Body	1	Brass CW614N
11	O-ring	1	EPDM
12	O-ring	1	EPDM
13	Spring	1	Stainless steel AISI 302
14	Washer	1	Stainless steel AISI 304
15	O-ring	1	EPDM
16	Washer	1	Stainless steel AISI 304
17	Washer	1	EPDM
18	Seeger	1	Stainless steel AISI 304
19	Cap	1	ABS
20	Body	1	ABS
21	Hook	1	Polycarbonate



CONVERTIBLE VALVES AND LOCKSHIELDS

INSTRUCTIONS

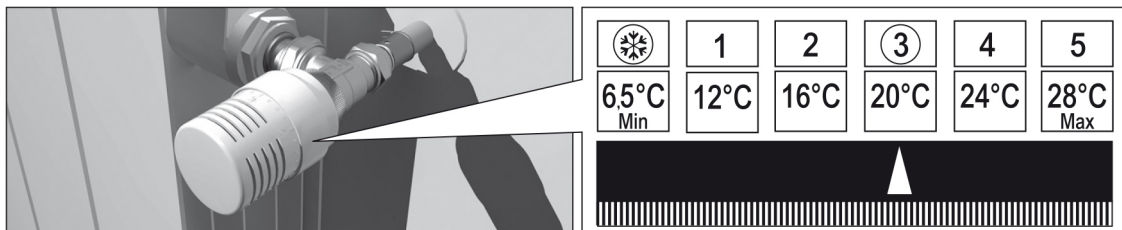

Set the head in the required position:

Use a screwdriver to disassemble the cover (b), the locking cap (c) and the first of the toothed washer (d) FIG. II.

Reassemble the washer (d) as in FIG. III if you want to limit the setting from * to 3.

Reassemble the washer (d) as in FIG IV if you want to block the setting at the value of 3.

Then reassemble the locking cap (c) and the cover (b).

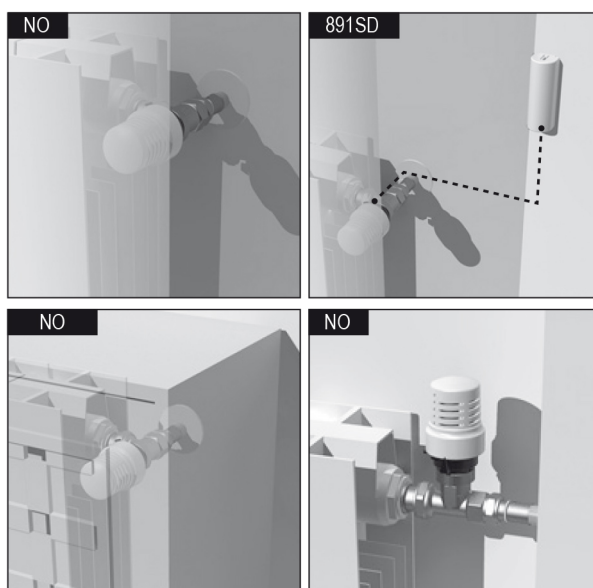
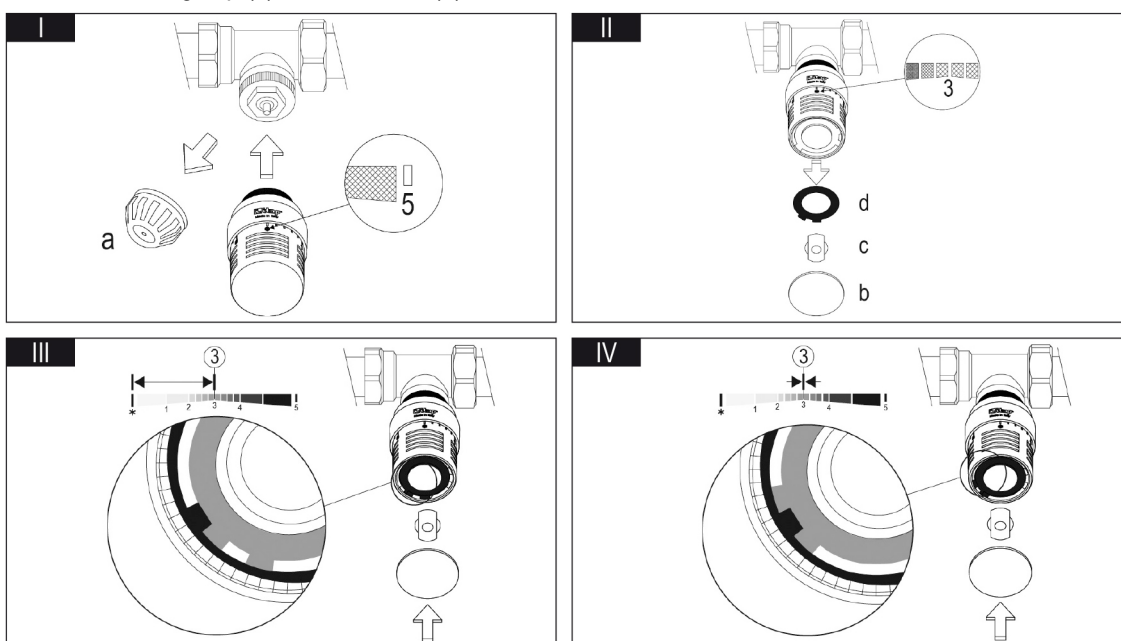



CONVERTIBLE VALVES AND LOCKSHIELDS

994C - 995C - 994V - 995V IN COMBINATION WITH 891 SERIES ACTUATOR:

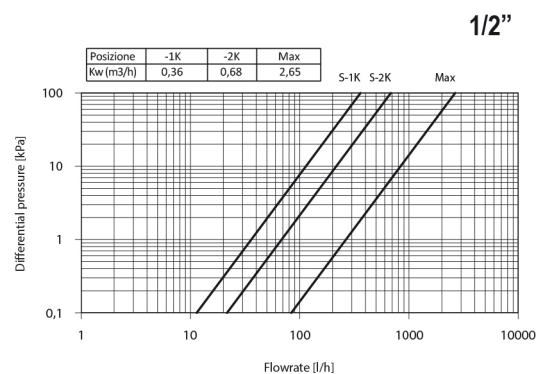
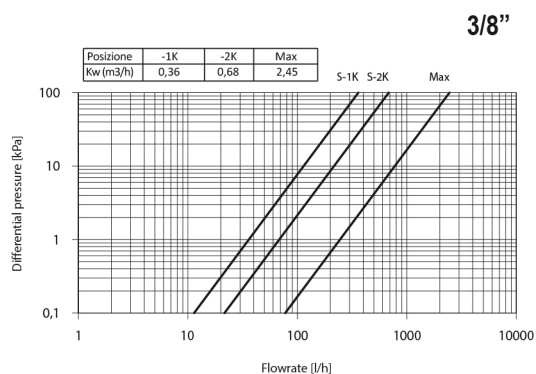

894C - 895C - 894V - 895V IN COMBINATION WITH 891 SERIES ACTUATOR:

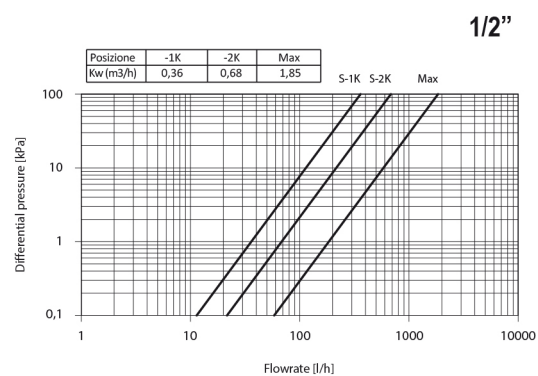
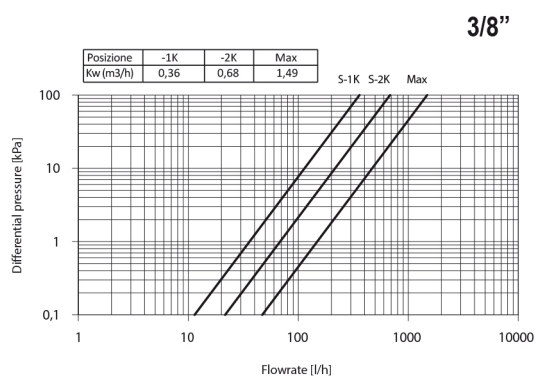

P max. 10 bar	ΔP max. 1,5 bar	T max. 110°C	Isteresi / Hysteresis C: 0,5 K	Tempo di risposta / Response time Z: 30 min.
Portata nominale / Nominal Flowrate qmN: 210 l/h				
Influenza pressione differenziale / Differential pressure influence D: 0,75 K				



CONVERTIBLE VALVES AND LOCKSHIELDS

LOSS DIAGRAM (With water) size 3/8"

KV	3/8"	1/2"
	1K:0,34;2K:0,63;MAX:2,25	1K:0,34;2K:0,63;MAX:2,28

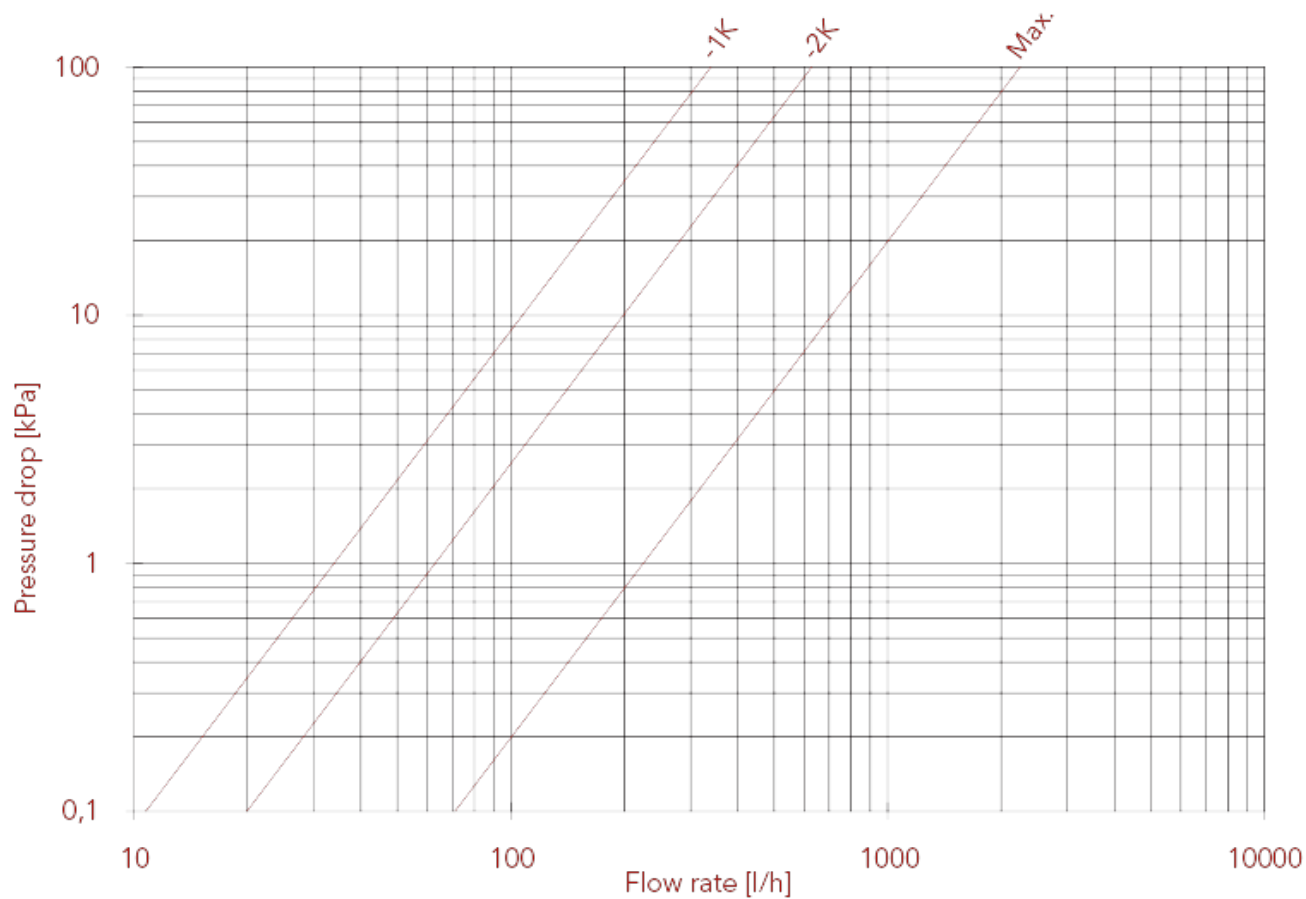



CONVERTIBLE VALVES AND LOCKSHIELDS

LOSS DIAGRAM (With water) size 1/2"

KV	3/8"	1/2"
	1K:0,34;2K:0,63;MAX:2,25	1K:0,34;2K:0,63;MAX:2,28

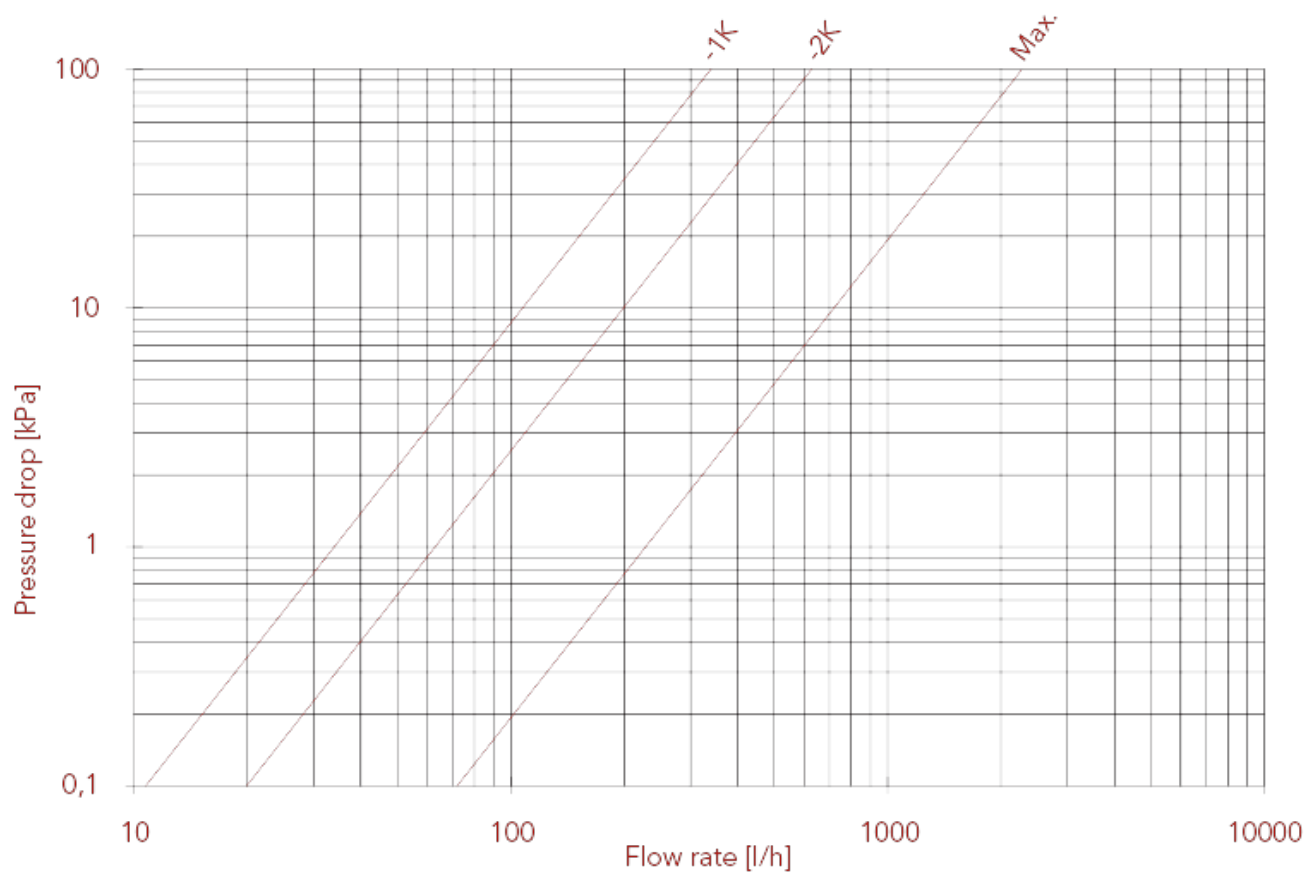



CONVERTIBLE VALVES AND LOCKSHIELDS

994C Angle convertible valve with cap, female thread

To be used with iron piping or, together with an Itap-Fit® connector (art. 618), with copper, crosslinked polyethylene (PEX) or polybutylene.

In the case of use with PEX or polybutylene it is also requested the use of the liner art. 655.



MEASURE	PRESSURE	CODE	PACKING
3/8" (DN 10)	10bar/145psi	9940038C	4/88
1/2" (DN 15)	10bar/145psi	9940012C	4/88

CERTIFICATIONS



TECHNICAL SPECIFICATIONS

Body in nickel-plated brass.

Maximum working temperature: 110°C.

Threads: ISO 228 (equivalent to DIN EN ISO 228 and BS EN ISO 228).

Suitable for thermostatic control heads art. 891, art. 891R, art. 891SD.

OVERALL DIMENSIONS

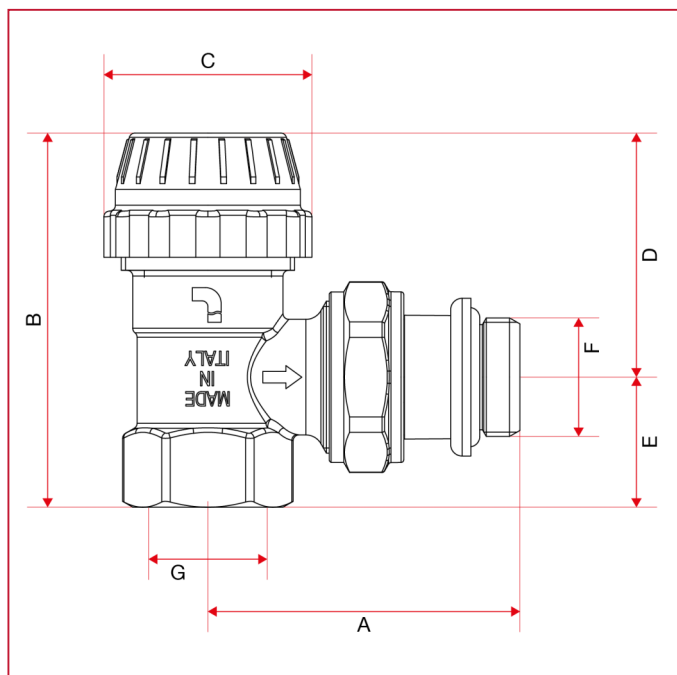



CONVERTIBLE VALVES AND LOCKSHIELDS

	3/8"	1/2"
DN	10	15
A	50	53,5
B	62,7	64,7
C	36	36
D	42,2	42,2
E	20,5	22,5
F	3/8"	1/2"
G	3/8"	1/2"
Kg/cm ² bar	10	10
LBS - psi	145	145



CONVERTIBLE VALVES AND LOCKSHIELDS

MATERIALS

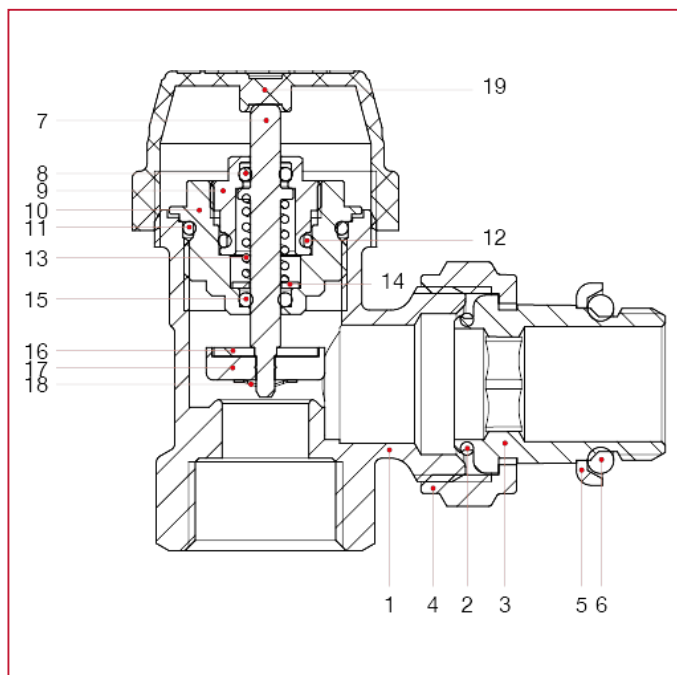

POS.	DESCRIPTION	N.	MATERIAL
1	Body	1	Nickel-plated brass CW617N
2	Washer	1	NBR
3	Union	1	Nickel-plated brass CW617N
4	Nut	1	Nickel-plated brass CW617N
5	Ring	1	Zinc-plated steel Fe
6	Washer	1	NBR
7	Stem	1	Brass CW614N
8	Washer	1	EPDM
9	Ring nut	1	Brass CW614N
10	Body	1	Brass CW614N
11	O-ring	1	EPDM
12	O-ring	1	EPDM
13	Spring	1	Stainless steel AISI 302
14	Washer	1	Stainless steel AISI 304
15	O-ring	1	EPDM
16	Washer	1	Stainless steel AISI 304
17	Washer	1	EPDM
18	Seeger	1	Stainless steel AISI 304
19	Cap	1	ABS



CONVERTIBLE VALVES AND LOCKSHIELDS

INSTRUCTIONS

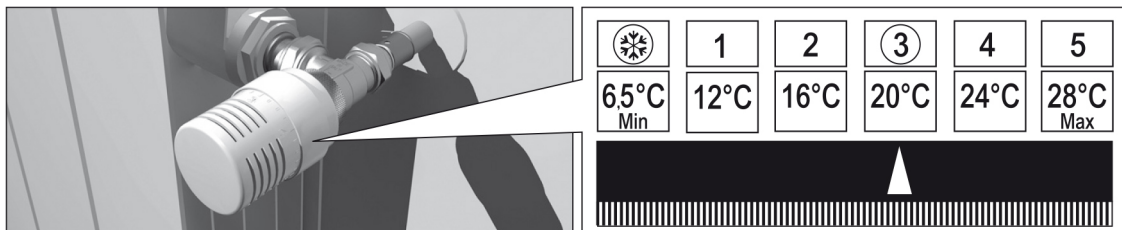

Set the head in the required position:

Use a screwdriver to disassemble the cover (b), the locking cap (c) and the first of the toothed washer (d) FIG. II.

Reassemble the washer (d) as in FIG. III if you want to limit the setting from * to 3.

Reassemble the washer (d) as in FIG IV if you want to block the setting at the value of 3.

Then reassemble the locking cap (c) and the cover (b).

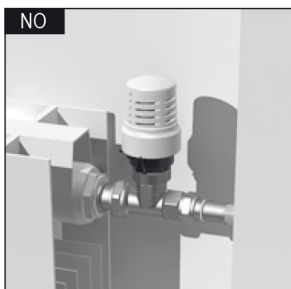
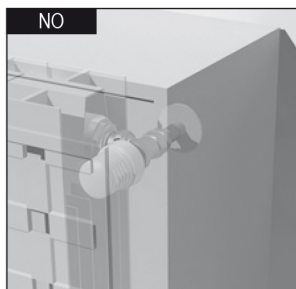
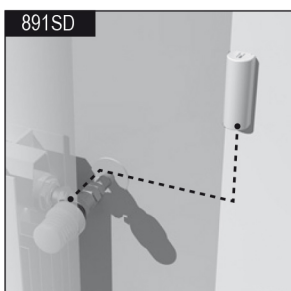
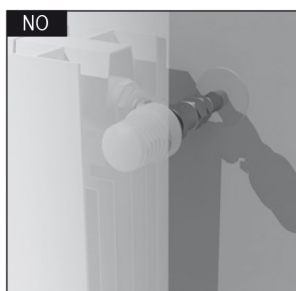
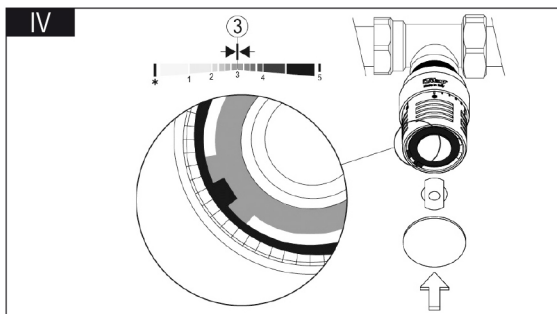
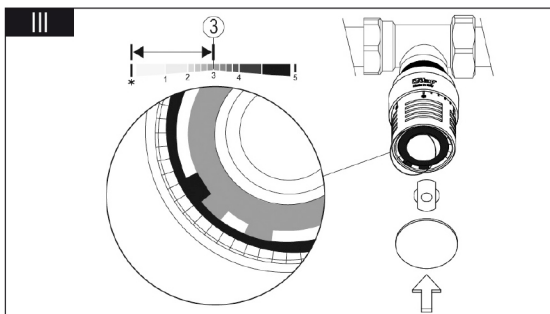
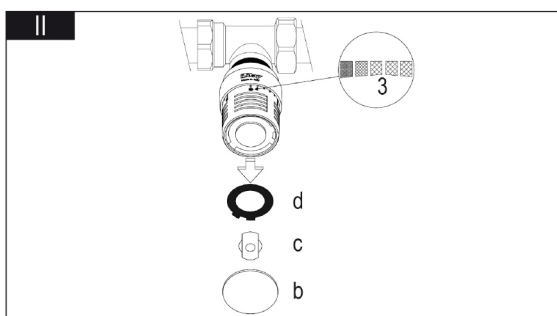
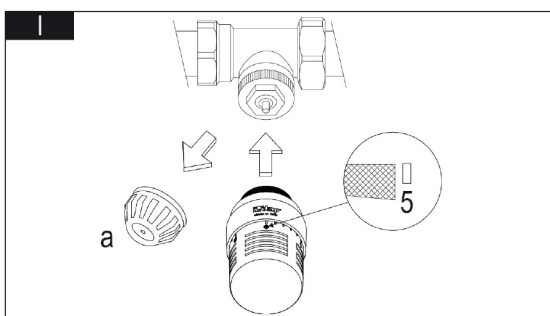



CONVERTIBLE VALVES AND LOCKSHIELDS

994C - 995C - 994V - 995V IN COMBINATION WITH 891 SERIES ACTUATOR:

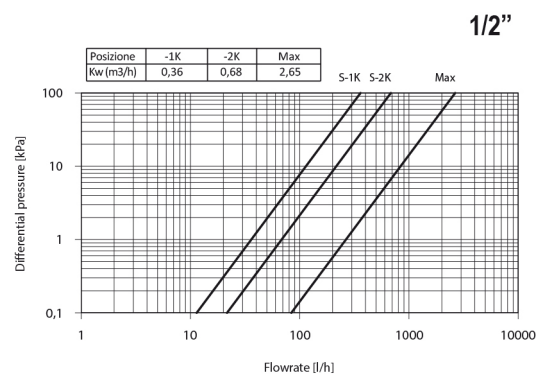
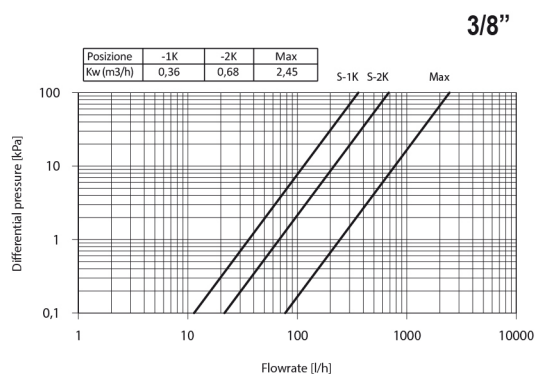

894C - 895C - 894V - 895V IN COMBINATION WITH 891 SERIES ACTUATOR:

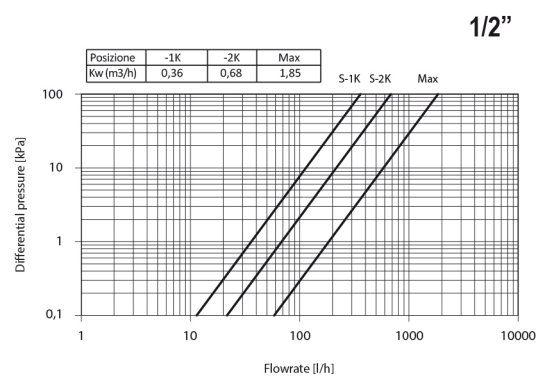
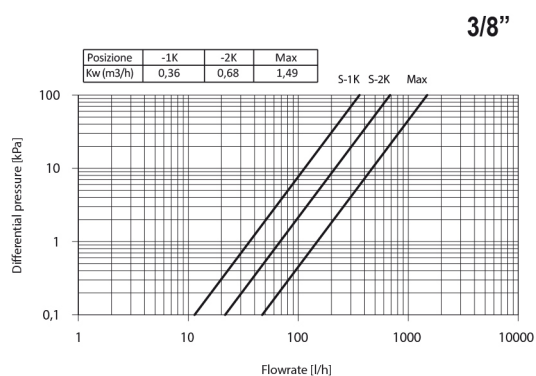

P max. 10 bar	ΔP max. 1,5 bar	T max. 110°C	Isteresi / Hysteresis C: 0,5 K	Tempo di risposta / Response time Z: 30 min.
Portata nominale / Nominal Flowrate qmN: 210 l/h				
Influenza pressione differenziale / Differential pressure influence D: 0,75 K				



CONVERTIBLE VALVES AND LOCKSHIELDS

LOSS DIAGRAM (With water) size 3/8"

KV	3/8"	1/2"
	1K:0,34;2K:0,63;MAX:2,25	1K:0,34;2K:0,63;MAX:2,28

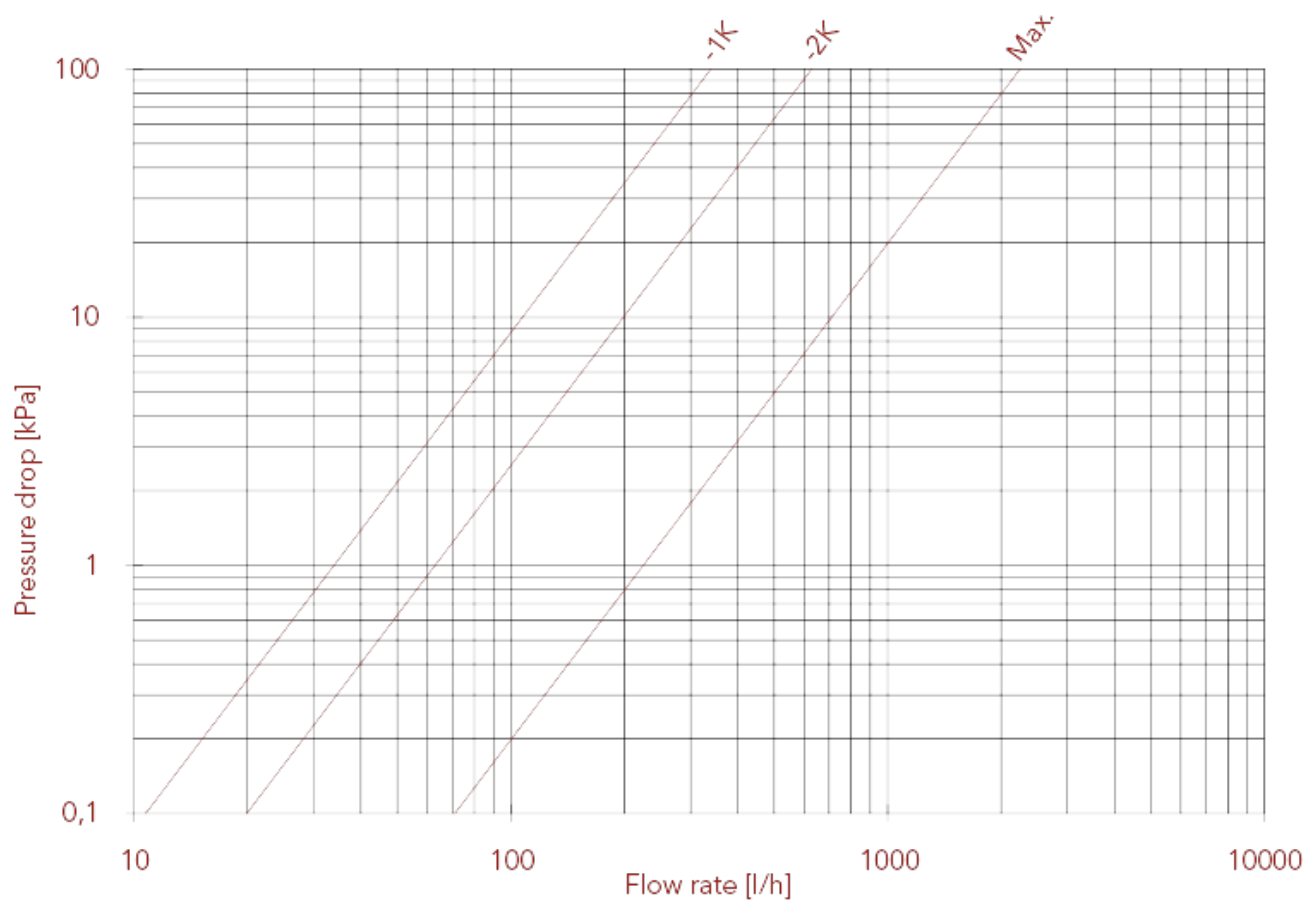



CONVERTIBLE VALVES AND LOCKSHIELDS

LOSS DIAGRAM (With water) size 1/2"

KV	3/8"	1/2"
	1K:0,34;2K:0,63;MAX:2,25	1K:0,34;2K:0,63;MAX:2,28

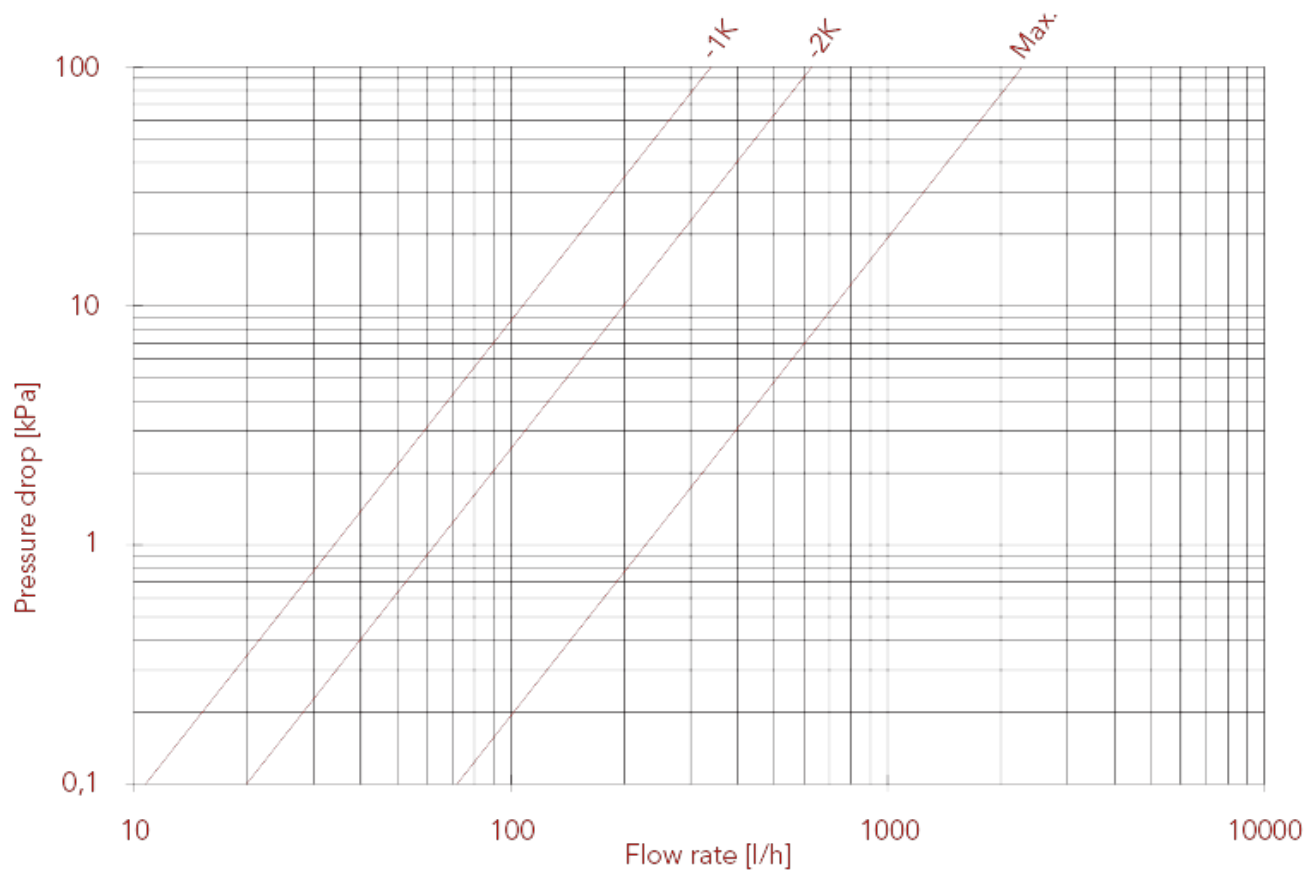



CONVERTIBLE VALVES AND LOCKSHIELDS

396S Angle lockshield, female thread

To be used with iron piping or, together with an Itap-Fit® connector (art. 618), with copper, crosslinked polyethylene (PEX) or polybutylene.

In the case of use with PEX or polybutylene it is also requested the use of the liner art. 655.



MEASURE	PRESSURE	CODE	PACKING
3/8" (DN 10)	10bar/145psi	3960038S	12/168
1/2" (DN 15)	10bar/145psi	3960012S	12/144
3/4" (DN 20)	10bar/145psi	3960034S	10/80

CERTIFICATIONS



TECHNICAL SPECIFICATIONS

Body in nickel-plated brass.

Maximum working temperature: 110°C.

Threads: ISO 228 (equivalent to DIN EN ISO 228 and BS EN ISO 228).

OVERALL DIMENSIONS

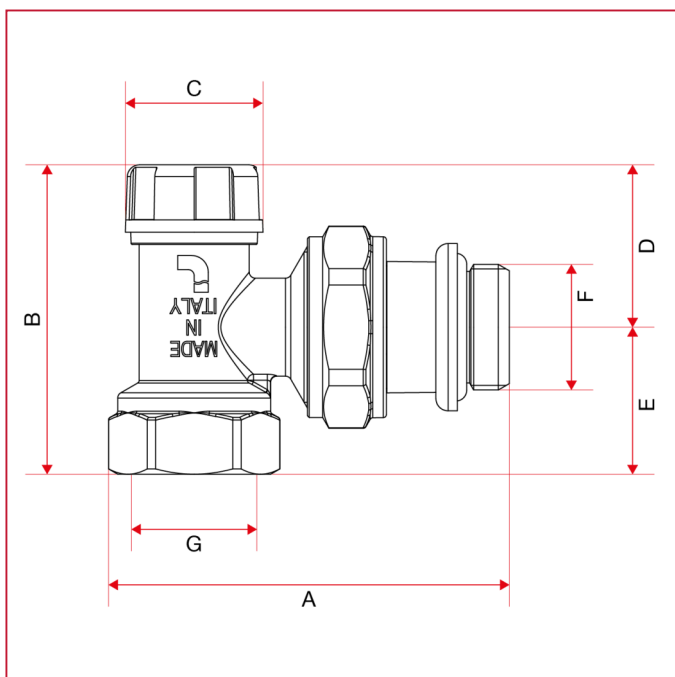



CONVERTIBLE VALVES AND LOCKSHIELDS

	3/8"	1/2"	3/4"
DN	10	15	20
A	50	51,5	58
B	48	50,5	53,7
C	22,5	22,5	25
D	26,5	26,5	30,3
E	21,5	24	23,4
F	3/8"	1/2"	3/4"
G	3/8"	1/2"	3/4"
Kg/cm ² bar	10	10	10
LBS - psi	145	145	145

MATERIALS

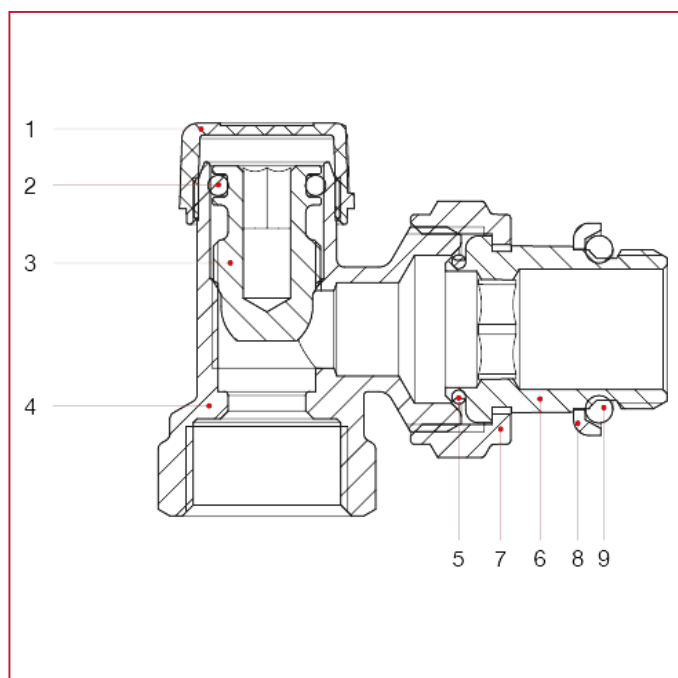

POS.	DESCRIPTION	N.	MATERIAL
1	Cap	1	ABS
2	O-ring	1	EPDM
3	Bonnet	1	Brass CW614N
4	Body	1	Nickel-plated brass CW617N
5	Washer	1	NBR
6	Union	1	Nickel-plated brass CW617N
7	Nut	1	Nickel-plated brass CW617N
8	Ring	1	Zinc-plated steel Fe
9	Washer	1	NBR



CONVERTIBLE VALVES AND LOCKSHIELDS

LOSS DIAGRAM (With water) size 3/8"

KV	3/8"	1/2"	3/4"
	1turn:0,38;2turn:0,60;3turn:0,92; MAX:2,13	1turn:0,42;2turn:0,70;3turn:1,10; MAX:2,51	1turn:0,60;2turn:1,02;3turn:1,54; MAX:2,94

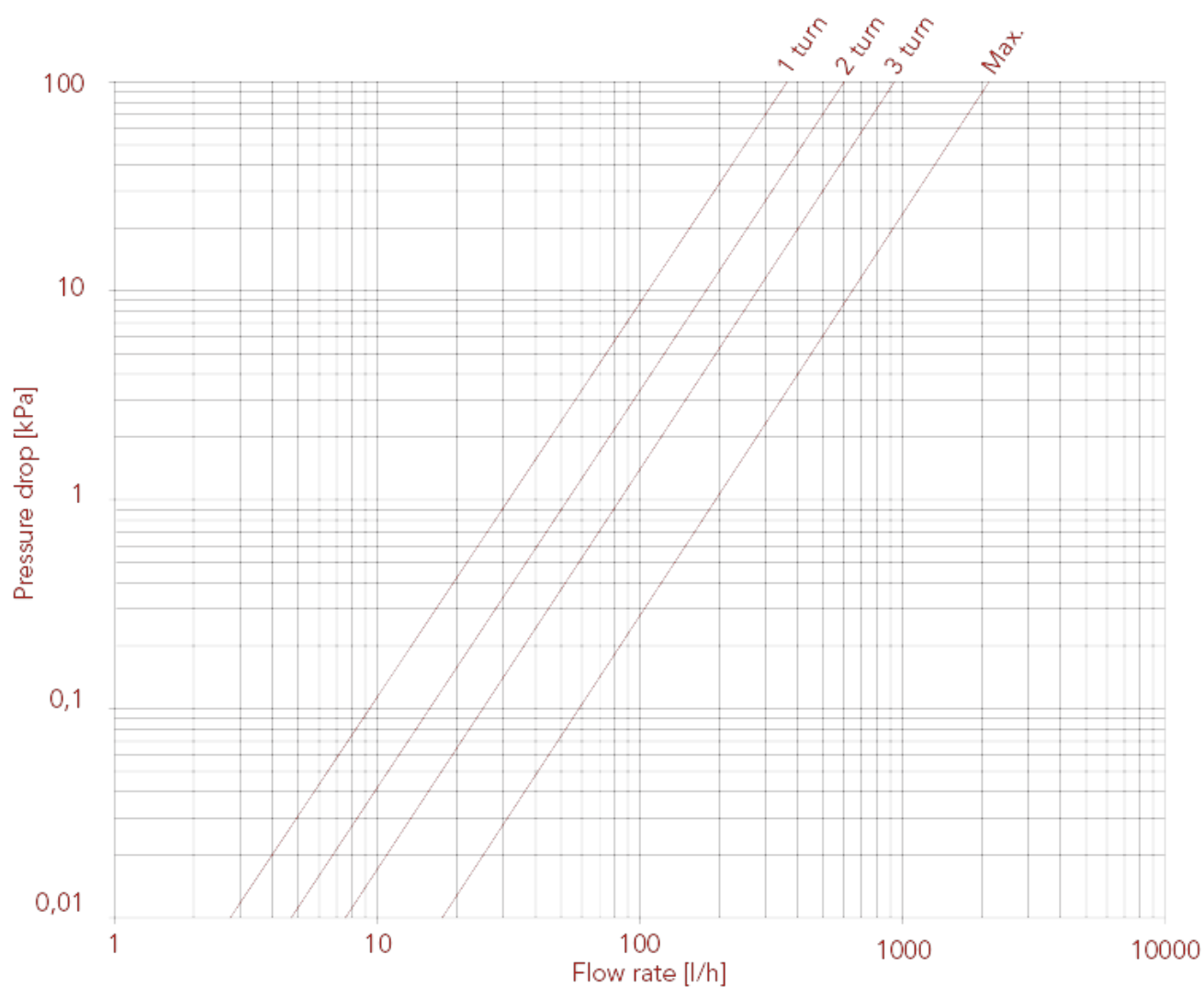



CONVERTIBLE VALVES AND LOCKSHIELDS

LOSS DIAGRAM (With water) size 1/2"

KV	3/8"	1/2"	3/4"
	1turn:0,38;2turn:0,60;3turn:0,92; MAX:2,13	1turn:0,42;2turn:0,70;3turn:1,10; MAX:2,51	1turn:0,60;2turn:1,02;3turn:1,54; MAX:2,94

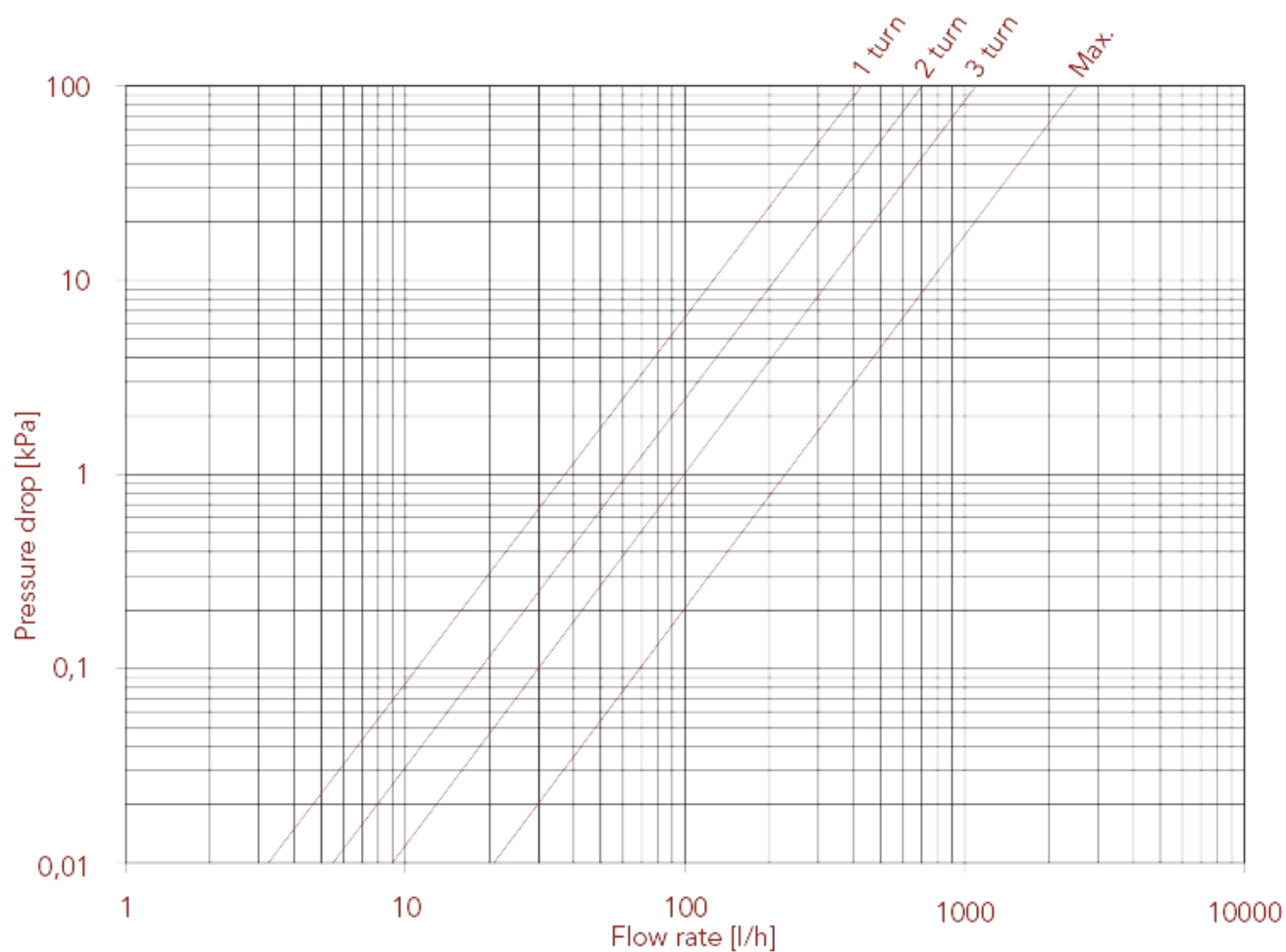



CONVERTIBLE VALVES AND LOCKSHIELDS

LOSS DIAGRAM (With water) size 3/4"

KV	3/8"	1/2"	3/4"
	1turn:0,38;2turn:0,60;3turn:0,92; MAX:2,13	1turn:0,42;2turn:0,70;3turn:1,10; MAX:2,51	1turn:0,60;2turn:1,02;3turn:1,54; MAX:2,94

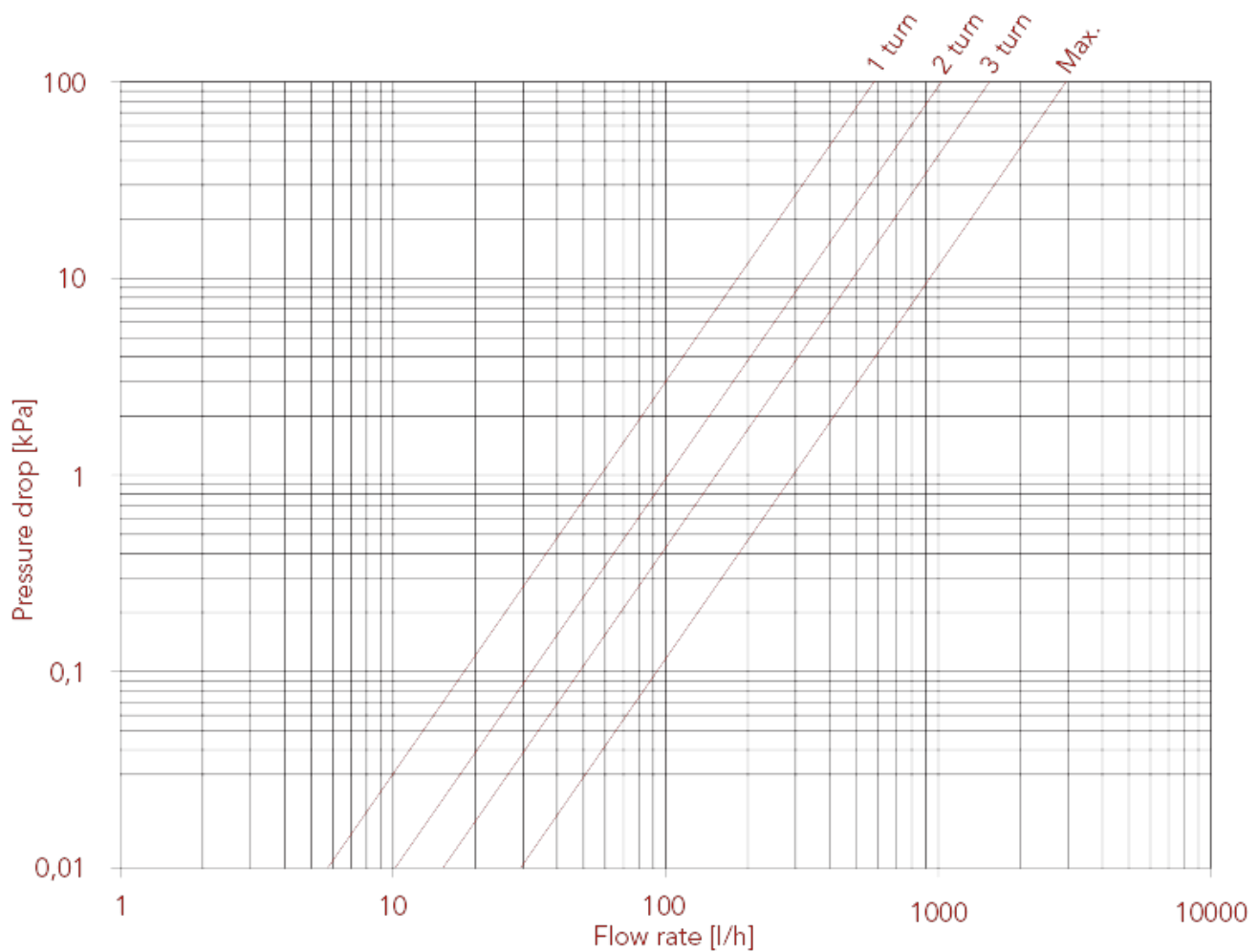



CONVERTIBLE VALVES AND LOCKSHIELDS

995V Angle convertible valve with handle, male thread

To be used with multilayer, PEX or polybutylene piping, together with 595M or 510 Multi-Fit® connectors.

Suitable also for copper piping, together with a compression fitting art. 595.

The male thread "G" is equipped with a conical seat and inner diameter mm.16.



MEASURE	PRESSURE	CODE	PACKING
3/8" (DN 10)	10bar/145psi	9950038V	4/56
1/2" (DN 15)	10bar/145psi	9950012V	4/56

CERTIFICATIONS



TECHNICAL SPECIFICATIONS

Body in nickel-plated brass.

Maximum working temperature: 110°C.

Threads: ISO 228 (equivalent to DIN EN ISO 228 and BS EN ISO 228).

Suitable for thermostatic control heads art. 891, art. 891R, art. 891SD.

OVERALL DIMENSIONS

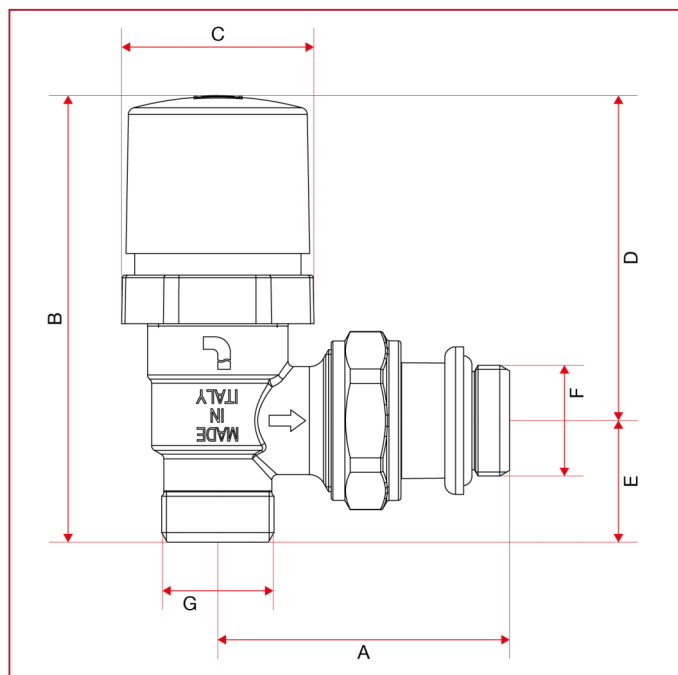



CONVERTIBLE VALVES AND LOCKSHIELDS

	3/8"	1/2"
DN	10	15
A	50	53,5
B	80,7	82,7
C	35,6	35,6
D	60,7	60,7
E	20,5	22,5
F	3/8"	1/2"
G	1/2"	1/2"
Kg/cm ² bar	10	10
LBS - psi	145	145



CONVERTIBLE VALVES AND LOCKSHIELDS

MATERIALS

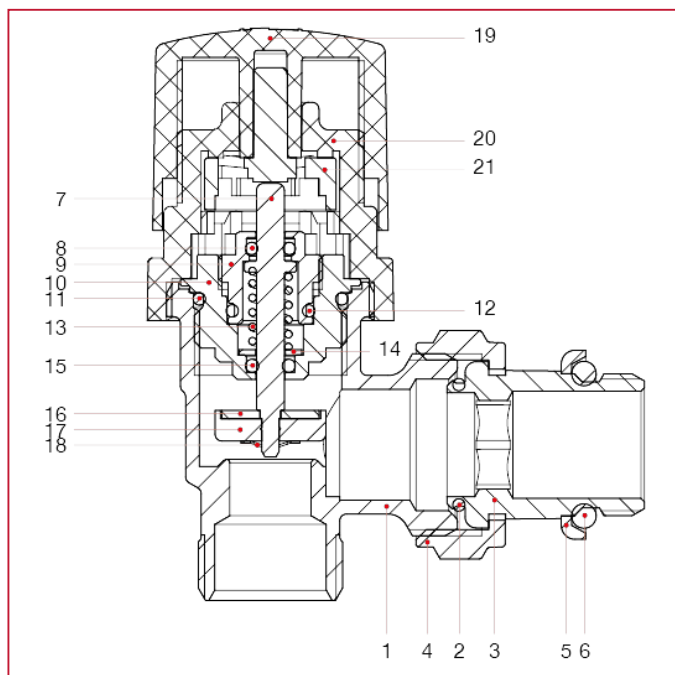

POS.	DESCRIPTION	N.	MATERIAL
1	Body	1	Nickel-plated brass CW617N
2	Washer	1	NBR
3	Union	1	Nickel-plated brass CW617N
4	Nut	1	Nickel-plated brass CW617N
5	Ring	1	Zinc-plated steel Fe
6	Washer	1	NBR
7	Stem	1	Brass CW614N
8	Washer	1	EPDM
9	Ring nut	1	Brass CW614N
10	Body	1	Brass CW614N
11	O-ring	1	EPDM
12	O-ring	1	EPDM
13	Spring	1	Stainless steel AISI 302
14	Washer	1	Stainless steel AISI 304
15	O-ring	1	EPDM
16	Washer	1	Stainless steel AISI 304
17	Washer	1	EPDM
18	Seeger	1	Stainless steel AISI 304
19	Cap	1	ABS
20	Body	1	ABS
21	Hook	1	Polycarbonate



CONVERTIBLE VALVES AND LOCKSHIELDS

INSTRUCTIONS

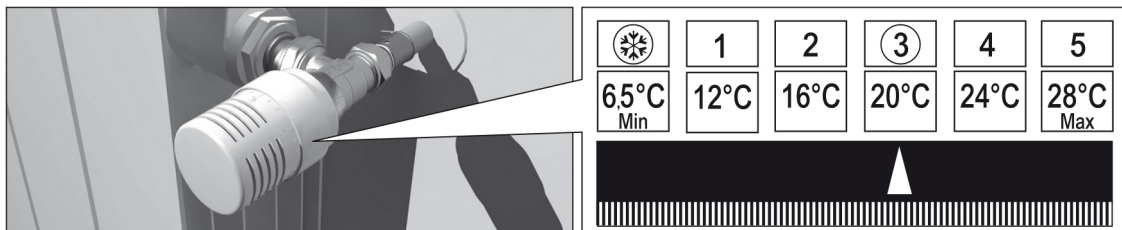

Set the head in the required position:

Use a screwdriver to disassemble the cover (b), the locking cap (c) and the first of the toothed washer (d) FIG. II.

Reassemble the washer (d) as in FIG. III if you want to limit the setting from * to 3.

Reassemble the washer (d) as in FIG IV if you want to block the setting at the value of 3.

Then reassemble the locking cap (c) and the cover (b).

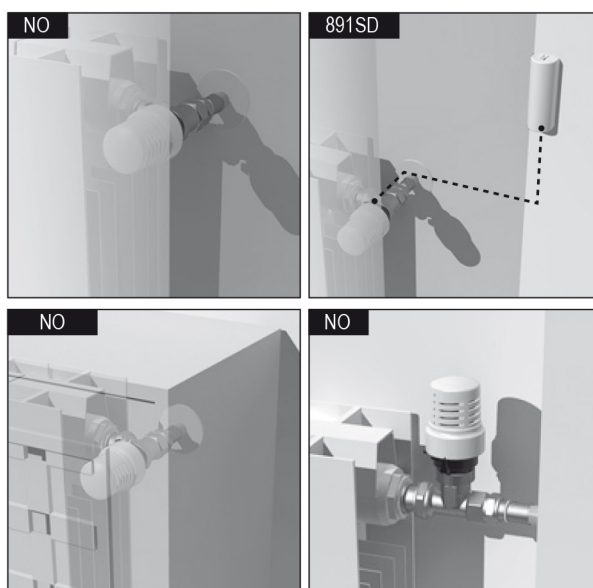
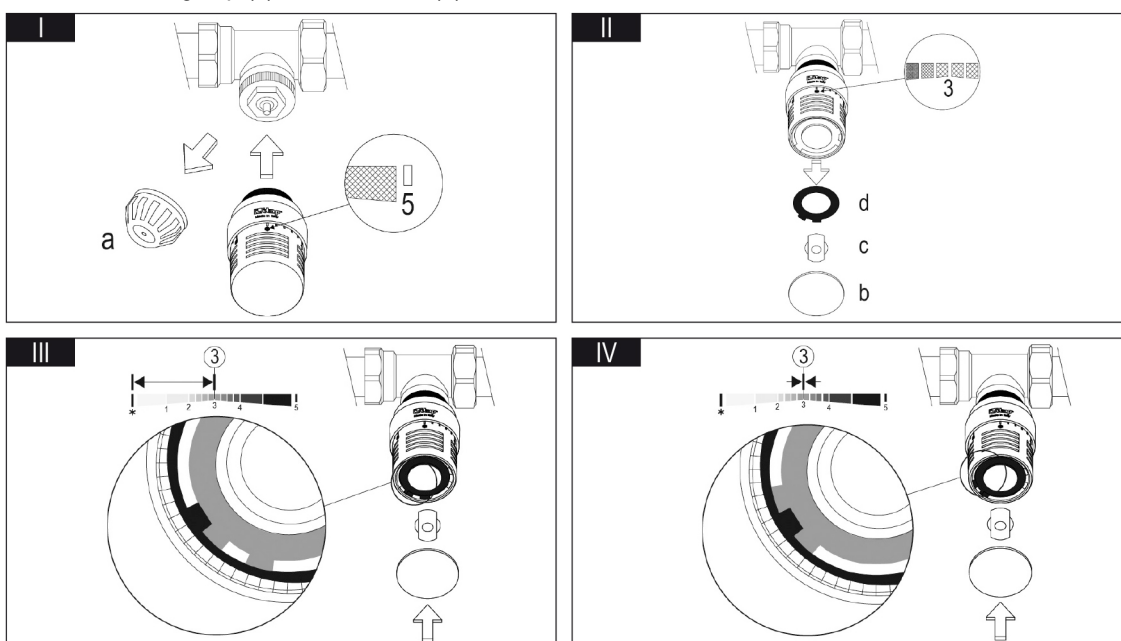



CONVERTIBLE VALVES AND LOCKSHIELDS

994C - 995C - 994V - 995V IN COMBINATION WITH 891 SERIES ACTUATOR:

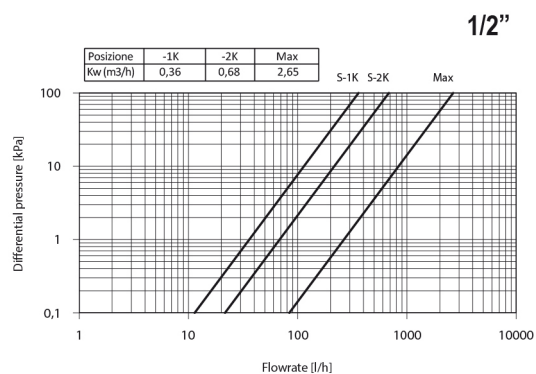
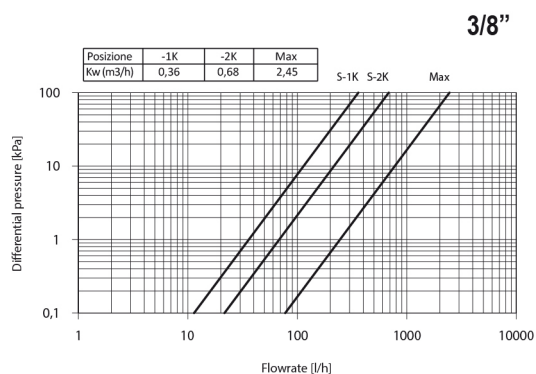

894C - 895C - 894V - 895V IN COMBINATION WITH 891 SERIES ACTUATOR:

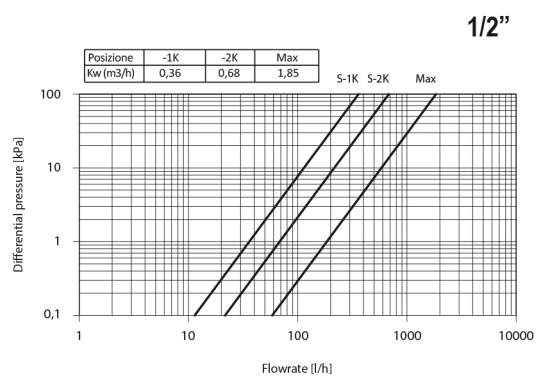
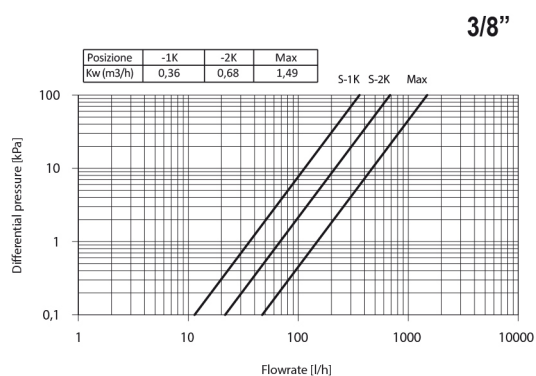

P max. 10 bar	ΔP max. 1,5 bar	T max. 110°C	Isteresi / Hysteresis C: 0,5 K	Tempo di risposta / Response time Z: 30 min.
Portata nominale / Nominal Flowrate qmN: 210 l/h				
Influenza pressione differenziale / Differential pressure influence D: 0,75 K				



CONVERTIBLE VALVES AND LOCKSHIELDS

LOSS DIAGRAM (With water) size 3/8"

KV	3/8"	1/2"
	1K:0,34;2K:0,63;MAX:2,25	1K:0,34;2K:0,63;MAX:2,28

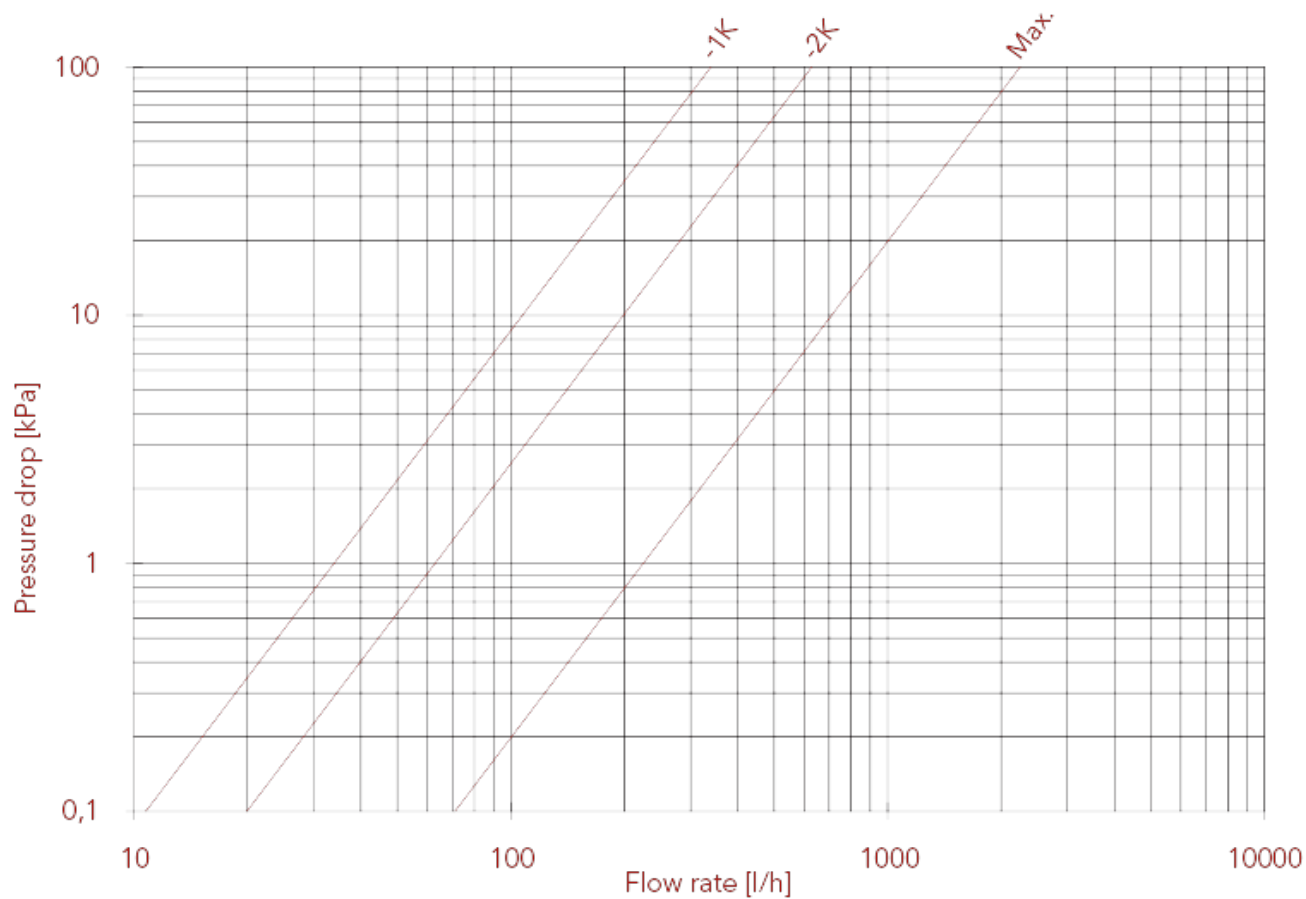



CONVERTIBLE VALVES AND LOCKSHIELDS

LOSS DIAGRAM (With water) size 1/2"

KV	3/8"	1/2"
	1K:0,34;2K:0,63;MAX:2,25	1K:0,34;2K:0,63;MAX:2,28

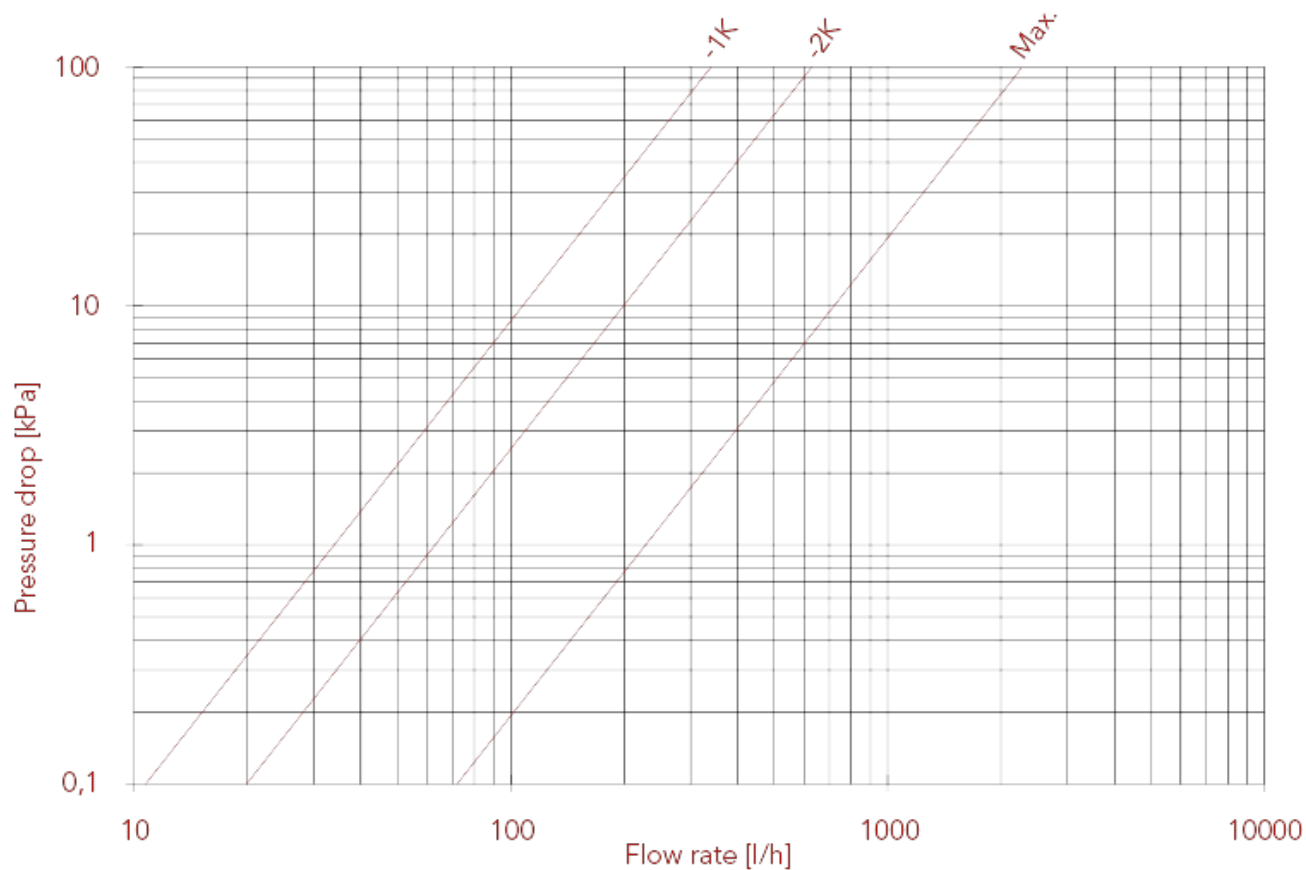



CONVERTIBLE VALVES AND LOCKSHIELDS

995C Angle convertible valve with cap, male thread

To be used with multilayer, PEX or polybutylene piping, together with 595M or 510 Multi-Fit® connectors.

Suitable also for copper piping, together with a compression fitting art. 595.

The male thread "G" is equipped with a conical seat and inner diameter mm.16.



MEASURE	PRESSURE	CODE	PACKING
3/8" (DN 10)	10bar/145psi	9950038C	4/88
1/2" (DN 15)	10bar/145psi	9950012C	4/88

CERTIFICATIONS



TECHNICAL SPECIFICATIONS

Body in nickel-plated brass.

Maximum working temperature: 110°C.

Threads: ISO 228 (equivalent to DIN EN ISO 228 and BS EN ISO 228).

Suitable for thermostatic control heads art. 891, art. 891R, art. 891SD.

OVERALL DIMENSIONS

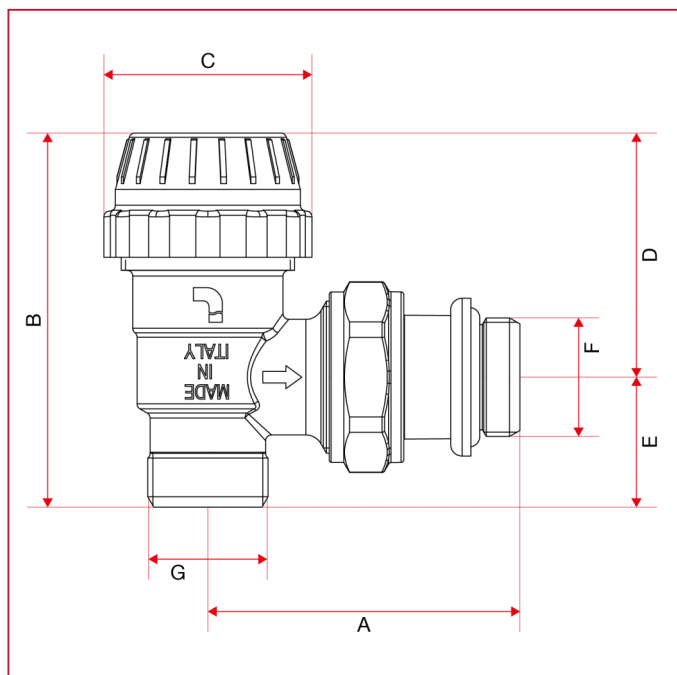



CONVERTIBLE VALVES AND LOCKSHIELDS

	3/8"	1/2"
DN	10	15
A	50	53,5
B	62,7	64,7
C	36	36
D	42,2	42,2
E	20,5	22,5
F	3/8"	1/2"
G	1/2"	1/2"
Kg/cm ² bar	10	10
LBS - psi	145	145



CONVERTIBLE VALVES AND LOCKSHIELDS

MATERIALS

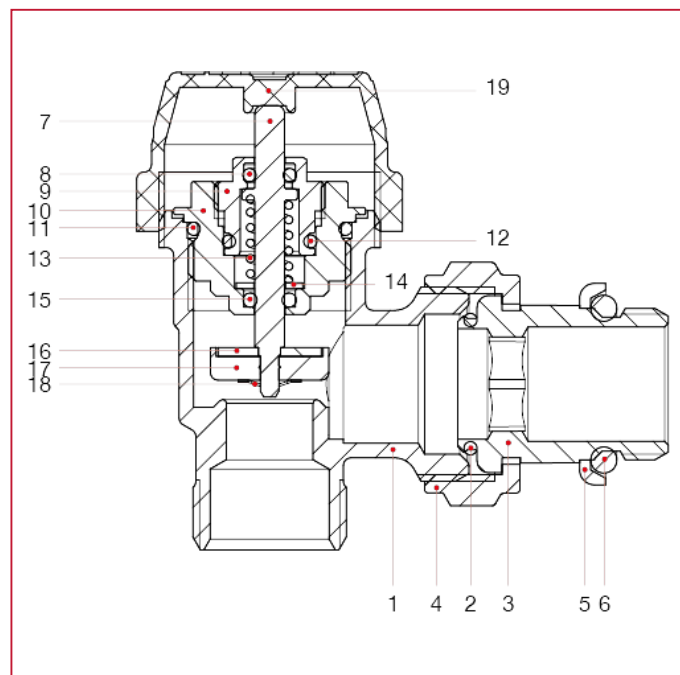

POS.	DESCRIPTION	N.	MATERIAL
1	Body	1	Nickel-plated brass CW617N
2	Washer	1	NBR
3	Union	1	Nickel-plated brass CW617N
4	Nut	1	Nickel-plated brass CW617N
5	Ring	1	Zinc-plated steel Fe
6	Washer	1	NBR
7	Stem	1	Brass CW614N
8	Washer	1	EPDM
9	Ring nut	1	Brass CW614N
10	Body	1	Brass CW614N
11	O-ring	1	EPDM
12	O-ring	1	EPDM
13	Spring	1	Stainless steel AISI 302
14	Washer	1	Stainless steel AISI 304
15	O-ring	1	EPDM
16	Washer	1	Stainless steel AISI 304
17	Washer	1	EPDM
18	Seeger	1	Stainless steel AISI 304
19	Cap	1	ABS



CONVERTIBLE VALVES AND LOCKSHIELDS

INSTRUCTIONS

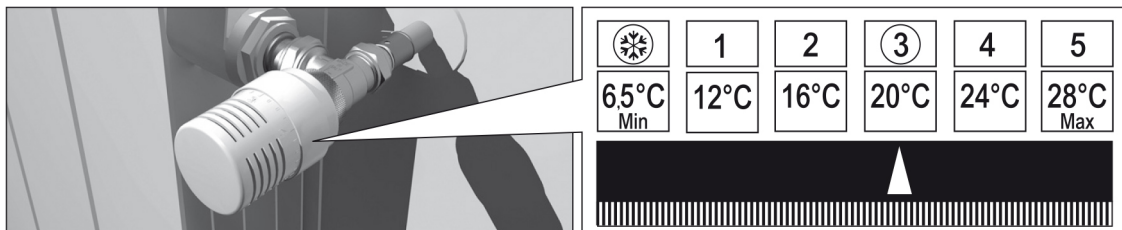

Set the head in the required position:

Use a screwdriver to disassemble the cover (b), the locking cap (c) and the first of the toothed washer (d) FIG. II.

Reassemble the washer (d) as in FIG. III if you want to limit the setting from * to 3.

Reassemble the washer (d) as in FIG IV if you want to block the setting at the value of 3.

Then reassemble the locking cap (c) and the cover (b).

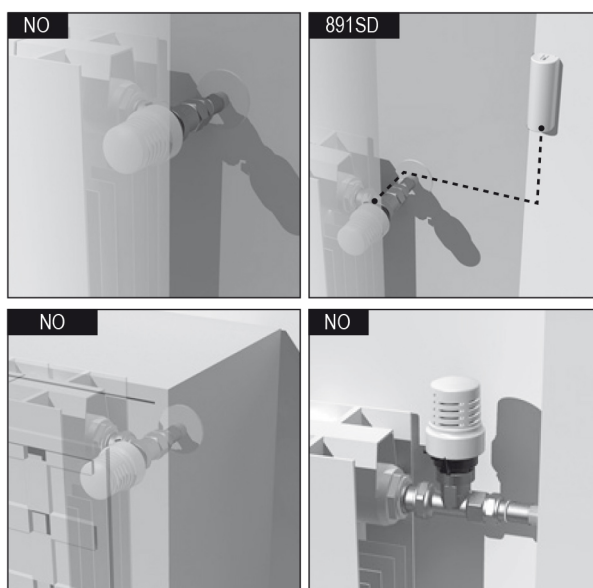
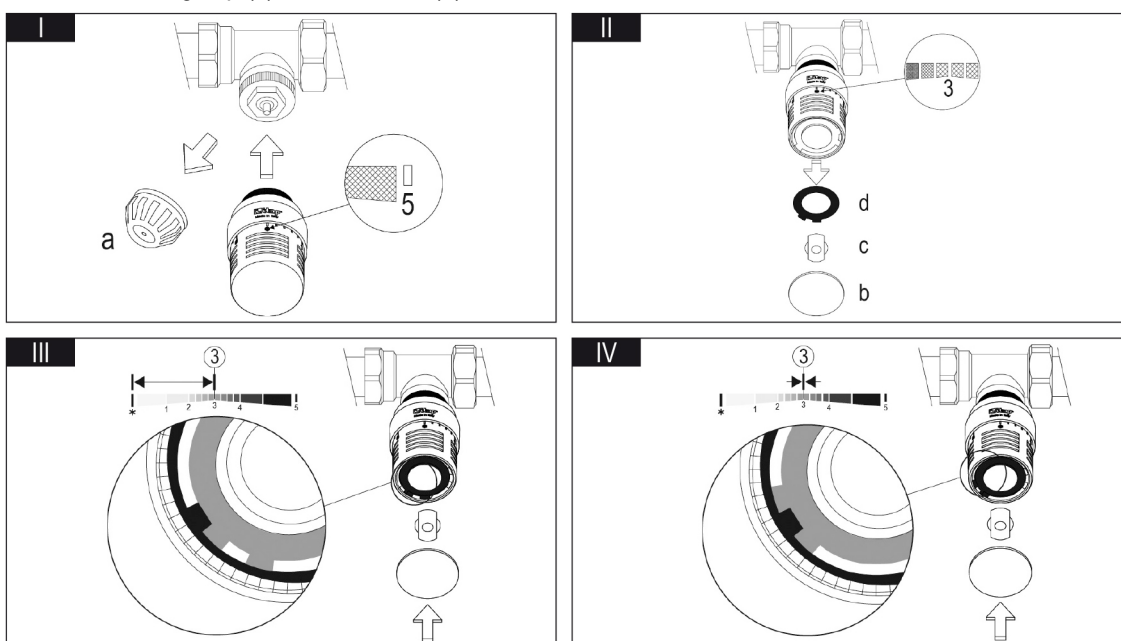



CONVERTIBLE VALVES AND LOCKSHIELDS

994C - 995C - 994V - 995V IN COMBINATION WITH 891 SERIES ACTUATOR:

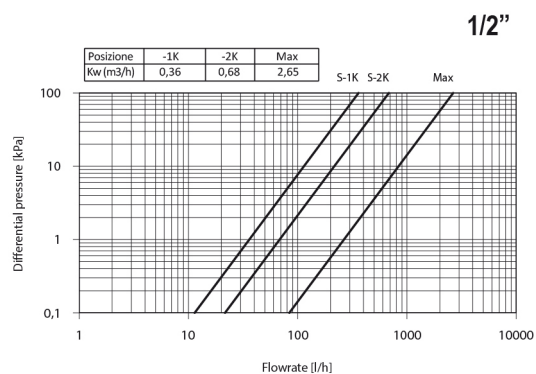
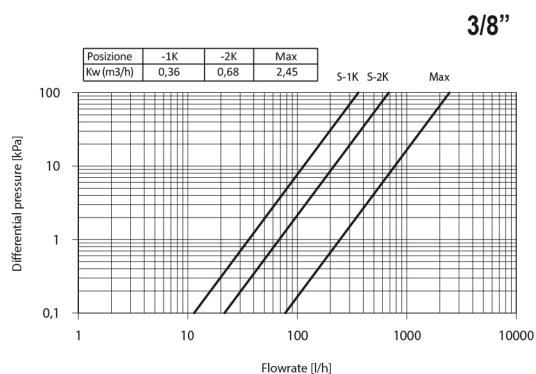

894C - 895C - 894V - 895V IN COMBINATION WITH 891 SERIES ACTUATOR:

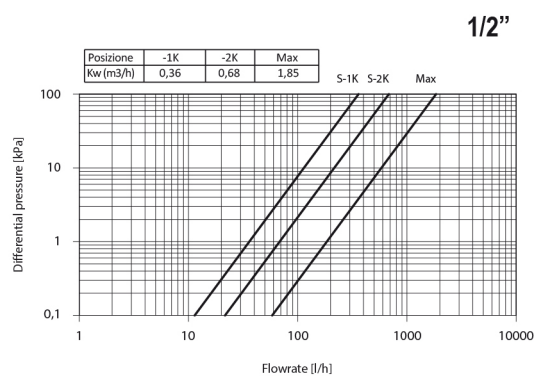
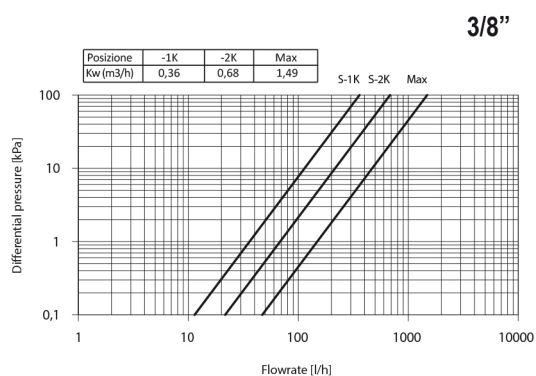

P max. 10 bar	ΔP max. 1,5 bar	T max. 110°C	Isteresi / Hysteresis C: 0,5 K	Tempo di risposta / Response time Z: 30 min.
Portata nominale / Nominal Flowrate qmN: 210 l/h				
Influenza pressione differenziale / Differential pressure influence D: 0,75 K				



CONVERTIBLE VALVES AND LOCKSHIELDS

LOSS DIAGRAM (With water) size 3/8"

KV	3/8"	1/2"
	1K:0,34;2K:0,63;MAX:2,25	1K:0,34;2K:0,63;MAX:2,28

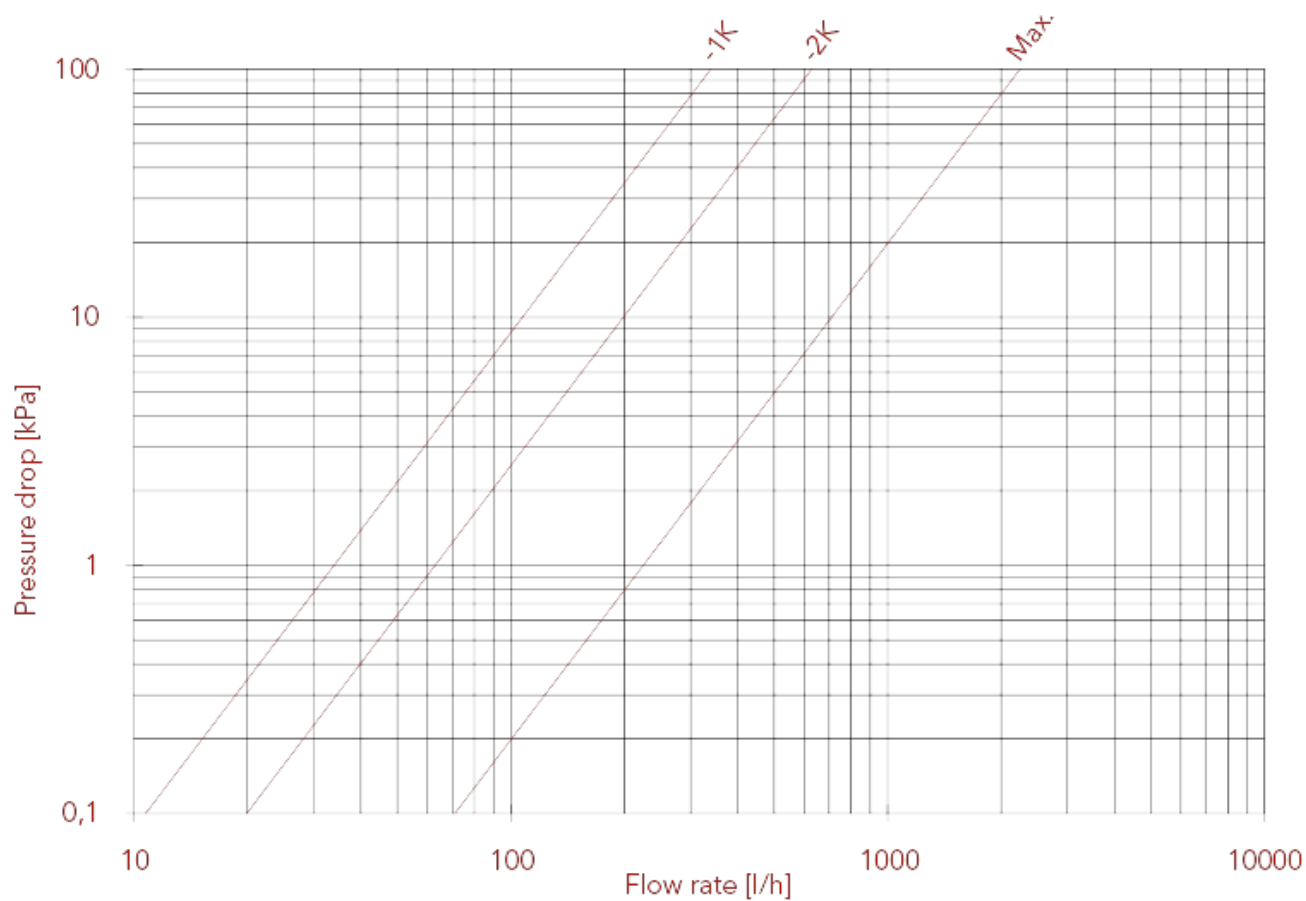



CONVERTIBLE VALVES AND LOCKSHIELDS

LOSS DIAGRAM (With water) size 1/2"

KV	3/8"	1/2"
	1K:0,34;2K:0,63;MAX:2,25	1K:0,34;2K:0,63;MAX:2,28

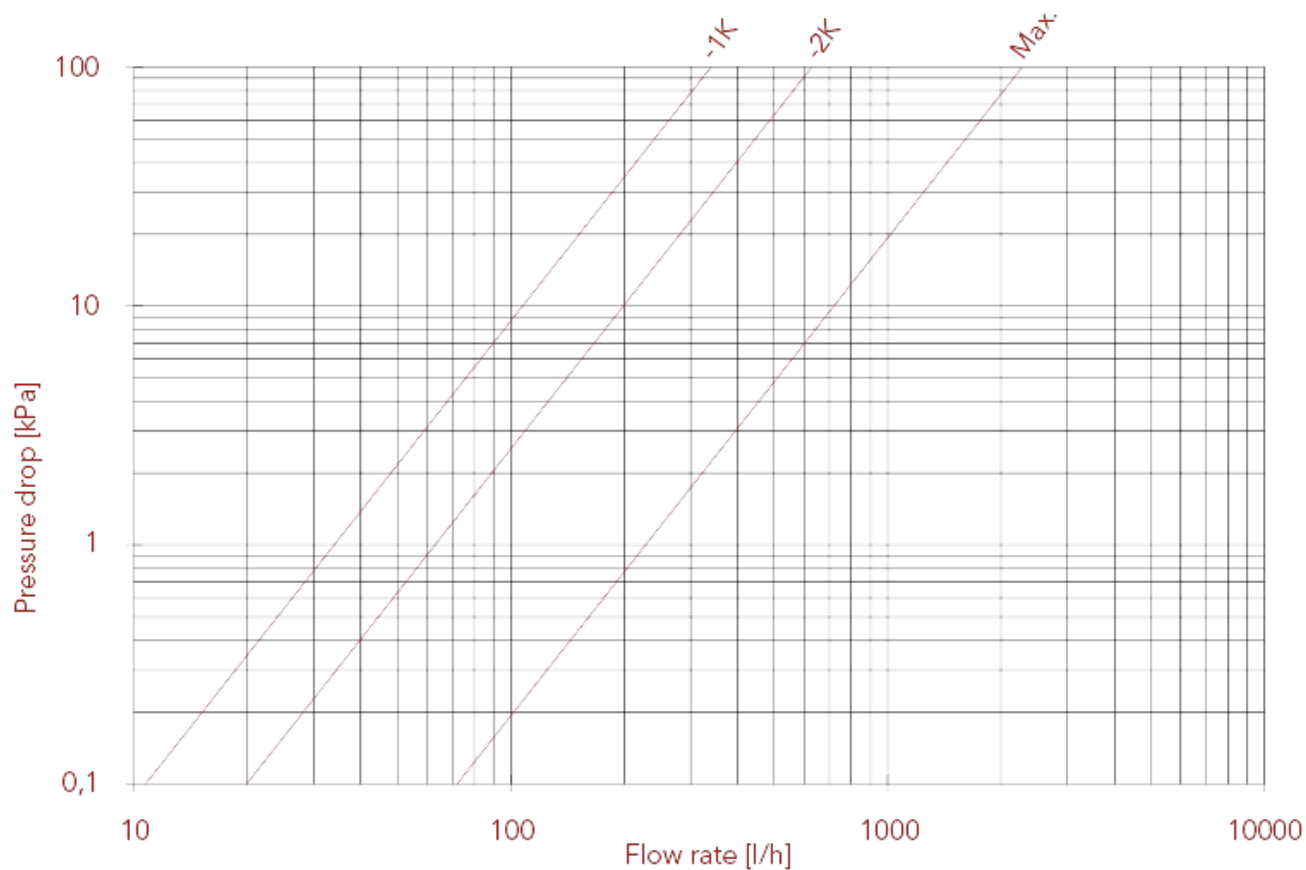



CONVERTIBLE VALVES AND LOCKSHIELDS

397S Angle lockshield, male thread

To be used with multilayer, PEX or polybutylene piping, together with 595M or 510 Multi-Fit® connectors.

Suitable also for copper piping, together with a compression fitting art. 595.

The male thread "G" is equipped with a conical seat and inner diameter mm.16.



MEASURE	PRESSURE	CODE	PACKING
3/8" (DN 10)	10bar/145psi	3970038S	12/168
1/2" (DN 15)	10bar/145psi	3970012S	12/144

CERTIFICATIONS



TECHNICAL SPECIFICATIONS

Body in nickel-plated brass.

Maximum working temperature: 110°C.

Threads: ISO 228 (equivalent to DIN EN ISO 228 and BS EN ISO 228).

OVERALL DIMENSIONS

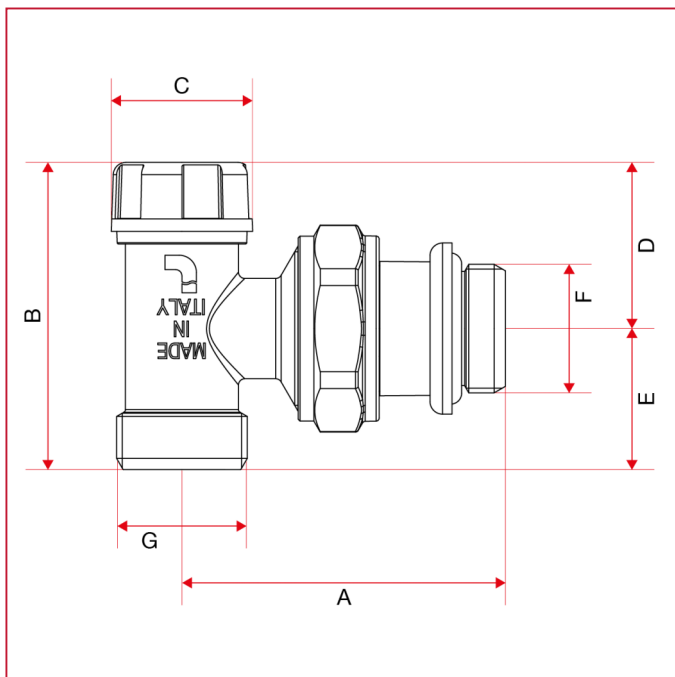



CONVERTIBLE VALVES AND LOCKSHIELDS

	3/8"	1/2"
DN	10	15
A	50	51,5
B	49	49
C	22,5	22,5
D	26,5	26,5
E	22,5	22,5
F	3/8"	1/2"
G	1/2"	1/2"
Kg/cm ² bar	10	10
LBS - psi	145	145

MATERIALS

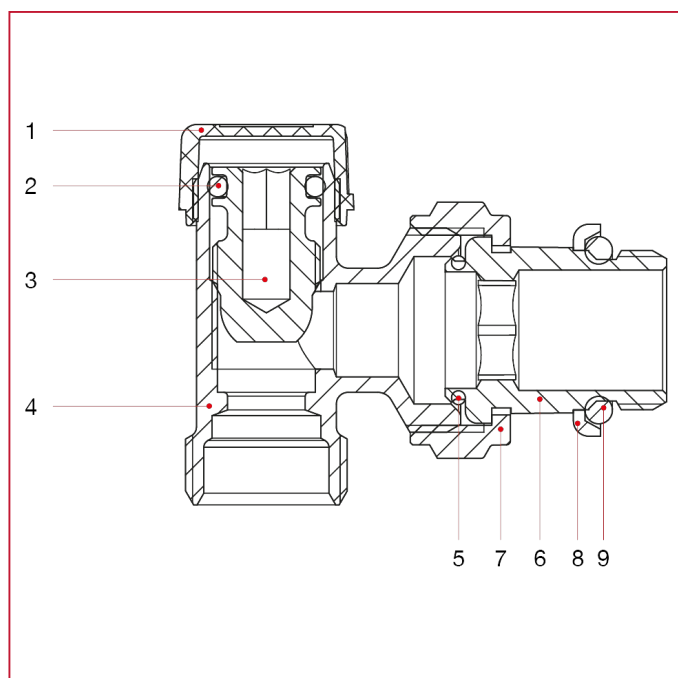

POS.	DESCRIPTION	N.	MATERIAL
1	Cap	1	ABS
2	O-ring	1	EPDM
3	Bonnet	1	Brass CW614N
4	Body	1	Nickel-plated brass CW617N
5	Washer	1	NBR
6	Union	1	Nickel-plated brass CW617N
7	Nut	1	Nickel-plated brass CW617N
8	Ring	1	Zinc-plated steel Fe
9	Washer	1	NBR



CONVERTIBLE VALVES AND LOCKSHIELDS

LOSS DIAGRAM (With water) size 3/8"

KV	3/8"	1/2"
	1turn:0,38;2turn:0,60;3turn:0,92;MAX:2,13	1turn:0,42;2turn:0,70;3turn:1,10;MAX:2,51

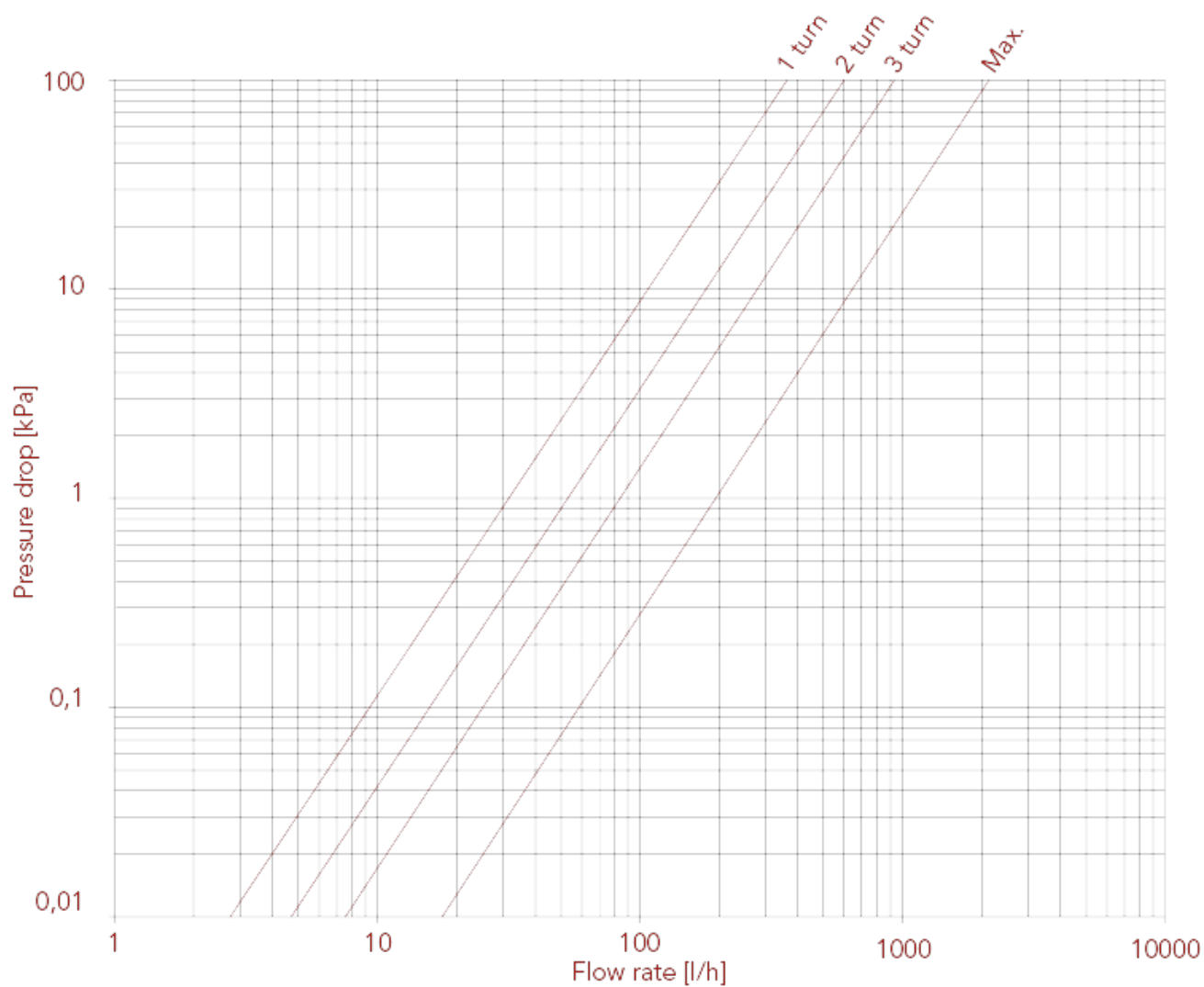



CONVERTIBLE VALVES AND LOCKSHIELDS

LOSS DIAGRAM (With water) size 1/2"

KV	3/8"	1/2"
	1turn:0,38;2turn:0,60;3turn:0,92;MAX:2,13	1turn:0,42;2turn:0,70;3turn:1,10;MAX:2,51

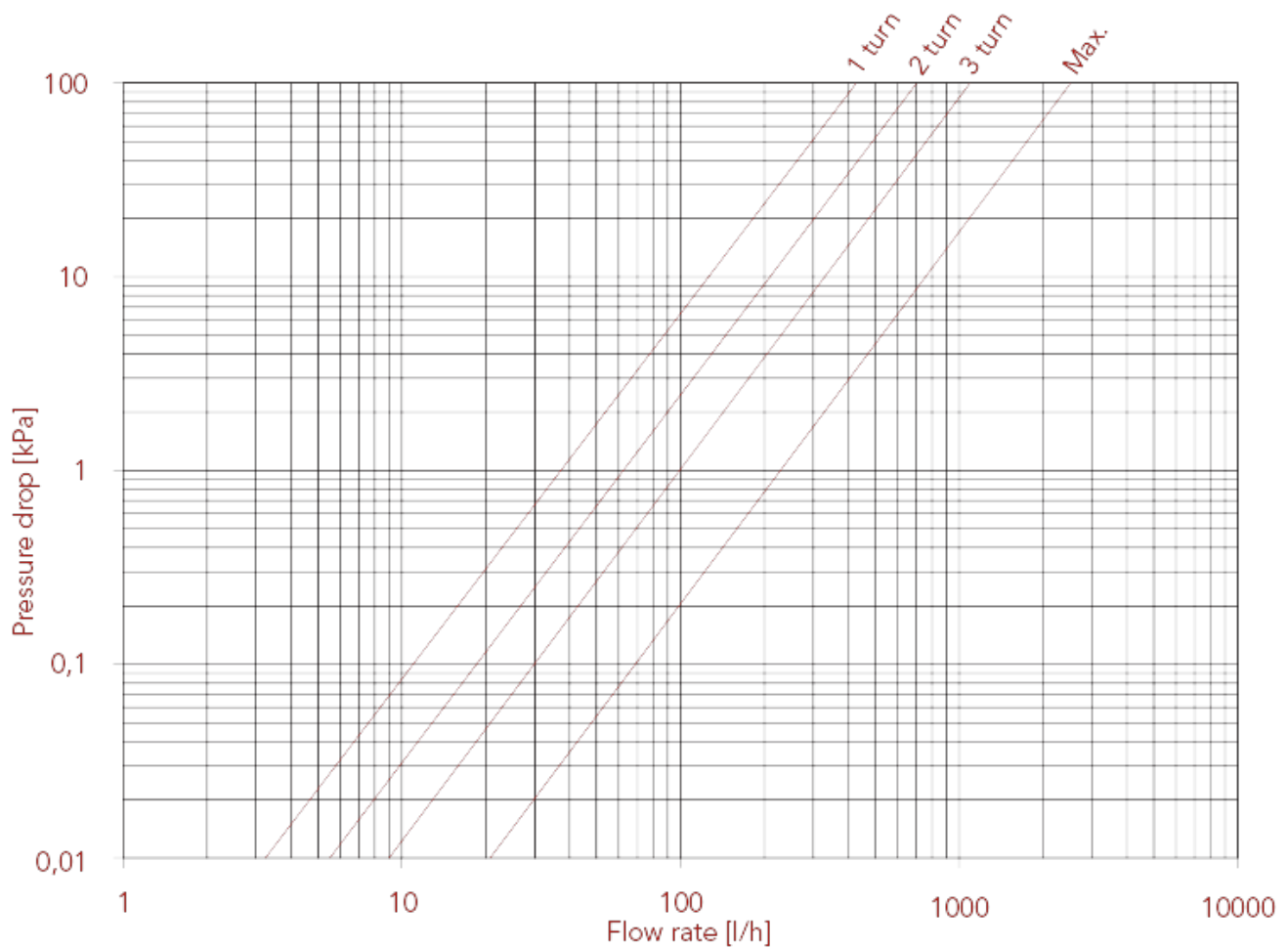



ITAP S.p.A.
Via Ruca 19
25065 Lumezzane
Brescia (ITALY)
Tel 030 8927011
Fax 030 8921990
www.itap.it - info@itap.it

We reserve the right to make improvements and changes to the products described herein and to the relative technical data, at any time and without forewarning.

rev. 20250402